

 SILVERSEA®

The background of the entire page is a scenic photograph of a coastal landscape. It features a white lighthouse with a red band on a grassy cliff overlooking the ocean. A small white building is situated nearby on the cliff. The foreground is filled with out-of-focus yellow wildflowers. The sky is a pale, hazy blue.

# A DEEPER VIEW OF WONDERS

NORTHERN EUROPE 2021-2023

*Let us take you closer  
to the authentic beauty  
of Northern Europe  
and the British Isles*





Steve McCurry

Cover picture: Howth, Ireland, 2018, by Steve McCurry



*“This is our home, a place where histories, cultures  
and languages come together, where you can feel the presence  
of yesterday and imagine a new tomorrow.”*

ROBERTO MARTINOLI - PRESIDENT AND CEO, SILVERSEA CRUISES





















SPONDENS HUS

HORN

GALIONEN

HYTTEFADET

SKIPPERKR

Svalan  
Nyhavn







---

*“Northern Europe holds a special place  
in my camera lens. Nowhere else in the world do you see  
such bright blues and deep greens, as cities become mountains  
and fields dip into lakes and oceans.”*

STEVE MCCURRY, PHOTOGRAPHER













---

*“I’m extremely proud of our innovative itineraries across Northern Europe and I know our travellers will enjoy all the new ports of call, large and small. Bon voyage!”*

BARBARA MUCKERMANN - CHIEF MARKETING OFFICER, SILVERSEA CRUISES











# THE MAGIC OF NORTHERN EUROPE

Welcome to Northern Europe, a melting pot of peoples, histories, architectural styles and cultures. A place where thriving modern capitals are surrounded by vast open landscapes that hold the key to centuries of legends and traditions. Thanks to our small, intimate ships, we'll take you to these close and faraway places for a deeper understanding of the magic behind it all.

From Goðafoss, the majestic "waterfall of the gods" in Iceland, to the imposing Cliffs of Moher in Ireland, you'll be in awe at how nature has lovingly sculpted this part of the world. Deep blue fjords contrast with black beaches of volcanic sand while gargantuan mountains hide pristine lakes and luxurious hot springs. In the extreme north, the lands of the midnight sun will make you see this old

continent in an entirely new way, as you sail along the same coastlines the Vikings did almost a thousand years ago. Visit the singular Hermitage museum on the banks of the Neva river winding its way through St. Petersburg or look up at the behemoth that is London's Big Ben before asking it to take a selfie with you. Once you've taken in all these must-sees you'll be ready to explore some of Northern Europe's lesser-known destinations, including smaller ports featured on our cruises for the very first time. These include Iceland's Sudureyri, a quaint fishing village nestled among green hills and awesome waterfalls, and Melfjord in Norway, right at the tip of one of the world's most breathtaking fjords.



The thirty-metre wide Goðafoss, or "waterfall of the gods", in Iceland





The Winter Palace, home to the Hermitage museum, St. Petersburg, Russia



The Cliffs Of Moher, County Clare, Ireland



Big Ben on a sunny day, London, UK





Viking boat, Norway, 2018, by Steve McCurry





# NORTHERN EUROPEAN ITINERARIES

From cosmopolitan cities to small quiet ports surrounded by nature,  
every region has its own unique character for you to explore and enjoy.



# THE BALTICS

## THE LANDS OF THE MIDNIGHT SUN

As you look out from the deck at the melting pot of colours, cultures and languages that is the Baltics, you'll marvel at the different worlds you'll encounter. Enjoy extra hours of daylight strolling through Stockholm or taking in the panorama at Helsinki's harbour. Then take a moment and enjoy a fabulous meal as curated by chefs from the Scandinavian culinary movement, featuring fresh, sustainable ingredients and savoury traditional dishes.



A summer view of the seaside in Helsinki, Finland



Duration **7** Days

*Silver Spirit*



## DAY BY DAY

DATE	PORT	ARRIVE	DEPART
29 Jun 2021	STOCKHOLM		18:00
30 Jun 2021	HELSINKI	12:00	18:00
01 Jul 2021	ST PETERSBURG	08:00	
02 Jul 2021	ST PETERSBURG		
03 Jul 2021	ST PETERSBURG		18:00
04 Jul 2021	TALLINN	09:00	22:00
05 Jul 2021	DAY AT SEA		
06 Jul 2021	COPENHAGEN	07:00	

**OTHER VOYAGE OPTIONS:**

## 2021

VOYAGE CODE	SHIP	DEPT. DATE	NO. OF DAYS
SL210622007	SILVER SPIRIT	22 Jun 2021	7
SL210716007	SILVER SPIRIT	16 Jul 2021	7
SL210723007	SILVER SPIRIT	23 Jul 2021	7
SL210809007	SILVER SPIRIT	9 Aug 2021	7
SL210816007	SILVER SPIRIT	16 Aug 2021	7

## 2022

VOYAGE CODE	SHIP	DEPT. DATE	NO. OF DAYS
MO220621007	SILVER MOON	21 Jun 2022	7
MO220628007	SILVER MOON	28 Jun 2022	7
MO220715007	SILVER MOON	15 Jul 2022	7
MO220722007	SILVER MOON	22 Jul 2022	7
MO220808007	SILVER MOON	8 Aug 2022	7
MO220815007	SILVER MOON	15 Aug 2022	7
MO220822007	SILVER MOON	22 Aug 2022	7



The streets of Stockholm, Sweden at dusk



# S.A.L.T. SEA AND LAND TASTE

*Enjoy all the flavours of Northern Europe and the British Isles*

## SAVOUR LOCAL CUISINE ON BOARD SILVER MOON

From Russian caviar to the smoke-houses dotting the Swedish countryside, there is much to recommend a culinary tour of Northern Europe. With the new S.A.L.T. (Sea and Land Taste) culinary programme, you will look well beyond typical tourist fare to understand the food and traditions of the region. Expertly-guided shore excursions uncover the history, stories and personalities behind the well-known dishes, as well as shine a light on lesser-known culinary treasures. Think of anything from an exploration of the world-class restaurant culture of Copenhagen to the preserving methods of Iceland, to foraging for flavours the New Nordic way. S.A.L.T. Kitchen is

our regionally-focused restaurant with an ever-changing menu that reflects where the ship is at any moment. S.A.L.T. Bar is the place to get to know the great wines and spirits of the region, from the aquavits of Scandinavia to the single-malts of Scotland. For those who want to go deeper with hands-on cooking experiences and culinary discussions, S.A.L.T. Lab is an interactive space where you'll join our talented chefs as well as visiting experts to learn how dishes are prepared and enjoyed locally. S.A.L.T. integrates food, culture and travel like never before, with amazing and immersive food and drink experiences. No two cruises are the same.



Seafood and caviar are one of the regional delicacies in Northern Europe

*"Food is that it's an amazing key  
to get under a culture, to understand  
the soul of a destination."*

BARBARA MUCKERMANN - CHIEF MARKETING OFFICER, SILVERSEA CRUISES



Scandinavian aquavit and schnapps tasting in S.A.L.T. Bar





Northern Europe's flavours and recipes is one of the highlights of the S.A.L.T program in the region



# NORWEGIAN FJORDS

## WHERE LAND AND SEA COME TOGETHER

Walls of green rise up around you as you glide through the waters of one of the narrowest fjords in Norway on your way to Flåm, home of one of the most beautiful scenic train rides in the world, a 20-km voyage through stunning hills and landscapes. In Oslo, you'll get up close and personal with the heritage of the Vikings all across the city while in Copenhagen you'll explore the old historic centre's colourful buildings and streets.



Cruising from Gudvangen to Flåm in one of the narrowest fjords in Norway



## COPENHAGEN TO COPENHAGEN

Duration **10 Days**

### *Silver Spirit*



#### DAY BY DAY

DATE	PORT	ARRIVE	DEPART
06 Jul 2021	COPENHAGEN		19:00
07 Jul 2021	DAY AT SEA		
08 Jul 2021	BERGEN	08:00	18:00
09 Jul 2021	FLÅM	07:00	18:00
10 Jul 2021	OLDEN	08:00	18:00
11 Jul 2021	GEIRANGER	08:00	13:30
11 Jul 2021	HELLESØYLT	15:30	17:00
12 Jul 2021	DAY AT SEA		
13 Jul 2021	ARENDAL	08:00	18:00
14 Jul 2021	OSLO	08:00	
15 Jul 2021	OSLO		13:00
16 Jul 2021	COPENHAGEN	07:00	



An alleyway in Copenhagen's historic centre, in Denmark

#### OTHER VOYAGE OPTIONS:

##### 2021

VOYAGE CODE	SHIP	DEPT. DATE	NO. OF DAYS	
E4210614012	SILVER CLOUD	14 Jun 2021	12	EXP
SL210610012	SILVER SPIRIT	10 Jun 2021	12	
E4210716013	SILVER CLOUD	16 Jul 2021	13	EXP
WH210726012	SILVER WHISPER	26 Jul 2021	12	
SL210730010	SILVER SPIRIT	30 Jul 2021	10	
WH210807014	SILVER WHISPER	7 Aug 2021	14	
SL210823011	SILVER SPIRIT	23 Aug 2021	11	

##### 2022

VOYAGE CODE	SHIP	DEPT. DATE	NO. OF DAYS
WI220601013	SILVER WIND	1 Jun 2022	13
MO220609012	SILVER MOON	9 Jun 2022	12
MO220705010	SILVER MOON	5 Jul 2022	10
WH220727014	SILVER WHISPER	27 Jul 2022	14
MO220729010	SILVER MOON	29 Jul 2022	10
WH220810014	SILVER WHISPER	10 Aug 2022	14
MO220829011	SILVER MOON	29 Aug 2022	11
MO220909013	SILVER MOON	9 Sep 2022	13



# ICELAND

## DISCOVER A WORLD APART

A place of colours and contrasts, Iceland welcomes you to a land of otherworldly landscapes. From the immense blue glaciers of Vatnajökull National Park to the geysers and hot springs scattered throughout the island, this is the closest you'll ever get to visiting another planet. Small hidden harbours offer up amazing nature and wildlife, including the extraordinary Puffin, one of the main symbols of this unique island nation.



A black sandy beach near Djupivogur on Iceland's east coast



## REYKJAVIK TO REYKJAVIK

Duration **10 Days**

### *Silver Whisper*



#### DAY BY DAY

DATE	PORT	ARRIVE	DEPART
21 Aug 2021	REYKJAVIK		21:30
22 Aug 2021	PATREKSEJÖRDUR	08:00	18:00
23 Aug 2021	SIGLUFJÖRDUR	08:00	23:00
24 Aug 2021	AKUREYRI	08:00	22:00
25 Aug 2021	HUSAVIK	07:00	12:00
26 Aug 2021	SEYDISJÖRDUR	8:00	23:00
27 Aug 2021	DAY AT SEA		
28 Aug 2021	TÓRSHAVN	08:00	13:00
29 Aug 2021	DJÚPIVOGUR	08:00	18:00
30 Aug 2021	HEIMAÆY - WESTMAN ISLANDS	08:00	18:00
31 Aug 2021	REYKJAVIK	07:00	

#### OTHER VOYAGE OPTIONS:

##### 2021

VOYAGE CODE	SHIP	DEPT. DATE	NO. OF DAYS
WH210704010	SILVER WHISPER	4 Jul 2021	10
WH210714012	SILVER WHISPER	14 Jul 2021	12
WI210822009	SILVER WIND	22 Aug 2021	9 <b>EXP</b>

##### 2021

VOYAGE CODE	SHIP	DEPT. DATE	NO. OF DAYS
MO220530010	SILVER MOON	30 May 2022	10
WH220624011	SILVER WHISPER	24 Jun 2022	11
WH220715012	SILVER WHISPER	15 Jul 2022	12
WH220705010	SILVER WHISPER	5 Jul 2022	10
WH220824010	SILVER WHISPER	24 Aug 2022	10



A puffin admires the seaside in Iceland



# THE ATLANTIC COAST

## EXPLORE THE HISTORY OF BEAUTY

There's nothing as glorious as the view of the old town of Porto on the Douro river in Portugal. Except perhaps the view of Mont Saint Michael Bay in Normandy at sunset. Or any of the awesome views of the many picturesque towns and landscapes that dot the northern coasts of France, Spain and Portugal. And, from the wines of Bordeaux to Lisbon's *pastéis de nata*, you'll always have something tasty to enjoy with the view.



A sunset view of Porto's old town on the Douro river in Portugal



## LISBON TO LONDON TOWER BRIDGE

Duration **12 Days**

*Silver Cloud*



### DAY BY DAY

DATE	PORT	ARRIVE	DEPART
05 May 2021	LISBON		18:00
06 May 2021	LEIXÕES (PORTO)	09:30	20:00
07 May 2021	VIGO	08:00	18:00
08 May 2021	LA CORUÑA	07:00	16:00
09 May 2021	BILBAO	12:00	23:00
10 May 2021	SAN SEBASTIAN	07:30	16:00
11 May 2021	BORDEAUX	08:30	
12 May 2021	BORDEAUX		19:00
13 May 2021	DAY AT SEA		
14 May 2021	SAINT MALO	09:30	19:30
15 May 2021	HONFLEUR	08:15	19:45
16 May 2021	LONDON (TOWER BRIDGE)	18:30	
17 May 2021	LONDON (TOWER BRIDGE)		



An aerial view of Mont Saint Michel Bay in Normandy, France

### OTHER VOYAGE OPTIONS:

#### 2021

VOYAGE CODE	SHIP	DEPT. DATE	NO. OF DAYS
SL210526015	SILVER SPIRIT	26 May 2021	15
SL210927011	SILVER SPIRIT	27 Sep 2021	11
WI210929013	SILVER WIND	29 Sep 2021	13

**EXP**

#### 2022

VOYAGE CODE	SHIP	DEPT. DATE	NO. OF DAYS
MO220506012	SILVER MOON	6 May 2022	12
E4220827011	SILVER CLOUD	27 Aug 2022	11
MO220922012	SILVER MOON	22 Sep 2022	12

**EXP**



# BRITISH ISLES

## LANDS OF THE PAST AND FUTURE

From bustling cities to the quiet cliffs of Ireland's Howth Head, we'll take you on a voyage from one millennium to the next, as traditional houses in Dublin contrast with skyscrapers shimmering in the twilight. You'll be right in the middle of it all with visits to remarkable ports located in the centre of town such as Greenwich or Tower Bridge in London and those in more remote destinations such as St. Kilda at the northern tip of the UK.



A path winds through the cliffs of Ireland's Howth Head



## LONDON TOWER BRIDGE TO LONDON TOWER BRIDGE

Duration **14** Days

### *Silver Cloud*



#### DAY BY DAY

DATE	PORT	ARRIVE	DEPART
31 May 2021	LONDON (TOWER BRIDGE)		
01 Jun 2021	LONDON (TOWER BRIDGE)		06:00
02 Jun 2021	ST PETER PORT	08:00	17:00
03 Jun 2021	ST MARY'S	07:00	12:00
03 Jun 2021	TRESCO	13:00	18:00
04 Jun 2021	MILFORD HAVEN	06:00	12:30
04 Jun 2021	SKOMER ISLAND	15:30	19:00
05 Jun 2021	DAY AT SEA		
06 Jun 2021	FORT WILLIAM	05:00	17:00
07 Jun 2021	ST. KILDA	08:00	14:00
08 Jun 2021	LUNGA	05:00	10:30
08 Jun 2021	IONA	14:00	18:00
09 Jun 2021	DUBLIN	11:00	22:00
10 Jun 2021	DOUGLAS	08:00	16:30
11 Jun 2021	WATERFORD	07:15	14:45
12 Jun 2021	DARTMOUTH	10:30	17:30
13 Jun 2021	LONDON (TOWER BRIDGE)	17:30	
14 Jun 2021	LONDON (TOWER BRIDGE)		



Quaint houses in a City Council park in Dublin, Ireland

#### OTHER VOYAGE OPTIONS:

##### 2021

VOYAGE CODE	SHIP	DEPT. DATE	NO. OF DAYS	
E4210517014	SILVER CLOUD	17 May 2021	14	EXP
W1210614014	SILVER WIND	14 Jun 2021	14	EXP
WH210620014	SILVER WHISPER	20 Jun 2021	14	
SL210903012	SILVER SPIRIT	3 Sep 2021	12	
W1210915014	SILVER WIND	15 Sep 2021	14	EXP
SL210915012	SILVER SPIRIT	15 Sep 2021	12	

##### 2022

VOYAGE CODE	SHIP	DEPT. DATE	NO. OF DAYS	
WH220429012	SILVER WHISPER	29 Apr 2022	12	
MO220518012	SILVER MOON	18 May 2022	12	
WH220601014	SILVER WHISPER	1 Jun 2022	14	
E4220611017	SILVER CLOUD	11 Jun 2022	17	EXP
WH220615009	SILVER WHISPER	15 Jun 2022	9	
E4220815012	SILVER CLOUD	15 Aug 2022	12	EXP



# YOUR EXPEDITION

*Experienced in delivering experiences*

## ACROSS EUROPE, THE EXPERTS MAKE THE EXPEDITION

We've assembled a top-notch team of experts to help you discover and explore Europe's hidden secrets. Silversea Expeditions has one of the highest expedition-personnel-to-guest ratios in the entire expedition cruising industry, meaning every voyage features from 21 to 28 qualified specialists ready to make your adventure that much more special. All excursions and experiences with our Expedition Leaders are included in your cruise fare, so feel free to attend as many of our daily recaps, briefings and lectures as you like. These uniquely talented experts have all been chosen for their passion and dedication to their field, as well as their openness, friendliness, and infectious enthusiasm. Our team features historians, biologists, geologists, photographers and more. They'll make sure every adventure you go on is entirely thought out so that your experience is always something to write home about. Whether you're looking for that perfect exposure setting for that money shot or would like a detailed history of the local area, you'll always find someone to answer your questions and lend a hand. Get to know our professional Expedition team members for the full story on your destination.

## NORTHERN EUROPE EXPEDITION VOYAGES

VOYAGE CODE	SHIP	DEPT. DATE	NO. OF DAYS	
<b>ICELAND</b>				
WI210822009	SILVER WIND	22 Aug 2021	9	EXP
<b>THE ATLANTIC COAST</b>				
E4210505012	SILVER CLOUD	5 May 2021	12	EXP
E4220827011	SILVER CLOUD	27 Aug 2022	11	EXP
WI210929013	SILVER WIND	29 Sep 2021	13	EXP
<b>BRITISH ISLES</b>				
E4210517014	SILVER CLOUD	17 May 2021	14	EXP
E4210531014	SILVER CLOUD	31 May 2021	14	EXP
E4220611017	SILVER CLOUD	11 Jun 2022	17	EXP
WI210614014	SILVER WIND	14 Jun 2021	14	EXP
E4220815012	SILVER CLOUD	15 Aug 2022	14	EXP
WI210915014	SILVER WIND	15 Sep 2021	14	EXP
<b>NORWEGIAN FIORDS</b>				
E4210614012	SILVER CLOUD	14 Jun 2021	12	EXP
MO220609012	SILVER MOON	9 Jun 2022	12	EXP
WH220810014	SILVER WHISPER	10 Aug 2022	14	EXP



Guests on an excursion at the Goðafoss Waterfalls, Iceland



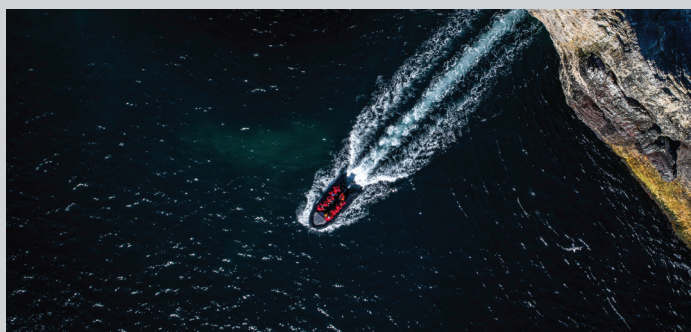

Going out for an excursion on a Zodiac®

## ZODIAC® CRUISING

There's nothing like setting out to explore a remote inlet or drifting alongside large blocks of clear-blue ice next to a glacier on the edge of your seat on a Zodiac®. Enjoy an experience like no other as our Expedition Team members get you in the middle of the action. All you have to do is climb onboard.



The Namaskard hot springs and steam vents in Husavik, Iceland

## GROUP HIKES

Get up close and personal with Europe's stunning terrains, beautiful architecture and teeming wildlife. Keep a lookout for unique flora and fauna as you hike and, who knows, you might just make a new feathered friend or two as you make your way up, over and through some of the most famous landscapes in the world.



Guests kayaking offshore

## ACTIVE KAYAKING

Towering waterfalls and green hills look great from afar, but there's nothing like getting underneath, in and around these distinctive features of the old continent as you take in the tranquil silence of a kayak ride where it's just you and nature. Under the guidance of our certified instructors you'll be able to experience all this and so much more.



An Expedition Team lecture in our Explorer Lounge

## ADVANCED LECTURES

Prepare for your onshore excursions with the best of the best as our expert naturalists, biologists, historians and geologists provide you with inside information on what to expect onshore and in the water. They'll pique your curiosity with captivating details about the land, water, sea and wildlife of this unusual continent.

*\*ALL ABOVE EXPEDITION EXPERIENCES ARE INCLUDED IN YOUR CRUISE FARE, SIMPLY SET OUT AND ENJOY.*





18th century buildings across the Neva river, Saint Petersburg





# Grand NORTHERN EUROPE 2022

 *Silver Moon*

*53 Days  
40 Ports  
13 Countries*

**6 MAY 2022  
to 28 JUNE 2022**

**LISBON  
to STOCKHOLM**

From the sunny shores of Lisbon to the bright glaciers of Iceland, our very first Northern Europe Grand Voyage will take you on a path of personal discovery. Otherworldly destinations such as Akureyri, Torshavn, Oban and Patreksfjörður fuse with the lush forests of Norway, all the way up to the Arctic Circle. With faraway places mixed with iconic cities such as Bordeaux, Oslo and St Petersburg, this is a journey of exploration, reflection and awe-inspiring contrasts.

## GRAND VOYAGE BENEFITS

- Included air\*
- Included shore excursions
- \$1,000 onboard spending credit (per guest)
- Exclusive shoreside events
- Pre-arrangement: 1 night pre
- Transfers
- Luggage handling
- Laundry service
- Visa service\*\*
- Unlimited Wi-Fi
- Medical service
- For a limited time only, enjoy 10% Early Booking Bonus



Summer panorama of the Old Town pier of Bryggen, Norway

\* BUSINESS CLASS UPGRADES AVAILABLE IN SELECTED DESTINATIONS. AIR NOT AVAILABLE IN SOME COUNTRIES IN EUROPE, ASIA AND LATIN AMERICA. IN THESE MARKETS, WE OFFER AN AIR CREDIT, INSTEAD, TO BE APPLIED TO THE BOOKING

\*\* FOR USA, CANADA, UK, GERMANY, AUSTRALIA ONLY



# OUR FLEET

You'll know you're on a Silversea ship the moment you step onboard. Our small, intimate ultra-luxury cruise ships offer up an entirely different sort of experience, with a warm atmosphere that makes you feel at home and the refinement and class you're used to. Always all-inclusive, our ships lead the way in comfort, innovation and elegance, with large wide-open spaces that create a pleasing environment wherever you find yourself onboard.

Our ships are also designed to reach the most faraway destinations and the smallest ports, places other cruise ships simply can't access. Ranging in size from 120 to 304 suites, you'll be spoilt for your choice of accommodation in both size and character, and each one features an ocean view, many with private teak veranda. All suites have sophisticated furnishings and everything you need for a marvellous stay. And with a staff-to-guest ratio of nearly one-to-one and a butler to each and every suite, our legendary service is but a hand-wave away.

For those yearning to explore something new, Silversea's purpose-built Expeditions ships Silver Cloud and Silver Wind can transport you to some of the most remote areas of the Northern Europe, getting you closer to its cities and landscapes than ever before. Sail into narrow waterways right into the heart of a busy modern metropolis or dock at a small pier while others are only able to anchor off shore. The possibilities to explore are endless.

You'll find we have a passion for perfection in everything we do and a highly-personalised approach to service. Enjoy exquisite cuisine, spacious lounges and intimate bars, where conversation flows freely and nobody has to reach for the tab, as well as wellness areas simply for relaxing. With journeys that are infinitely customisable, Silversea luxury cruises are the gold standard by which all others are judged.



## SILVER SPIRIT

411 Crew  
608 Guests  
39,519 tons  
Refurbished 2018



## SILVER MOON

411 Crew  
596 Guests  
40,700 tons  
Launching 2020



## SILVER WHISPER

302 Crew  
388 Guests  
28,258 tons  
Refurbished 2018



## SILVER WIND

239 Crew  
274 Guests  
17,400 tons  
Converted ice-class 2021



## SILVER CLOUD

212 Crew  
240 Guests in Polar waters  
17,400 tons  
Refurbished 2017





Silver Wind



Silver Cloud



# ALWAYS FIRST CLASS



We're committed to making your time with us in Europe unforgettable. Enjoy all the beauty, history and culture of the old continent while traveling in absolute comfort and elegance. Our legendary service will make your experience extraordinary.

## **SMALL-SHIP INTIMACY**

Big on creature comforts and luxuries, our small, intimate all-suite ships welcome you onboard with their warm and friendly atmosphere. Featuring a very limited number of guests, they'll immediately feel familiar as you set sail in elegance and style.

## **SUPERIOR SERVICE**

With nearly a member of staff for every guest, our personalised service is unparalleled. You'll be catered to and pampered every day as our staff learns to anticipate your needs. Every suite features a butler, so after a day out on the continent you might find a steaming hot cup of your favourite tea waiting for

you in your suite or a warm bath set up for you to soak in. All our team members take pride in making your time with us the absolute best it can possibly be.

## **GOURMET EXCELLENCE**

Our fine cuisine has always been a jewel in our crown. You'll have your choice of up to eight different luxuriously-appointed restaurants where world-renowned chefs create dishes using only the highest quality ingredients. And on Silver Moon you'll be able to get even closer to the flavours and traditions of your destination directly onboard with our unique S.A.L.T. culinary experience.

## **SILVERSEA'S 900+ DESTINATIONS**

From the Arctic to Antarctica, we strive to create the best, most unique itineraries in the world. We visit every single continent with a huge range of destinations – from extreme polar regions to the tropical equator, from iconic world cities to remote islands. Discover what makes each one special.









Silver Cloud, Grand Suite





DECK PLANS



# SILVER SPIRIT

## SHIP SPECIFICATIONS

Crew	411
Officers	European
Guests	608
Tonnage	39,519
Length	691 Feet/210.7 Mt
Width	87 Feet/26.5 Mt
Speed	19.5 Knots
Refurbished	2018

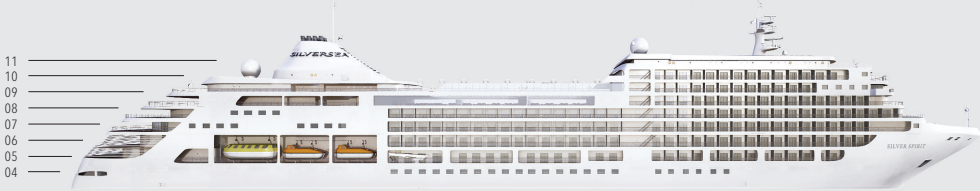

## DECK 11

- Tor's Observation
- Library

## DECK 10

- Jogging Track
- Spaccanapoli

## DECK 09

- Pool Deck
- Pool Bar
- The Grill
- Card Room
- Panorama Lounge

## DECK 08

- Connoisseur's Corner
- Boutique
- Arts Café
- Silver Note

## DECK 07

- La Terrazza
- Casino

## DECK 06

- Zagara Beauty Spa
- Fitness Centre

## DECK 05

- Reception/Guest Relations
- Shore Concierge
- Dolce Vita
- Venetian Lounge
- Conference Room
- Future Cruise Manager

## DECK 04

- Indochine
- Atlantide
- Seishin
- La Dame

## SUITE CATEGORIES

- Owner's Suite
- Grand Suite
- Royal Suite
- Silver Suite
- Deluxe Veranda Suite
- Superior Veranda Suite
- Classic Veranda Suite
- Panorama Suite
- Vista Suite

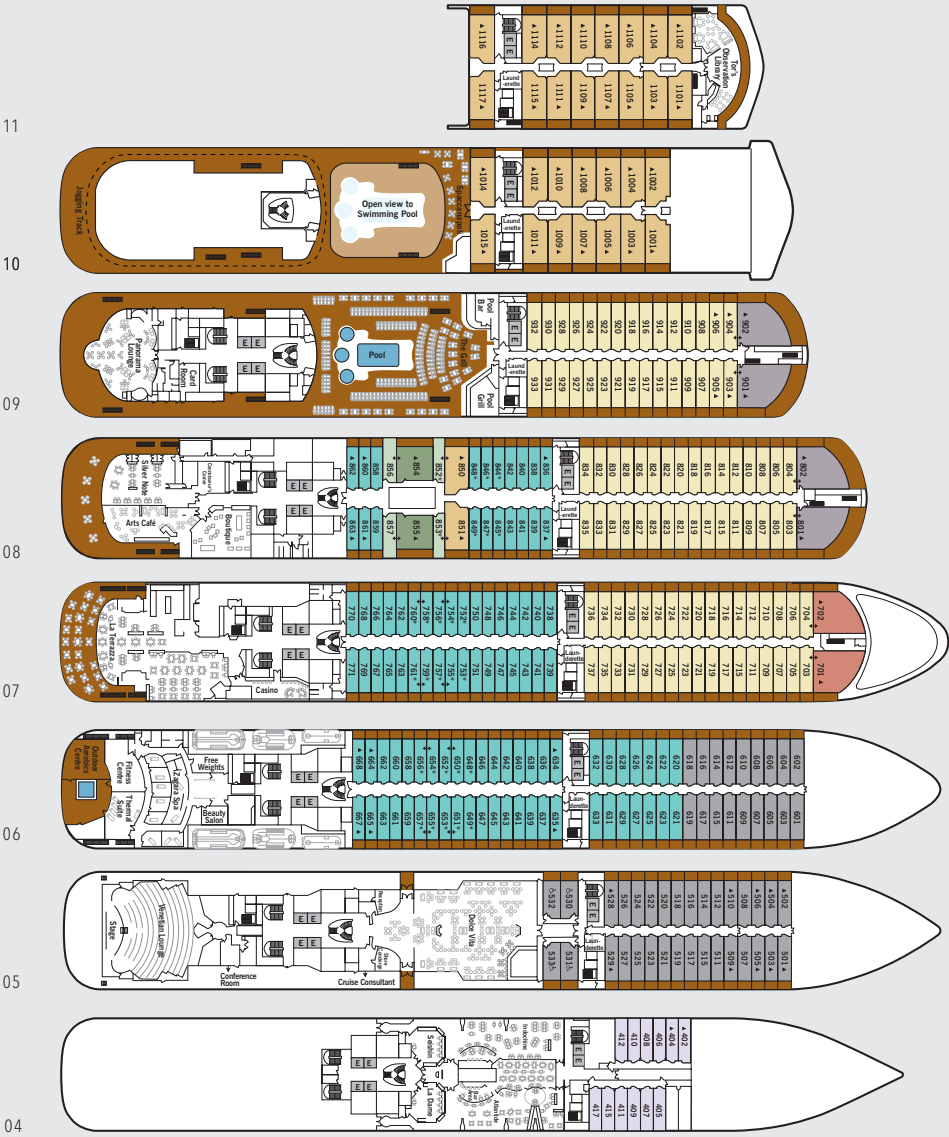

Deck plans are for illustration purposes only and may be subject to change.



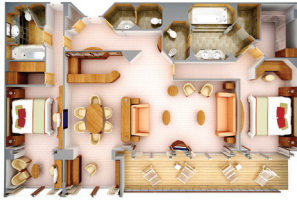

## OWNER'S SUITE

Available as a one-bedroom configuration or as a two-bedroom by adjoining with a Panorama suite (as illustrated)

**1 BEDROOM:** 915 SQ. FT. / 85 M<sup>2</sup>  
INCLUDING VERANDA (129 SQ. FT. / 12 M<sup>2</sup>)  
**2 BEDROOM:** 1,227 SQ. FT. / 114 M<sup>2</sup>  
INCLUDING VERANDA (129 SQ. FT. / 12 M<sup>2</sup>)

- Large veranda with patio furniture and floor-to-ceiling glass doors; bedroom two has additional large picture window
- Living room with sitting area; bedroom two has additional sitting area
- Separate dining area
- Twin beds or king-sized bed; bedroom two has additional twin beds or queen-sized bed
- Marble bathroom with double vanity, separate shower and full-sized bath, plus a powder room; bedroom two has additional marble bathroom with full-sized bath, separate shower
- Savoir® Beds mattresses
- Walk-in wardrobe(s) with personal safe
- Vanity table(s)
- Writing desk(s)
- One 55" / 140 cm and one 40" / 102 cm flat-screen HD TVs in main suite, plus one 40" / 102 cm flat-screen HD TV in bedroom two
- Bose® Sound System with Bluetooth connectivity
- Illy® espresso machine
- Unlimited Premium Wifi



## GRAND SUITE

Available as a one-bedroom configuration or as a two-bedroom by adjoining with a Veranda Suite.

**1 BEDROOM:** 1,425-1,532 SQ. FT. / 132-142 M<sup>2</sup>  
INCLUDING VERANDA (560-667 SQ. FT. / 52-62 M<sup>2</sup>);  
**2 BEDROOM:** 1,772-1,879 SQ. FT. / 165-174 M<sup>2</sup>  
INCLUDING VERANDA (595-702 SQ. FT. / 55-65 M<sup>2</sup>)

- Two verandas with patio furniture and floor-to-ceiling glass doors; bedroom two has additional veranda
- Living room with convertible sofa to accommodate an additional guest
- Sitting area; bedroom two has additional sitting area
- Separate dining area
- Twin beds or king-sized bed; bedroom two has additional twin beds or queen-sized bed
- Marble bathroom with double vanity, separate shower and full-sized bath, plus a powder room; bedroom two has additional marble bathroom with full-sized bath, separate shower
- Savoir® Beds mattresses
- Walk-in wardrobe(s) with personal safe
- Vanity table(s)
- Writing desk(s)
- One 55" / 140 cm and one 40" / 102 cm flat-screen HD TVs in main suite, plus one 40" / 102 cm flat-screen HD TV in bedroom two
- Bose® Sound System with Bluetooth connectivity
- Illy® espresso machine
- Unlimited Premium Wifi



## ROYAL SUITE

Available as a one-bedroom configuration or as a two-bedroom by adjoining with a Veranda suite (as illustrated)

**1 BEDROOM:** 990 SQ. FT. / 92 M<sup>2</sup>  
INCLUDING VERANDA (129 SQ. FT. / 12 M<sup>2</sup>);  
**2 BEDROOM:** 1,366 SQ. FT. / 127 M<sup>2</sup>  
INCLUDING VERANDA (194 SQ. FT. / 18 M<sup>2</sup>)

- Large veranda with patio furniture and floor-to-ceiling glass doors; bedroom two has additional veranda
- Living room with convertible sofa to accommodate an additional guest
- Sitting area; bedroom two has additional sitting area
- Separate dining area
- Twin beds or king-sized bed; bedroom two has additional twin beds or queen-sized bed
- Marble bathroom with double vanity, separate shower and full-sized bath, plus a powder room; bedroom two has additional marble bathroom with full-sized bath, separate shower
- Savoir® Beds mattresses
- Walk-in wardrobe(s) with personal safe
- Vanity table(s)
- Writing desk(s)
- One 55" / 140 cm and one 40" / 102 cm flat-screen HD TVs in main suite, plus one 40" / 102 cm flat-screen HD TV in bedroom two
- Bose® Sound System with Bluetooth connectivity
- Illy® espresso machine
- Unlimited Premium Wifi



## SILVER SUITE

Available as a one-bedroom configuration or as a two-bedroom by adjoining with a Panorama suite.

**1 BEDROOM:** 746 SQ FT / 69 M<sup>2</sup>  
INCLUDING VERANDA (129 SQ FT / 12 M<sup>2</sup>);  
**2 BEDROOM:** 1080 SQ FT/ 100 M<sup>2</sup>,  
INCLUDING VERANDA (129 SQ FT/12 M<sup>2</sup>)

- Veranda with patio furniture and floor-to-ceiling glass doors
- Living room with convertible sofa to accommodate an additional guest
- Sitting area
- Separate dining area
- Twin beds or king-sized bed
- Marble bathroom with double vanity, full-sized bath, separate shower; bedroom two has additional marble bathroom with walk-in rain shower
- Walk-in wardrobe with personal safe
- Vanity table
- Writing desk
- One 49" / 125 cm and one 40" / 102 cm flat-screen HD TVs in main suite
- Bose® Sound System with Bluetooth connectivity
- Illy® espresso machine
- Unlimited Premium Wifi



## DELUXE VERANDA SUITE SUPERIOR VERANDA SUITE CLASSIC VERANDA SUITE

Some Veranda Suites accommodate three guests. Deluxe Verandas offer preferred central location with identical accommodations to Classic and Superior Verandas.

376 SQ FT / 35 M<sup>2</sup>  
INCLUDING VERANDA (64 SQ FT / 6 M<sup>2</sup>)

- Veranda with patio furniture and floor-to-ceiling glass doors
- Sitting area
- Twin beds or queen-sized bed
- Marble bathroom with vanity, full-sized bath, separate shower
- Walk-in rain shower (no full-sized bath) from suite number 648 to 657, from 752 to 761 and from 844 to 849
- Walk-in wardrobe with personal safe
- Writing desk
- One 40" / 102 cm flat-screen HD TV
- Unlimited Standard Wifi



## PANORAMA SUITE

Available as a one-bedroom configuration.

334 SQ FT / 31 M<sup>2</sup>

- Sitting area
- Twin beds or queen-sized bed
- Marble bathroom with vanity, full-sized bath, separate shower
- Walk-in rain shower (no full-sized bath) from suite number 852 to 853\*
- Walk-in wardrobe with personal safe
- Writing desk
- One 40" / 102 cm flat-screen HD TV
- Unlimited Standard Wifi



## VISTA SUITE

312 SQ FT / 29 M<sup>2</sup>

- Sitting area
- Twin beds or queen-sized bed
- Marble bathroom with vanity, full-sized bath, separate shower
- Walk-in wardrobe with personal safe
- Writing desk
- One 40" / 102 cm flat-screen HD TV
- Unlimited Standard Wifi

## AMENITIES & FEATURES FOR ALL SUITES

- Butler service
- Refrigerator and bar setup stocked with your preferences
- Plush bathrobes
- Pillow menu
- Luxury bath amenities
- Complimentary Wifi for all suites
- Personalised stationery
- Umbrella
- Hair dryer
- Wall mounted USB-C mobile device chargers
- Direct-dial telephone(s)
- Interactive Media Library
- Champagne on arrival



# SILVER MOON

## SHIP SPECIFICATIONS

Crew	411
Officers	European
Guests	596
Tonnage	40,700
Length	698 Feet/212.8 Mt
Width	86 Feet/27 Mt
Speed	19.8 Knots
Launched	2020



### DECK 11

- Observation Library
- Spaccanapoli
- Jogging Track
- Card Room

### DECK 10

- Pool Deck
- Pool Bar
- The Grill
- Whirlpool Area

### DECK 09

- Panorama Lounge
- Connoisseur's Corner

### DECK 08

- Arts Café
- Boutique
- La Dame

### DECK 07

- La Terrazza
- Silver Note
- Casino

### DECK 06

- Zagara Beauty Spa
- Fitness Centre

### DECK 05

- Reception/Guest Relations
- Shore Concierge
- Dolce Vita
- Venetian Lounge
- Future Cruise Manager

### DECK 04

- Atlantide
- Kaiseki
- .S.A.L.T. Kitchen
- .S.A.L.T. Bar
- .S.A.L.T. Lab

## SUITE CATEGORIES

- Owner's Suite
- Grand Suite
- Royal Suite
- Silver Suite
- Deluxe Veranda Suite
- Superior Veranda Suite
- Classic Veranda Suite
- Panorama Suite
- Vista Suite

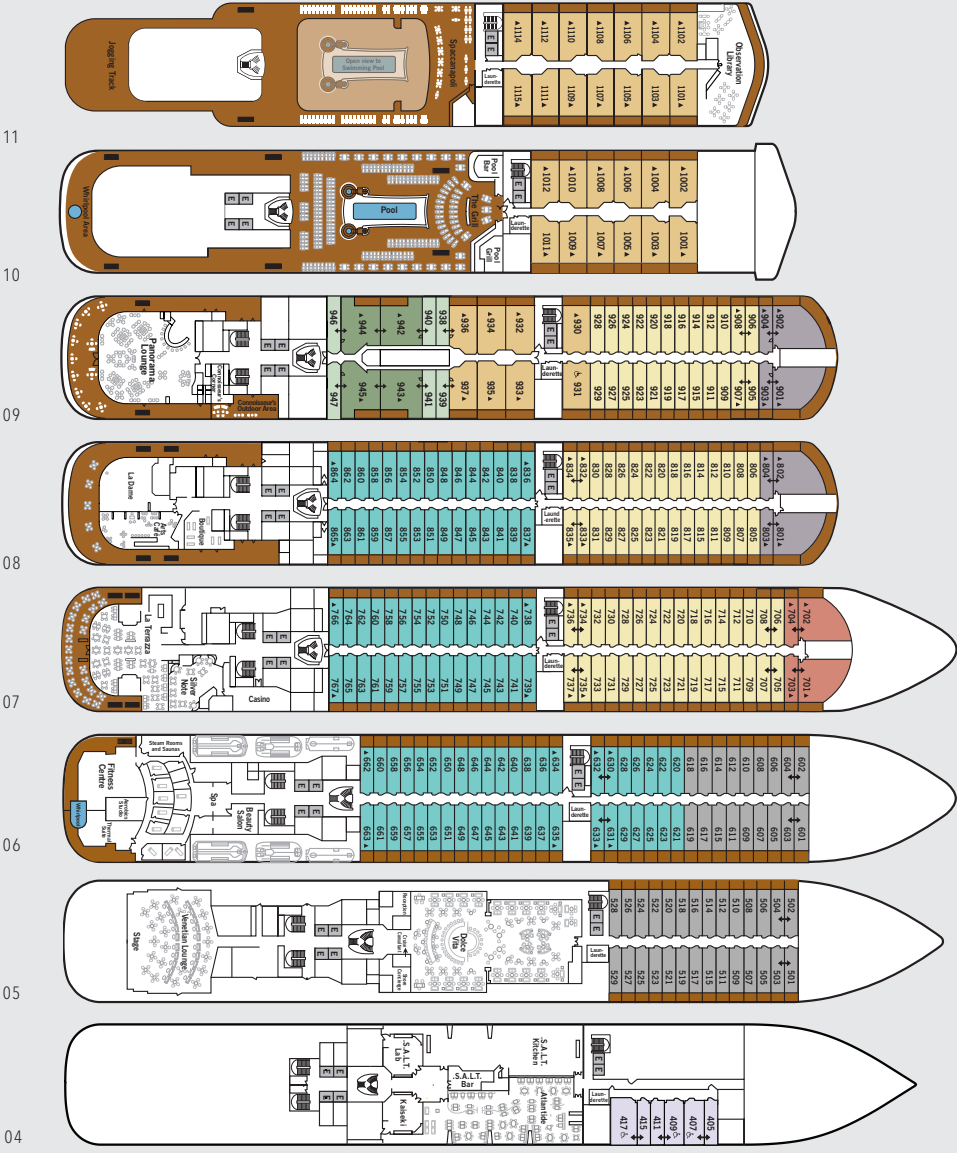

Deck plans are for illustration purposes only and may be subject to change.





## OWNER'S SUITE

Available as a one-bedroom configuration or as a two-bedroom by adjoining with a Panorama suite (as illustrated)

**1 BEDROOM:** 947-1055 SQ FT / 88-98 M<sup>2</sup>  
INCLUDING VERANDA (129 SQ FT / 12 M<sup>2</sup>)  
**2 BEDROOM:** 1281-1389 SQ FT / 119-129 M<sup>2</sup>  
INCLUDING VERANDA (129 SQ FT / 12 M<sup>2</sup>)

- Large veranda with patio furniture and floor-to-ceiling glass doors; bedroom two has additional large picture window
- Living room with sitting area; bedroom two has additional sitting area
- Separate dining area
- Twin beds or king-sized bed; bedroom two has additional twin beds or queen-sized bed
- Marble bathroom with double vanity, separate shower and full-sized bath, plus a powder room; bedroom two has additional marble bathroom with shower
- Custom-made luxury bed mattresses
- Walk-in wardrobe(s) with personal safe
- Vanity table(s)
- Writing desk(s)
- One 55" / 140 cm and one 40" / 102 cm flat-screen HD TVs in main suite, plus one 40" / 102 cm flat-screen HD TV in bedroom two
- Interactive Media Library
- Bose® Sound system with bluetooth connectivity
- Illy® espresso machine
- Unlimited Premium Wifi



## GRAND SUITE

Available as a one-bedroom configuration or as a two-bedroom by adjoining with a Veranda Suite (as illustrated).

**DECK 8: 1 BEDROOM:** 1572 SQ FT / 146 M<sup>2</sup>  
INCLUDING VERANDA: (570 SQ FT / 53 M<sup>2</sup>)  
**2 BEDROOM:** 1970 SQ FT / 183 M<sup>2</sup>  
INCLUDING VERANDA: (635 SQ FT / 59 M<sup>2</sup>)  
**DECK 9: 1 BEDROOM:** 1472 SQ FT / 137 M<sup>2</sup>  
INCLUDING VERANDA: (474 SQ FT / 44 M<sup>2</sup>)  
**2 BEDROOM:** 1873 SQ FT / 174 M<sup>2</sup>  
INCLUDING VERANDA: (538 SQ FT / 50 M<sup>2</sup>)

- Two verandas with patio furniture and floor-to-ceiling glass doors; bedroom two has additional veranda
- Living room with convertible sofa to accommodate an additional guest
- Sitting area; bedroom two has additional sitting area
- Separate dining area
- Twin beds or king-sized bed; bedroom two has additional twin beds or queen-sized bed
- Marble bathroom with double vanity, separate shower and full-sized bath, plus a powder room; bedroom two has additional marble bathroom with full-sized bath
- Custom-made luxury bed mattresses
- Walk-in wardrobe(s) with personal safe
- Vanity table(s)
- Writing desk(s)
- One 55" / 140 cm and one 40" / 102 cm flat-screen HD TVs in main suite, plus one 40" / 102 cm flat-screen HD TV in bedroom two
- Interactive Media Library
- Bose® Sound system with bluetooth connectivity
- Illy® espresso machine
- Unlimited Premium Wifi



## ROYAL SUITE

Available as a one-bedroom configuration or as a two-bedroom by adjoining with a Veranda suite (as illustrated)

**1 BEDROOM:** 1130 SQ FT / 105 M<sup>2</sup>  
INCLUDING VERANDA (129 SQ FT / 12 M<sup>2</sup>)  
**2 BEDROOM:** 1528 SQ FT / 142 M<sup>2</sup>  
INCLUDING VERANDA (194 SQ FT / 18 M<sup>2</sup>)

- Large veranda with patio furniture and floor-to-ceiling glass doors; bedroom two has additional veranda
- Living room with convertible sofa to accommodate an additional guest
- Sitting area; bedroom two has additional sitting area
- Separate dining area
- Twin beds or king-sized bed; bedroom two has additional twin beds or queen-sized bed
- Marble bathroom with double vanity, separate shower and full-sized bath, plus a powder room; bedroom two has additional marble bathroom with full-sized bath
- Custom-made luxury bed mattresses
- Walk-in wardrobe(s) with personal safe
- Vanity table(s)
- Writing desk(s)
- One 55" / 140 cm and one 40" / 102 cm flat-screen HD TVs in main suite, plus one 40" / 102 cm flat-screen HD TV in bedroom two
- Interactive Media Library
- Bose® Sound system with bluetooth connectivity
- Illy® espresso machine
- Unlimited Premium Wifi



## SILVER SUITE

Available as a one-bedroom configuration or as a two-bedroom by adjoining with a Panorama suite. One suite available as a wheelchair accessible suite.

**1 BEDROOM:** 786 SQ FT / 73 M<sup>2</sup>  
INCLUDING VERANDA (129 SQ FT / 12 M<sup>2</sup>)  
**2 BEDROOM:** 1119 SQ FT / 104 M<sup>2</sup>  
INCLUDING VERANDA (129 SQ FT / 12 M<sup>2</sup>)

- Veranda with patio furniture and floor-to-ceiling glass doors
- Living room with convertible sofa to accommodate an additional guest
- Sitting area
- Separate dining area
- Twin beds or king-sized bed
- Marble bathroom with double vanity, full-sized bath, separate shower; bedroom two has additional marble bathroom with full-sized bath
- Wheelchair accessible suite has a marble bathroom with vanity and separate shower (no full-sized bath as illustrated)
- Walk-in wardrobe with personal safe
- Vanity table
- Writing desk
- One 55" / 140 cm and one 40" / 102 cm flat-screen HD TVs in main suite; plus one 40" / 102 cm flat-screen HD TV in bedroom two
- Interactive Media Library
- Bose® Sound system with bluetooth connectivity
- Illy® espresso machine
- Unlimited Premium Wifi



## DELUXE VERANDA SUITE SUPERIOR VERANDA SUITE CLASSIC VERANDA SUITE

Some Veranda Suites accommodate three guests. Deluxe Verandas offer preferred central location with identical accommodations to Classic and Superior Verandas.

387 SQ FT / 36 M<sup>2</sup>  
INCLUDING VERANDA (64 SQ FT / 6 M<sup>2</sup>)

- Veranda with patio furniture and floor-to-ceiling glass doors
- Sitting area
- Twin beds or queen-sized bed
- Marble bathroom with vanity, full-sized bath, separate shower
- Walk-in wardrobe with personal safe
- Writing desk
- One 40" / 102 cm flat-screen HD TV
- Interactive Media Library
- Unlimited Standard Wifi



## PANORAMA SUITE

Available as a one-bedroom configuration.

**DECK 9:** 334 SQ FT / 31 M<sup>2</sup>

- Sitting area
- Twin beds or queen-sized bed
- Marble bathroom with vanity, full-sized bath, separate shower
- Walk-in wardrobe with personal safe
- Writing desk
- One 40" / 102 cm flat-screen HD TV
- Interactive Media Library
- Unlimited Standard Wifi



## VISTA SUITE

Some Vista Suites are available as a wheelchair accessible suite.\*

**DECK 4:** 334 SQ FT / 31 M<sup>2</sup>  
**WHEELCHAIR ACCESSIBLE SUITE:** 440-646 SQ FT / 41-60 M<sup>2</sup>

- Sitting area
- Twin beds or queen-sized bed
- Marble bathroom with vanity, full-sized bath, separate shower
- Wheelchair accessible suite has a marble bathroom with vanity and separate shower (no full-sized bath)
- Walk-in wardrobe with personal safe; wheelchair accessible suites fitted with cupboards and wardrobe with personal safe
- Writing desk
- One 40" / 102 cm flat-screen HD TV
- Interactive Media Library
- Unlimited Standard Wifi

\*Wheelchair accessible suite does not include full-sized bath

## AMENITIES & FEATURES FOR ALL SUITES

- Butler service
- Refrigerator and bar setup stocked with your preferences
- Plush bathrobes
- Pillow menu
- Luxury bath amenities
- Complimentary Wifi for all suites
- Personalised stationery
- Umbrella
- Hair dryer
- Wall mounted USB-C mobile device chargers
- Direct-dial telephone(s)
- Champagne on arrival



# SILVER WHISPER

Effective from June 6, 2021

## SHIP SPECIFICATIONS

Crew	302
Officers	European
Guests	388
Tonnage	28,258
Length	610 Feet/186 Mt
Width	81.8 Feet/24.9 Mt
Speed	18.5 Knots
Refurbished	2018



## DECK 10

- Fitness Centre
- Zagara Beauty Spa
- Observation Lounge

## DECK 09

- Jogging Track

## DECK 08

- Pool Deck
- Pool Bar
- The Grill
- Library
- Internet Corner
- Panorama Lounge

## DECK 07

- La Terrazza
- La Dame
- Connoisseur's Corner
- Conference/Card Room

## DECK 06

- The Show Lounge

## DECK 05

- Casino
- Casino Bar
- The Bar
- Boutique
- Reception/Guest Relations
- Shore Concierge
- Future Cruise Manager
- The Show Lounge

## DECK 04

- The Restaurant

## SUITE CATEGORIES

- Owner's Suite
- Grand Suite
- Royal Suite
- Silver Suite
- Medallion Suite
- Deluxe Veranda Suite
- Superior Veranda Suite
- Classic Veranda Suite
- Vista Suite

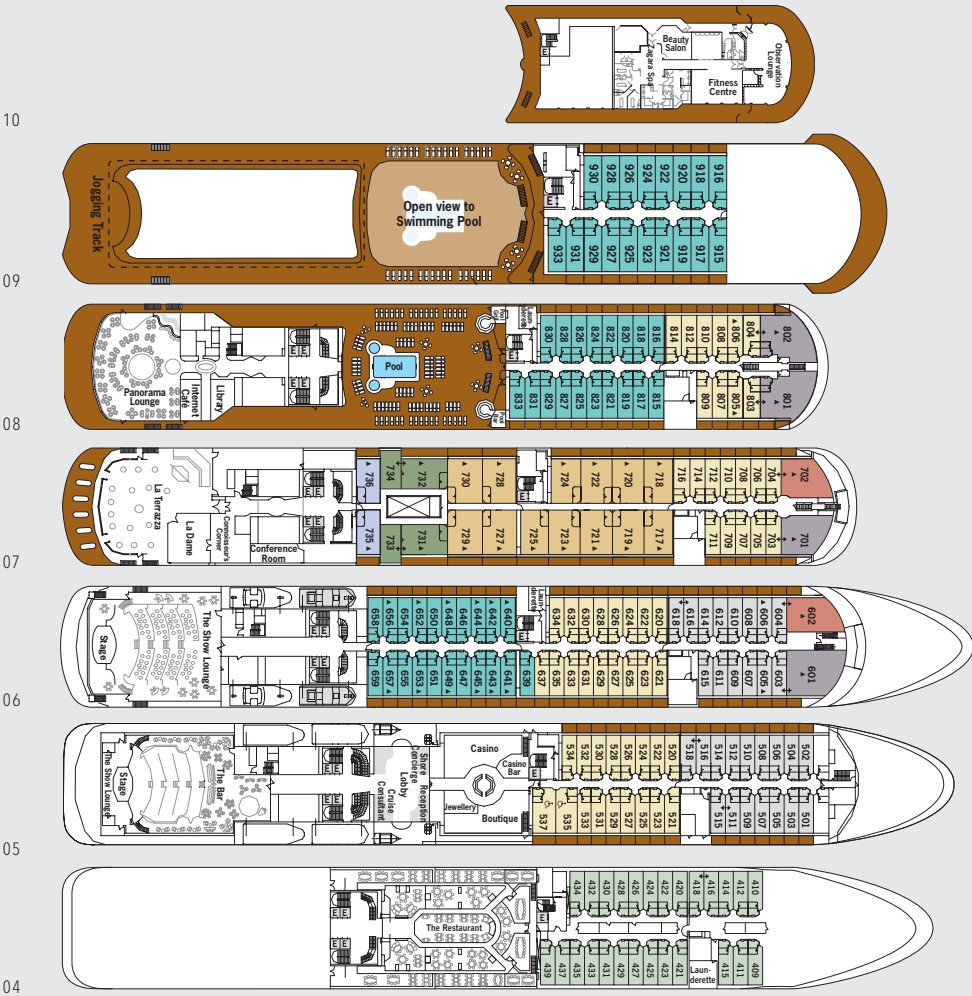

Deck plans are for illustration purposes only and may be subject to change.





## OWNER'S SUITE

Available as a one-bedroom configuration or as a two-bedroom (as illustrated) by adjoining with a Vista Suite.

**1 BEDROOM:** 919 SQ. FT. / 85 M<sup>2</sup>  
INCLUDING VERANDA (220 SQ. FT. / 20 M<sup>2</sup>);  
**2 BEDROOM:** 1,264 SQ. FT. / 117 M<sup>2</sup>  
INCLUDING VERANDA (220 SQ. FT. / 20 M<sup>2</sup>)

- Large veranda with patio furniture and floor-to-ceiling glass doors; bedroom two has additional large picture window
- Living room with sitting area; bedroom two has additional sitting area
- Separate dining area and bar
- Twin beds or king-sized bed; bedroom two has additional twin beds or queen-sized bed
- Marble bathroom with double vanity, separate shower and full-sized whirlpool bath, plus a powder room; bedroom two has additional marble bathroom with full-sized bath
- Walk-in wardrobe(s) with personal safe
- Vanity table(s) with hair dryer
- Writing desk(s)
- Flat-screen television(s) with Interactive Media Library
- Bose® sound system with bluetooth connectivity
- Illy® espresso machine
- Unlimited Premium Wifi



## GRAND SUITE

Available as a one-bedroom configuration or as a two-bedroom (as illustrated) by adjoining with a Vista Suite.

**1 BEDROOM:** 941-1,090 SQ. FT. / 87-101 M<sup>2</sup>  
INCLUDING VERANDA (103-116 SQ. FT. / 10-11 M<sup>2</sup>);  
**2 BEDROOM:** 1,286-1,435 SQ. FT. / 119-133 M<sup>2</sup>  
INCLUDING VERANDA (163-176 SQ. FT. / 16-17 M<sup>2</sup>)

- Large veranda with patio furniture and floor-to-ceiling glass doors; bedroom two has additional veranda
- Living room with sitting area; bedroom two has additional sitting area
- Separate dining area and bar
- Twin beds or king-sized bed; bedroom two has additional twin beds or queen-sized bed
- Marble bathroom with double vanity, separate shower and full-sized whirlpool bath, plus a powder room; bedroom two has additional marble bathroom with full-sized bath
- Walk-in wardrobe(s) with personal safe
- Vanity table(s) with hair dryer
- Writing desk(s)
- Flat-screen television(s) with Interactive Media Library
- Bose® sound system with bluetooth connectivity
- Illy® espresso machine
- Unlimited Premium Wifi



## ROYAL SUITE

Available as a one-bedroom configuration or as a two-bedroom (as illustrated) by adjoining with a Vista Suite.

**1 BEDROOM:** 967-1,007 SQ. FT. / 90-94 M<sup>2</sup>  
INCLUDING VERANDA (110-116 SQ. FT. / 10-11 M<sup>2</sup>);  
**2 BEDROOM:** 1,312-1,352 SQ. FT. / 122-126 M<sup>2</sup>  
INCLUDING VERANDA (170-176 SQ. FT. / 16-17 M<sup>2</sup>)

- Large veranda with patio furniture and floor-to-ceiling glass doors; bedroom two has additional veranda
- Living room with sitting area; bedroom two has additional sitting area
- Separate dining area and bar
- Twin beds or king-sized bed; bedroom two has additional twin beds or queen-sized bed
- Marble bathroom with double vanity, separate shower and full-sized whirlpool bath, plus a powder room; bedroom two has additional marble bathroom with full-sized bath
- Walk-in wardrobe(s) with personal safe
- Vanity table(s) with hair dryer
- Writing desk(s)
- Flat-screen television(s) with Interactive Media Library
- Bose® sound system with bluetooth connectivity
- Illy® espresso machine
- Unlimited Premium Wifi



## SILVER SUITE

Silver Suites accommodate three guests.

653-701 SQ. FT. / 61-65 M<sup>2</sup>  
INCLUDING VERANDA (110-123 SQ. FT. / 10-11 M<sup>2</sup>)

- Veranda with patio furniture and floor-to-ceiling glass doors
- Living room (with convertible sofa to accommodate an additional guest)
- Sitting area
- Separate dining area
- Twin beds or queen-sized bed
- Marble bathroom with double vanity, separate shower and full-sized whirlpool bath
- Walk-in wardrobe with personal safe
- Vanity table with hair dryer
- Writing desk
- Flat-screen television(s) with Interactive Media Library
- Bose® sound system with bluetooth connectivity
- Illy® espresso machine
- Unlimited Premium Wifi



## MEDALLION SUITE

Medallion Suites accommodate three guests.

521 SQ. FT. / 49 M<sup>2</sup>  
INCLUDING VERANDA (81 SQ. FT. / 8 M<sup>2</sup>)

- Veranda with patio furniture and floor-to-ceiling glass doors
- Living room with sitting and dining area
- Twin beds or queen-sized bed
- Marble bathroom with double vanity, separate shower and full-sized whirlpool bath
- Walk-in wardrobe with personal safe
- Vanity table with hair dryer
- Writing desk
- Flat-screen television with Interactive Media Library
- Bose® sound system with bluetooth connectivity
- Illy® espresso machine
- Unlimited Premium Wifi



## DELUXE VERANDA SUITE SUPERIOR VERANDA SUITE CLASSIC VERANDA SUITE

Veranda Suites 605, 606, 640-645, 648, 649, 652, 653, 656 and 657 accommodate three guests. Deluxe Verandas offer preferred central location with identical accommodations to Classic and Superior Verandas.

345 SQ. FT. / 32 M<sup>2</sup>  
INCLUDING VERANDA (60 SQ. FT. / 6 M<sup>2</sup>)

- Veranda with patio furniture and floor-to-ceiling glass doors
- Sitting area
- Twin beds or queen-sized bed
- Marble bathroom with double vanity, full-sized bath, separate shower
- Walk-in wardrobe with personal safe
- Vanity table with hair dryer
- Writing desk
- Flat-screen television with Interactive Media Library
- Unlimited Standard Wifi



## VISTA SUITE

287 SQ. FT. / 27 M<sup>2</sup>

- Large picture window providing panoramic ocean views (Vista Suite)
- Sitting area
- Twin beds or queen-sized bed
- Marble bathroom with double vanity, full-sized bath, separate shower
- Walk-in wardrobe with personal safe
- Vanity table with hair dryer
- Writing desk
- Flat-screen television with Interactive Media Library
- Unlimited Standard Wifi

## AMENITIES & FEATURES FOR ALL SUITES

- Butler service
- Refrigerator and bar setup stocked with your preferences
- Pillow menu
- Luxury bath amenities
- Plush bathrobe and slippers
- Personalised stationery
- Umbrella
- Complimentary Wifi for all suites
- Direct-dial telephone(s)
- Champagne on arrival



# SILVER WIND

Effective from June 2021

## SHIP SPECIFICATIONS

Crew	239
Officers	International
Guests	274
Tonnage	17,400
Length	514.14 Feet/156.7 Mt
Width	70.62 Feet/21.5 Mt
Speed	18 Knots
Converted ice-class	2021

## DECK 09

- Fitness Centre
- Beauty Spa
- Observation Library
- Jogging Track

## DECK 08

- Pool Deck
- Pool Bar
- The Grill
- Panorama Lounge
- Connoisseur's Corner

## DECK 07

- La Terrazza

## DECK 06

- The Show Lounge
- Conference Room
- Reception/Guest Relations

## DECK 05

- Dolce Vita
- Boutique
- Photo Studio

## DECK 04

- The Restaurant
- La Dame
- Launderette

## DECK 03

- Changing Room
- Medical Centre

## SUITE CATEGORIES

- Owner's Suite
- Grand Suite
- Royal Suite
- Silver Suite
- Medallion Suite
- Deluxe Veranda Suite
- Classic Veranda Suite
- Vista Suite

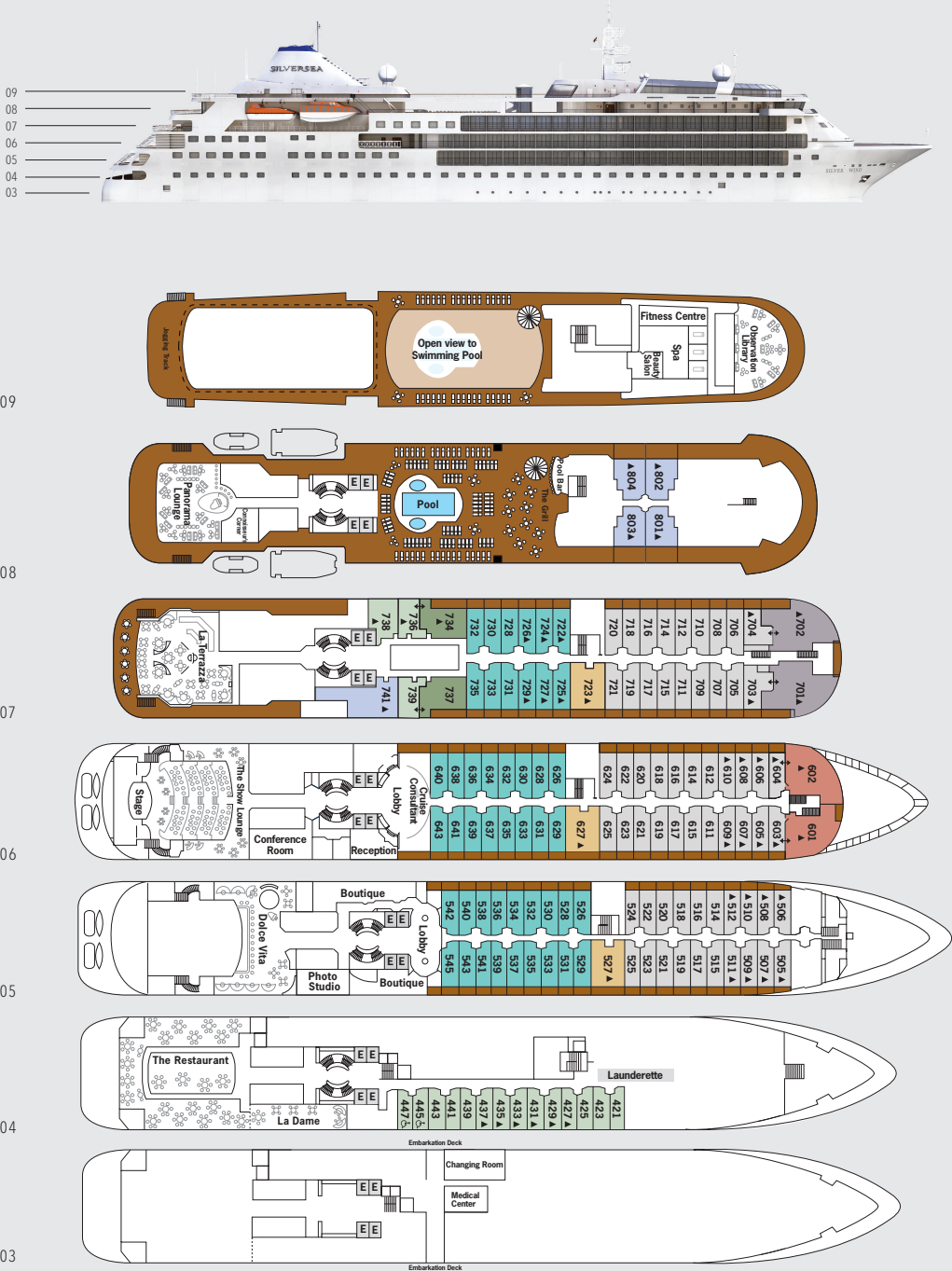

Deck plans are for illustration purposes only and may be subject to change.





## OWNER'S SUITE

Available as a one-bedroom configuration or as a two-bedroom by adjoining with a Vista Suite.

**1 BEDROOM:** 587 SQ. FT. / 55 M<sup>2</sup>  
INCLUDING VERANDA (89 SQ. FT. / 8 M<sup>2</sup>);  
**2 BEDROOM:** 827 SQ. FT. / 77 M<sup>2</sup>  
INCLUDING VERANDA (89 SQ. FT. / 8 M<sup>2</sup>)

- Large veranda with patio furniture and floor-to-ceiling glass doors; bedroom two has additional large picture window
- Living room (with convertible sofa to accommodate an additional guest) (Suite 734 only); bedroom two has additional sitting area
- Separate dining area
- Twin beds or king-sized bed; bedroom two has additional twin beds or queen-sized bed
- Bathroom with separate bath and shower; bedroom two has additional bathroom with walk-in shower
- Walk-in wardrobe(s) with personal safe
- Vanity table(s) with hair dryer
- Writing desk(s)
- Flat-screen HD TVs
- Interactive Media Library
- Bose® sound system with bluetooth connectivity
- Illy® espresso machine
- Unlimited Premium Wifi



## GRAND SUITE

Available as a one-bedroom configuration or as a two-bedroom by adjoining with a Classic Veranda Suite.

**1 BEDROOM:** 1,019 SQ. FT. / 95 M<sup>2</sup>  
INCLUDING VERANDA (145 SQ. FT. / 14 M<sup>2</sup>);  
**2 BEDROOM:** 1,314 SQ. FT. / 122 M<sup>2</sup>  
INCLUDING VERANDA (194 SQ. FT. / 18.5 M<sup>2</sup>)

- Two verandas with patio furniture and floor-to-ceiling glass doors; bedroom two has additional veranda
- Living room (with convertible sofa to accommodate an additional guest); bedroom two has additional sitting area
- Separate dining area
- Twin beds or king-sized bed; bedroom two has additional twin beds or queen-sized bed
- Bathroom with full-sized bath; bedroom two has additional bathroom with walk-in shower
- Walk-in wardrobe(s) with personal safe
- Vanity table(s) with hair dryer
- Writing desk(s)
- Flat-screen HD TVs
- Interactive Media Library
- Bose® sound system with bluetooth connectivity
- Illy® espresso machine
- Unlimited Premium Wifi



## ROYAL SUITE

Available as a one-bedroom configuration or as a two-bedroom by adjoining with a Classic Veranda Suite.

**1 BEDROOM:** 736 SQ. FT. / 69 M<sup>2</sup>  
INCLUDING VERANDA (126 SQ. FT. / 12 M<sup>2</sup>);  
**2 BEDROOM:** 1,031 SQ. FT. / 96 M<sup>2</sup>  
INCLUDING VERANDA (175 SQ. FT. / 16.5 M<sup>2</sup>)

- Large veranda with patio furniture and floor-to-ceiling glass doors; bedroom two has additional veranda
- Living room (with convertible sofa to accommodate an additional guest); bedroom two has additional sitting area
- Separate dining area
- Twin beds or king-sized bed; bedroom two has additional twin beds or queen-sized bed
- Bathroom with full-sized bath; bedroom two has additional bathroom with walk-in shower
- Walk-in wardrobe(s) with personal safe
- Vanity table(s) with hair dryer
- Writing desk(s)
- Flat-screen HD TVs
- Interactive Media Library
- Bose® sound system with bluetooth connectivity
- Illy® espresso machine
- Unlimited Premium Wifi



## SILVER SUITE

Silver Suites accommodate three guests.

517 SQ. FT. / 48 M<sup>2</sup>  
INCLUDING VERANDA (92 SQ. FT. / 8 M<sup>2</sup>)

- Veranda with patio furniture and floor-to-ceiling glass doors
- Living room (with convertible sofa to accommodate an additional guest)
- Sitting area
- Separate dining area
- Twin beds or queen-sized bed
- Bathroom with full-sized bath
- Walk-in wardrobe with personal safe
- Vanity table with hair dryer
- Writing desk
- Flat-screen HD TVs
- Interactive Media Library
- Bose® sound system with bluetooth connectivity
- Illy® espresso machine
- Unlimited Premium Wifi



## MEDALLION SUITE

Medallion Suites accommodate three guests.

**SUITES 801-804:** 441 SQ. FT. / 41 M<sup>2</sup>  
INCLUDING VERANDA (125 SQ. FT. / 12 M<sup>2</sup>)  
**SUITES 741:** 667 SQ. FT. / 62 M<sup>2</sup>  
NO VERANDA

- Large veranda with patio furniture and floor-to-ceiling glass doors (Suites 801-804 only)
- Two French balconies providing panoramic ocean views (Suite 741 only)
- Living room (with convertible sofa to accommodate an additional guest) (Suites 801-804 only)
- Separate dining area (Suite 741 only)
- Twin beds or queen-sized bed
- Bathroom with full-sized bath and shower
- Walk-in wardrobe with personal safe
- Vanity table with hair dryer
- Writing desk
- Flat-screen HD TVs
- Interactive Media Library
- Bose® sound system with bluetooth connectivity
- Illy® espresso machine
- Unlimited Premium Wifi



## DELUXE VERANDA SUITE / CLASSIC VERANDA SUITE

Some Veranda Suites accommodate three guests. The Deluxe Veranda Suite offers preferred central location with identical accommodation to a Classic Veranda Suite.

295 SQ. FT. / 27 M<sup>2</sup>  
INCLUDING VERANDA (49 SQ. FT. / 4.5 M<sup>2</sup>)

- Veranda with patio furniture and floor-to-ceiling glass doors
- Sitting area
- Twin beds or queen-sized bed
- Bathroom with walk-in shower
- Walk-in wardrobe with personal safe
- Vanity table with hair dryer
- Writing desk
- Flat-screen HD TVs
- Interactive Media Library
- Unlimited Standard Wifi



## VISTA SUITE

Some Vista Suites accommodate three guests.

240 SQ. FT. / 22 M<sup>2</sup>  
SUITE 738: 325 SQ. FT. / 30 M<sup>2</sup>

- Large picture window providing panoramic ocean views (Suites 421 to 447 only)
- One French balcony providing panoramic ocean views (Suite 738 only)
- Sitting area
- Twin beds or queen-sized bed
- Bathroom with walk-in shower
- Walk-in wardrobe with personal safe
- Vanity table with hair dryer
- Writing desk
- Flat-screen HD TVs
- Interactive Media Library
- Unlimited Standard Wifi

## AMENITIES & FEATURES FOR ALL SUITES

- Butler service
- Refrigerator and bar setup stocked with your preferences
- Pillow menu
- Luxury bath amenities
- Plush bathrobe and slippers
- Personalised stationery
- Umbrella
- Complimentary Wifi for all suites
- Direct-dial telephone(s)
- Champagne on arrival

Silver Wind is undergoing the largest dry dock in her history and as such, some details presented are likely to change. Suite diagrams shown are for illustration purposes only. Final features, materials, finishes and layout may be different than shown. Please refer to [silversea.com](http://silversea.com) for the most current information and updates.



# SILVER CLOUD

## SHIP SPECIFICATIONS

Crew	212
Officers	European
Guests	240 in Polar waters
Tonnage	17,400
Length	514.14 Feet/156.7 Mt
Width	70.62 Feet/21.5 Mt
Speed	18 Knots
Refurbished	2017
Ice-class Rating	1C



## DECK 09

Tor's Observation Lounge  
Jogging Track

## DECK 08

The Bridge  
Pool  
Pool Bar  
The Grill  
Panorama Lounge  
Connoisseur's Corner

## DECK 07

La Terrazza  
Zagara Beauty Spa  
Library

## DECK 06

Explorer Lounge  
Fitness Centre  
Reception/Guest Relations  
Expedition Office

## DECK 05

Dolce Vita  
Boutique  
Photo Studio

## DECK 04

The Restaurant  
La Dame  
Launderette

## DECK 03

Changing Room  
Medical Centre

## SUITE CATEGORIES

Owner's Suite  
Grand Suite  
Royal Suite  
Silver Suite  
Medallion Suite  
Deluxe Veranda Suite  
Veranda Suite  
Vista Suite

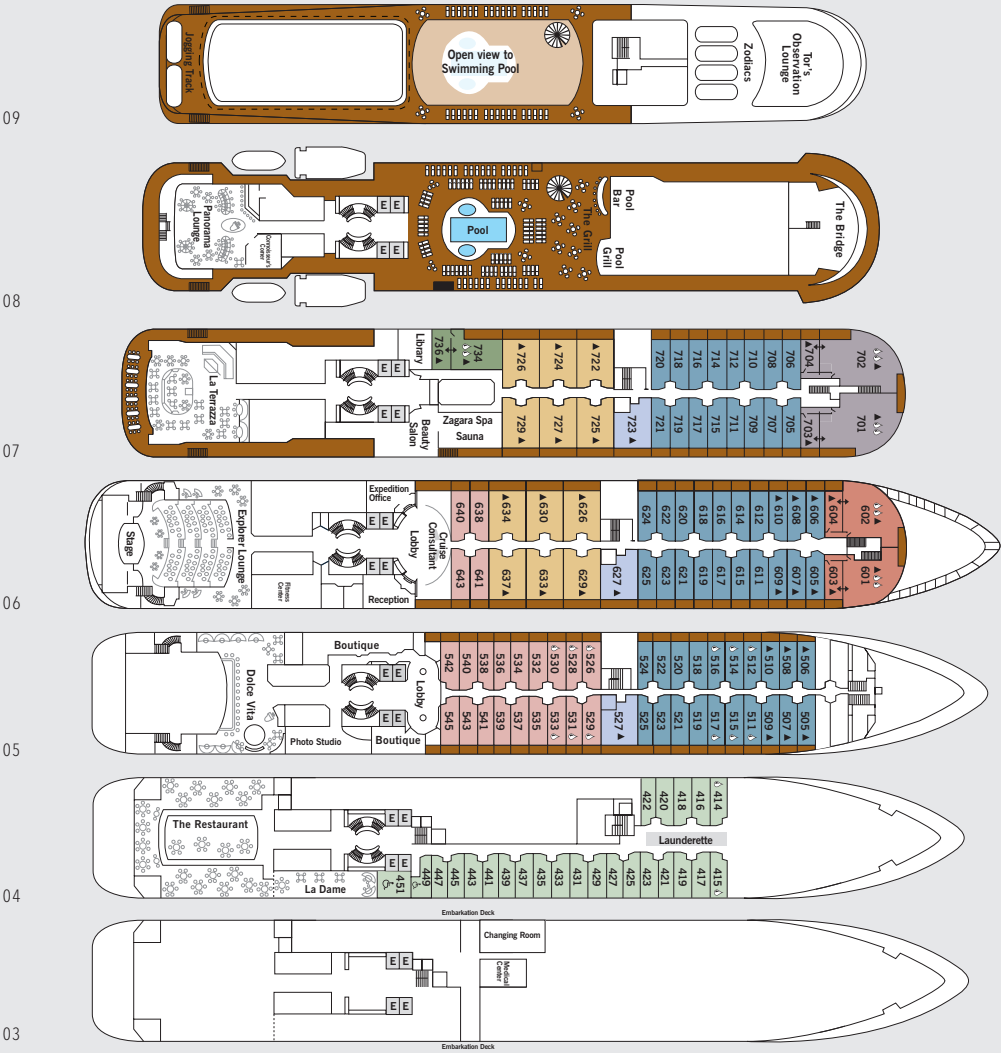





## OWNER'S SUITE

Available as a one-bedroom configuration or as a two-bedroom (as illustrated) by adjoining with a Vista Suite.

**1 BEDROOM:** 587 SQ. FT. / 55 M<sup>2</sup>  
INCLUDING VERANDA (89 SQ. FT. / 8 M<sup>2</sup>)  
**2 BEDROOMS:** 827 SQ. FT. / 77 M<sup>2</sup>  
INCLUDING VERANDA (89 SQ. FT. / 8 M<sup>2</sup>)

- Large veranda with patio furniture and floor-to-ceiling glass doors; bedroom two has additional large picture window
- Living room with sitting area; bedroom two has additional sitting area
- Separate dining area
- Twin beds or king-sized bed; bedroom two has additional twin beds or queen-sized bed
- Marble bathroom with full-sized bath and separate shower; bedroom two has additional marble bathroom with shower (no bath as indicated in diagram)
- Walk-in wardrobe(s) with personal safe
- Vanity table(s) with hair dryer
- Writing desk(s)
- Bose® Sound system with Bluetooth Connectivity
- Unlimited Premium Wifi
- Illy® Espresso machine



## GRAND SUITE

Available as a one-bedroom configuration or as a two-bedroom (as illustrated) by adjoining with a Vista Suite.

**1 BEDROOM:** 1,019 SQ. FT. / 95 M<sup>2</sup>  
INCLUDING VERANDA (145 SQ. FT. / 14 M<sup>2</sup>)  
**2 BEDROOMS:** 1,314 SQ. FT. / 122 M<sup>2</sup>  
INCLUDING VERANDA (194 SQ. FT. / 18.5 M<sup>2</sup>)

- Two verandas with patio furniture and floor-to-ceiling glass doors; bedroom two has additional veranda
- Living room with sitting area; bedroom two has additional sitting area
- Separate dining area
- Twin beds or king-sized bed; bedroom two has additional twin beds or queen-sized bed
- Marble bathroom with full-sized bath and separate shower; bedroom two has additional marble bathroom with shower (no bath as indicated in diagram)
- Walk-in wardrobe(s) with personal safe
- Vanity table(s) with hair dryer
- Writing desk(s)
- Bose® Sound system with Bluetooth Connectivity
- Unlimited Premium Wifi
- Illy® Espresso machine

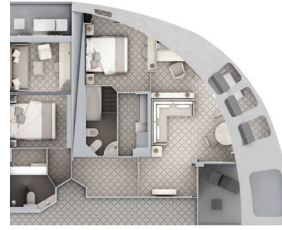

## ROYAL SUITE

Available as a one-bedroom configuration or as a two-bedroom (as illustrated) by adjoining with a Vista Suite.

**1 BEDROOM:** 736 SQ. FT. / 69 M<sup>2</sup>  
INCLUDING VERANDA (126 SQ. FT. / 12 M<sup>2</sup>)  
**2 BEDROOMS:** 1,031 SQ. FT. / 96 M<sup>2</sup>  
INCLUDING VERANDA (175 SQ. FT. / 16.5 M<sup>2</sup>)

- Large veranda with patio furniture and floor-to-ceiling glass doors; bedroom two has additional veranda
- Living room with sitting area; bedroom two has additional sitting area
- Separate dining area
- Twin beds or king-sized bed; bedroom two has additional twin beds or queen-sized bed
- Marble bathroom with full-sized bath and separate shower; bedroom two has additional marble bathroom with shower (no bath as indicated in diagram)
- Walk-in wardrobe(s) with personal safe
- Vanity table(s) with hair dryer
- Writing desk(s)
- Bose® Sound system with Bluetooth Connectivity
- Unlimited Premium Wifi
- Illy® Espresso machine



Silver Suite



Medallion Suite

## SILVER SUITE / MEDALLION SUITE

Silver and Medallion Suites accommodate three guests.

**SILVER SUITE:** 581 SQ. FT. / 54 M<sup>2</sup>  
INCLUDING VERANDA (92 SQ. FT. / 8 M<sup>2</sup>)  
**MEDALLION:** 517 SQ. FT. / 48 M<sup>2</sup>  
INCLUDING VERANDA (81 SQ. FT. / 7.6 M<sup>2</sup>)

- Veranda with patio furniture and floor-to-ceiling glass doors
- Living room with convertible sofa to accommodate an additional guest
- Sitting area
- Separate dining area
- Twin beds or queen-sized bed
- Medallion has marble bathroom with shower; Silver Suite has two bathrooms with shower
- Walk-in wardrobe with personal safe
- Vanity table with hair dryer
- Writing desk
- Bose® Sound system with Bluetooth Connectivity
- Unlimited Premium Wifi
- Illy® Espresso machine



## DELUXE VERANDA SUITE

The Deluxe Veranda Suite offers preferred central location with identical accommodation to a Veranda Suite.

295 SQ. FT. / 27 M<sup>2</sup>  
INCLUDING VERANDA (49 SQ. FT. / 4.5 M<sup>2</sup>)

- Veranda with patio furniture and floor-to-ceiling glass doors
- Sitting area
- Twin beds or queen-sized bed
- Marble bathroom with shower (some with bath/shower combination)
- Walk-in wardrobe with personal safe
- Writing desk
- Hair dryer
- Unlimited Standard Wifi



## VERANDA SUITE

Some Veranda Suites accommodate three guests (Suites 505-510 and 605-610).

295 SQ. FT. / 27 M<sup>2</sup>  
INCLUDING VERANDA (49 SQ. FT. / 4.5 M<sup>2</sup>)

- Veranda with patio furniture and floor-to-ceiling glass doors
- Sitting area
- Twin beds or queen-sized bed
- Marble bathroom with shower (some with bath/shower combination)
- Walk-in wardrobe with personal safe
- Writing desk
- Hair dryer
- Unlimited Standard Wifi



## VISTA SUITE

240 SQ. FT. / 22 M<sup>2</sup>

- Large picture window providing panoramic ocean views
- Sitting area
- Twin beds or queen-sized bed
- Marble bathroom with shower (some with bath/shower combination)
- Walk-in wardrobe with personal safe
- Writing desk
- Hair dryer
- Unlimited Standard Wifi

## AMENITIES & FEATURES FOR ALL SUITES

- Butler service
- Refrigerator and bar setup stocked with your preferences
- Plush bathrobes
- Pillow menu
- Luxury bath amenities
- Complimentary Wifi for all suites
- Personalised stationery
- Umbrella
- Hair dryer
- Wall mounted USB-C mobile device chargers
- Direct-dial telephone(s)
- Champagne on arrival
- Flat-screen television(s) with Interactive media Library
- Dual voltage 110/220 outlets



## IMAGE CAPTIONS

**PAG 2-3** Silver Spirit, Norway, 2018, by Steve McCurry

**PAG 4** Ireland, 2018, by Steve McCurry

**PAG 5** St Isaac's Cathedral, St Petersburg, Russia, 2018, by Steve McCurry

**PAG 6-7** Nyhavn, Copenhagen, Denmark, 2018, by Steve McCurry

**PAG 9** Palace Square, Saint Petersburg, Russia, 2018, by Steve McCurry

**PAG 10** Saint-Emilion, France, 2018, by Steve McCurry

**PAG 11** Giant's Causeway, Ireland, 2018, by Steve McCurry

**PAG 12-13** Norway, 2018, by Steve McCurry

Along with exclusive experiences across all seven continents, we also offer exclusive, value-enhancing programs. All programs are capacity controlled and subject to availability.

### Fare Guarantee Program

Silversea's Fare Guarantee Program provides you with the peace of mind in knowing that when you plan ahead and book early, not only will you be able to reserve your desired suite, but you can also benefit from any future reduction in the Silver Privilege Fares for your voyage, upon request.

### Silver Privilege Fares

Book early for the best fares and availability; Silver Privilege Fares are structured to reward guests who book early with the best possible fare and the privilege of being able to select their desired suite when the best inventory is available. All Silver Privilege Fares shown are cruise-only per guest, based on double-occupancy. Availability of all suite categories cannot be guaranteed. Fares for single guests are available upon request. Additional restrictions may apply.

### Onboard Savings

Book your next voyage while you are sailing and save 5% on select voyages.

### Extended Voyage Savings

Combine two or more consecutive voyages and enjoy a 5% additional benefit.

### Solo Travelers

Single fares are available on all voyages ranging from 25% – 100% above the double occupancy fare.

### Travel Insurance Program

For bookings made by US residents, Silversea offers an optional travel protection plan to guests. Silversea encourages the purchase of the optional Allianz Global Assistance travel insurance plan for the full purchase price of your cruise as well as air and/or land program costs to safeguard your investment and provide peace of mind during your travels. For full details, including pricing, terms and conditions, please visit [silversea.com](http://silversea.com).

### Silver Sky Air Program®

The Silver Sky Air Program extends Silversea's premium level of service beyond your ocean voyage for the ultimate ease in travel. Silversea maintains relationships with most international carriers to ensure that the best airfares and schedules are available in order to make traveling to and from your cruise as convenient as possible. Silversea's standard air package includes roundtrip Economy Class airfare and transfers between airport and pier on embarkation and disembarkation days. In conjunction with select flights, an overnight stay at a Silver Shore Hotel property will be added to the air package at the time of booking as an optional component and for an additional charge.

### My Silversea

Designed to make travel planning easier, My Silversea is a personal profile area which enables you to view and manage bookings, customize your onboard experience, arrange activities prior to your voyage, and access a host of additional features. You will be able to pre-book specialty restaurant dinner reservations in advance (from 120 to 7 days prior to sailing), along with optional shore excursions, beauty, spa and fitness services.



## SILVERSEA LOYALTY PROGRAM

### MEMBERSHIP PRIVILEGES

- Onboard recognition and private parties
- Additional savings on select voyages –look for this icon
- Ship visitation privileges

### MILESTONE REWARDS

- 100 DAYS: 5% savings on future sailings
- 250 DAYS: 10% savings on future sailings
- 350 DAYS: complimentary 7-day voyage
- 500 DAYS: complimentary 14-day voyage
- 500-day milestone, complimentary 7-day voyage for each 150 days sailed

### FRIENDS OF THE SOCIETY® PROGRAMME

- When your new-to-Silversea friends sail with you, as a sponsoring Venetian Society member, you will receive:
- \$250 Shipboard Credit – Available on designated Venetian Society voyages.
- Double Cruise Days – Available on any Silversea sailing.
- Friends who sail with you on a designated Venetian Society voyage will enjoy the same 5% Venetian Society savings that are available to you. This benefit is limited to a maximum of four friends in two additional suites.

*All of the above milestones include complimentary laundry service (excludes dry cleaning and "press only").*



**NOTICE:** For U.S. cruises and guests: Prior to booking, please consult all applicable U.S. Centers for Disease Control travel advisories, warnings, or recommendations relating to cruise travel, available at <http://www.cdc.gov/travel/notices>. If a certain threshold level of COVID-19 is detected onboard your cruise ship during your voyage, your voyage will be ended immediately and the ship will return to the port of embarkation, and your subsequent travel, including your return home, may be restricted or delayed. For cruises and guests worldwide Health and safety protocols, guest conduct rules, and regional travel restrictions vary by ship and destination, and are subject to change without notice. Due to evolving health protocols, imagery and messaging may not accurately reflect onboard and destination experiences, offerings, features, or itineraries. These may not be available during your voyage, may vary by ship and destination, and may be subject to change without notice.

Visit [silversea.com/terms-and-conditions](http://silversea.com/terms-and-conditions) for the full Terms and Conditions or contact our Reservation Team or your Travel Agent



FOR MORE INFORMATION VISIT [SILVERSEA.COM](http://SILVERSEA.COM).

For more details and information, please contact

SIGHTSEERS (HK) LIMITED

SIGHTSEERS (HK) LIMITED

+852 28506168

[sales@sightseers.com.hk](mailto:sales@sightseers.com.hk)

**CONTACT OUR RESERVATION TEAM OR YOUR TRAVEL AGENT**

ASIA	+65 6828 1543
AUSTRALIA	+1300 306 872
AUSTRIA	+43 1 928 7897
BELGIUM	+32 2 401 1432
DENMARK	+45 7014 2898
GERMANY	+49 69 2222 12283
FINLAND	+358 9 2319 5040
FRANCE	+33 1 7070 9622
ITALY	+39 02 3604 9211
JAPAN & KOREA	+81 (0) 3 6868 8834
LATAM	+1 954 713 3951
MONACO	+377 9770 2424
NETHERLANDS	+31 20 713 9298
NEW ZEALAND	+0800 701 427
NORWAY	+47 2103 3400
SWEDEN	+46 8 5068 5493
SWITZERLAND	+41 4458 07181
SPAIN	+34 9380 01962
UNITED STATES AND CANADA	+1 844 885 8417
UK	+44 207 340 0700

**SILVERSEA.COM**

