



Let us be your guide







Exploring far from the mainstream

PONANT, the polar expedition leader and pioneer, is expanding its unique luxury expedition cruise concept with the arrival of four new sisterships, the PONANT EXPLORERS.

PONANT guests will be able to enjoy new travel experiences, such as tropical and subtropical expeditions. Offering a unique blend of discovery and exceptional comfort, even in the most remote corners of the world, is our hallmark.

Le Lapérouse, Le Champlain, Le Bougainville, Le Dumont-d'Urville

The four new stars of our fleet pay tribute to the great French explorers and will carry guests in the wake of these men who, long ago, set off for adventure in search of new lands. Taking inspiration from these navigators was a natural choice for PONANT, the only French cruise line to sail to little-known, remote lands that are inaccessible to larger ships.

Le Lapérouse and *Le Champlain* will join the fleet in 2018, followed by *Le Bougainville* and *Le Dumont-d'Urville* in 2019.

In keeping with our cruise line's philosophy, each ship combines a limited guest capacity, sleek design, cutting-edge technology, and respect for the environment. They will enable PONANT to offer an ever-wider range of destinations.



Let us be your guide

Embarking on a luxury expedition cruise aboard one of the PONANT EXPLORER ships promises an unforgettable trip and thrilling experiences. It also means travelling in the company of experienced crews, expert naturalists, and passionate lecturers.

That is why PONANT has chosen to present the spirit of the PONANT EXPLORERS through four of the cruise line's emblematic figures. Our CEO, captains, and expedition leaders all carry guests in their wake, taking them where others do not go.

Let us be your guide.

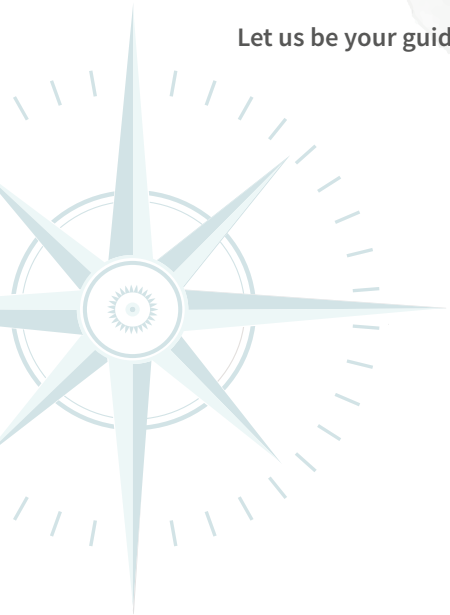

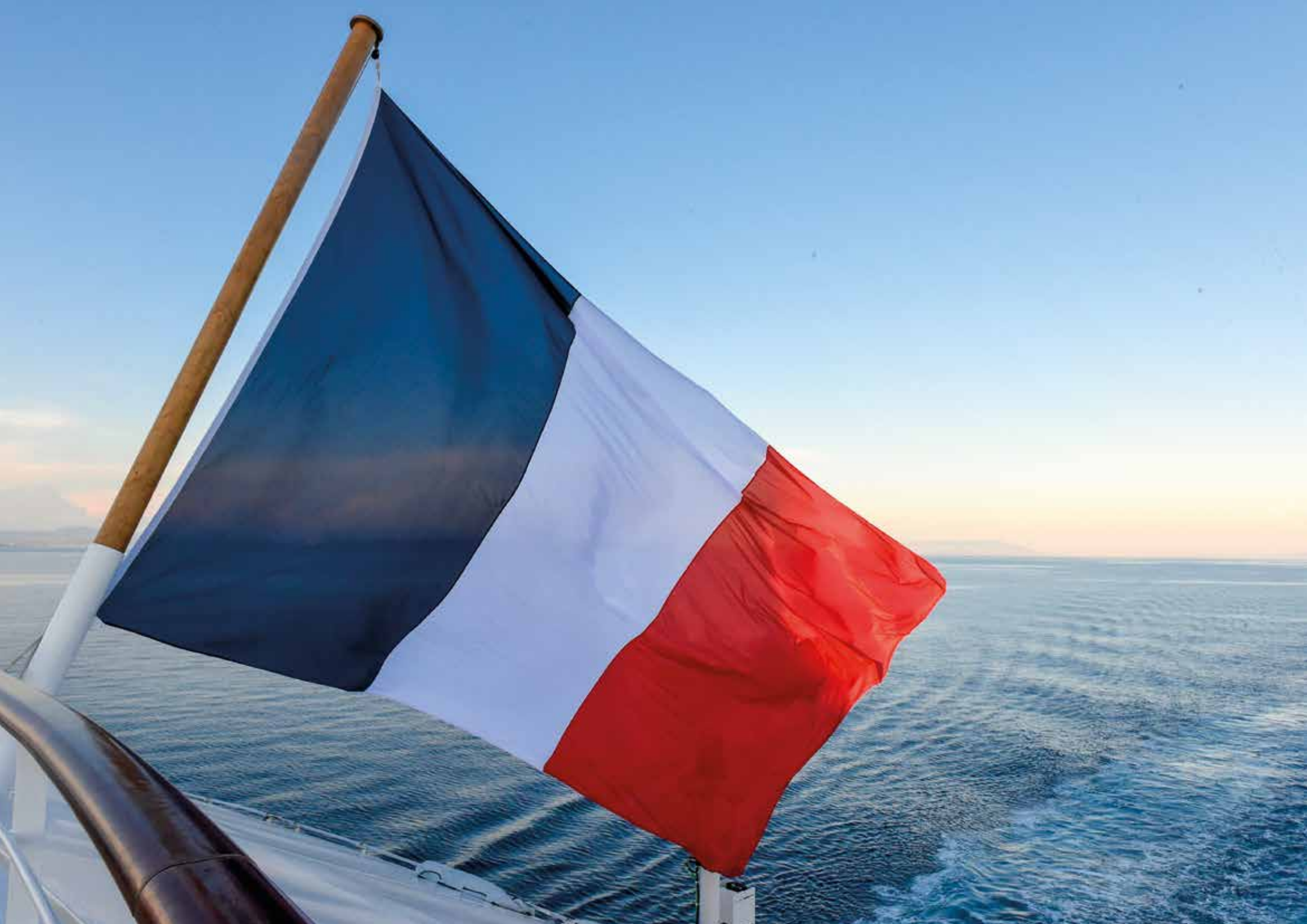

Jean Emmanuel Sauvée CEO

For nearly 30 years, Jean Emmanuel Sauvée has been taking PONANT guests to discover *unknown lands*. Under his helm, PONANT is now the market leader in luxury expeditions, with a unique fleet of sleek yachts designed for expeditions.

“My goal as CEO is to continue to be worthy of the trust our guests place in us, to fulfil their aspirations, imagine what horizons they might wish to discover, and take them to discover places that were inaccessible until now, while providing an unrivalled level of comfort and safety.”

“PONANT is the result of a dream, convictions, energy and audacity. Today, PONANT draws on its roots and its expertise to meet the challenges of the future and to surprise and amaze our guests. I wanted these ships to include the ultimate in expedition ship features.”



Biography

Jean Emmanuel Sauvée was **23 years old** and had just graduated from the École Nationale de la Marine Marchande (France’s National Merchant Navy School) when he created “la Compagnie des Îles du Ponant”. Since then, the cruise line has been sailing the seven seas to discover the most majestic lands, imposing a new style of cruising under the French flag. Today, guided by Jean Emmanuel Sauvée’s strategy and vision, PONANT, the only French-owned cruise line, is number one in the world for luxury expeditions. Antarctica, Greenland, Spitsbergen, Baffin Bay, the Northwest Passage: these places long inspired fear—but also dreams—in the hearts of explorers. These mythical destinations at the edges of the North and South Poles are now accessible thanks to the pioneering spirit that has been a driving force in our company since its creation.

With the arrival of the PONANT EXPLORERS series, Jean Emmanuel Sauvée is continuing this wonderful journey, aboard luxury yachts that perpetuate the PONANT philosophy which our guests hold so dear.



Jean-Philippe Lemaire

Captain

Jean-Philippe Lemaire will be at the helm of *Le Lapérouse*, the first sistership in the PONANT EXPLORERS series. Captain Lemaire has been sharing his passion with guests since the cruise line was created, placing his navigation experience at their service so that they may access some of the world's most remote sites.

“Expeditions mean harnessing all of our professional skill as we sail in the wake of French explorers such as La Pérouse and Champlain.

They are about venturing into nature and meeting the local populations, feeling their authenticity and respecting their lands.

Le Lapérouse is the first in a new series of ships combining technical prowess and environment protection. Punctuated by discoveries and encounters, our expeditions are exceptional trips from which our guests return ‘changed’ by their enriching experience.

On these trips, each landing is an opportunity. It is a privilege for me to be part of this new chapter in the history of PONANT.”



Biography

Years of unfailing loyalty have passed since Jean-Philippe Lemaire took the helm of the three-masted *Le Ponant* for the first time in 1991.

As a founding member of PONANT, he considers himself to be a guardian of “the PONANT spirit”, driven by both experience and the constant desire to venture away from the most popular maritime routes. He is highly motivated to share thrilling natural and ethnological experiences with guests in the comfort and safety of exceptional ships.

He has captained **over 600 cruises**, to the Arctic, the great Amazon River, Oceania and Antarctica, the white continent. A quarter of these were expeditions. Since 1991, the adventure has continued always with the same passion: introducing guests to new horizons.



Nicolas Dubreuil & Mick Fogg

Expedition leaders

Nicolas Dubreuil and Mick Fogg are internationally renowned for their precise and accurate knowledge of extreme environments. By conducting preliminary exploratory trips and preparing carefully for each itinerary, providing expert supervision, and leading discussions and informal chats with guests during a cruise, these Expedition Leaders forge ties and turn PONANT guests into true ambassadors of the shores visited.

“To follow in the wake of great explorers with humility, eyes wide open. That has always been my dream. Oceania is one of my favourite destinations. After 17 years, each trip still fills me with wonder” - M. Fogg

“It’s always a unique thrill to be the first to land at remote sites, whether in the Scattered Islands, the Indian Ocean, or on the Orinoco River in Amazonia. Although we always draw on our past experience, each landing is unique and the emotions and excitement we share are new.

Initiating these explorations aboard ships such as Le Lapérouse is a privilege. They are so comfortable that the explorations are accessible to everyone, even in the most remote parts of the world.

My vocation is to share my knowledge and turn our guests into ambassadors of these places, which need to be recognised and protected.” - N. Dubreuil

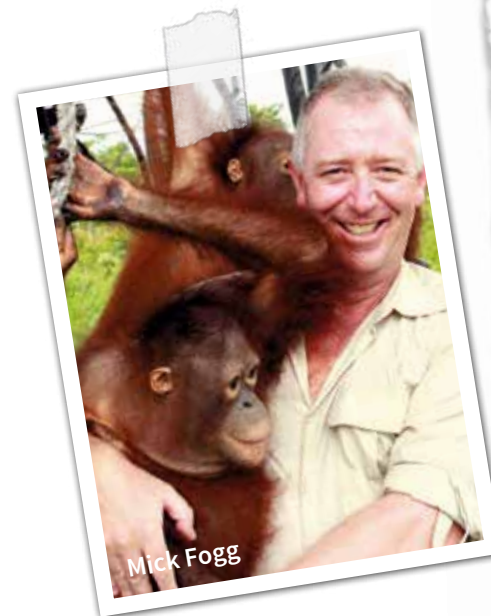

Biographies

Nicolas Dubreuil

Nicolas' first expedition was from Vancouver to Anchorage at the **age of 18**. Since then, he has been spending more than eight months of each year near the poles, which he has travelled across by kayak, on skis, on a sleigh, on foot, and under water. From Alaska to South Georgia, via Nunavut, Spitsbergen, Siberia, Iceland, the Antarctic Peninsula and Greenland, he accompanies and guides expeditions for athletes, scientists, film crews, and the mobility-impaired. Nicolas Dubreuil has been a PONANT expedition leader, guide and ethnologist **for 12 years**.

Mick Fogg

In **2012**, Mick was appointed first Ambassador of Orangutan Foundation International as a reward for his conservation work in Indonesia. He has led over **300 expeditions** through the Asia-Pacific region, sharing his passion for these territories with guests. As an award-winning wildlife photographer and adventurer, Mick Fogg has spent the **past 17 years** leading expeditions to some of the world's most remote and spectacular destinations, from Antarctica to South East Asia.



 PONANT



Welcome aboard

In keeping with its values, PONANT has once again chosen to build intimate, smaller-capacity ships to expand its fleet.

As they are designed for expeditions and easy to manoeuvre, these new ships enable us to offer more and more exceptional itineraries.

On board, guests will find all of the elements that have been the PONANT hallmark for almost 30 years: discreet luxury, comfort, service, and French flair.

Innovation, state-of-the-art technology, atmosphere: the PONANT EXPLORERS are a series of unique yachts designed for luxury expeditions.

Enjoy an exclusive preview of our new ships.

PONANT, in keeping with its pioneering spirit, is launching a world-first:

Le Lapérouse will be the first cruise ship on Earth to be equipped with a multi-sensory underwater space, called Blue Eye.

Le Champlain, Le Bougainville and *Le Dumont-d'Urville* will be the next.



Blue Eye

Multi-sensory underwater space

Blue Eye: the genesis of a global first

In a world exclusive, the four ships of the PONANT EXPLORERS series are equipped with an underwater passenger lounge, called Blue Eye, located within the hull beneath the water line.

The design of this technical prowess was entrusted to architect Jacques Rougerie, who is deeply passionate about the sea. Rougerie's mission is to enable PONANT guests to perceive and feel the underwater universe that has never ceased to amaze and inspire him throughout his career.



The Nautilus - 20,000 Leagues Under the Sea - Jules Verne

"In my work, I have always had my heart set on making people aware of the role that the sea has played in the history of humanity. I designed this multi-sensory underwater lounge in order for it to become enshrined at the heart of the PONANT philosophy.

I set out to discover this fragile and exciting ocean world, which covers 71% of the planet's surface and remains a huge mystery for mankind. The destiny of the civilisations to come will be born from the ocean.

The state-of-the-art technology developed with PONANT lets guests become modern-day explorers, following in the wake of Jules Verne, Jacques-Yves Cousteau and the great adventurers. They will be able to observe the fauna and flora of this sub-aquatic universe and discover its sonorities.

The sound system in the Blue Eye lounge will be installed by Michel Redolfi so as to reveal to the guests the amazing listening capabilities of their bodies. For the first time in the world, the public, during a cruise, will be able to 'feel' and be at the heart of an underwater world. They will need to use all of their senses."



Biography

In 1973, Jacques Rougerie designed the first "Village under the Sea" project in the Virgin Islands, made for living and working beneath the sea. For over 40 years, he has continued his path among those building the future, passionate about the prospective of linking man to his natural setting. He has always designed bionic architecture based on biomimetics. His Blue Eye multi-sensory space concept for the PONANT EXPLORERS is a world-first and a major innovation in man's exploration of the underwater world.



*Jacques Rougerie has always
designed bionic architecture
based on biomimetics.*





Three innovative concepts for a world-first

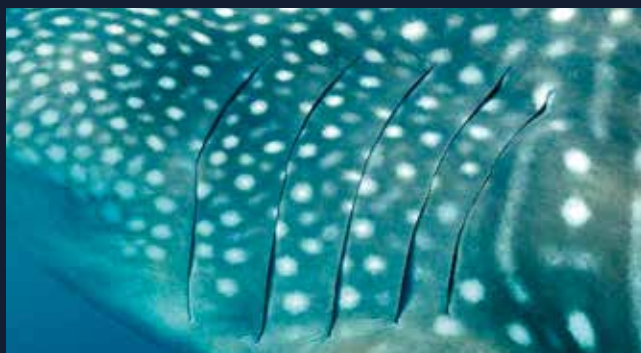

Bionic & biomimetic

Jacques Rougerie drew inspiration from his observation of nature in order to determine the key elements that would underpin the design of the underwater lounge.

The space's graphical references evoke cetaceans and jellyfish. This inspiration is evident in the lines of the lounge, the positioning of the body, the furniture and the fittings.

All focus is drawn towards the two portholes, shaped like the eye of a cetacean and looking out upon the subaquatic world.

The lighting in the lounge is developed through touches, disseminated in the space, allowing the spirit and the gaze to dive into the spectacle unfolding outside. The mural décor disappears to make way for the integrated digital screens projecting the images filmed live by three underwater cameras.

Placed at the ship's strategic points, these cameras enable guests to witness, for example, the spectacle of dolphins playing in the bow waves.



Global listening

The sound staging has been entrusted to Michel Redolfi, a contemporary music composer and sound design expert. A result of his research into subaquatic music and his own inventions, the sound design of the underwater lounge develops state-of-the-art technology and offers guests an experience in acoustic immersion that is unique in the world.

Comfortably ensconced, guests can listen to the underwater world thanks to hydrophones, developed in consultation with specialists from the French Research Institute for the Exploitation of the Sea (IFREMER), that are integrated beneath the keel. The natural symphony of the deep sea is thus captured across a five-kilometre radius and transmitted live into the lounge in the form of

acoustic waves spreading through the three dimensions of Jacques Rougerie's architecture.

An immersive sound experience can be felt in the Body Listening sofas, which discreetly vibrate in unison while offering unique sensory listening through corporal resonance.

This global listening through the entire body, in harmony with the ocean's natural cycles, will bring guests closer to the marine mammals they might see and hear behind the giant portholes.

This exclusive sound experience is also offered through subaquatic concerts broadcast at sea or in the swimming pool.



Innovative underwater vision

The non-intrusive underwater projectors developed expressly for the PONANT EXPLORERS enable the observation of the seabed and photo-luminescent organisms from the Blue Eye lounge as well as from the outside decks, balconies and the marina-without any risk to the marine biosphere.

A permanent quest for excellence

Featuring innovative equipment, elegantly designed cabins, spacious suites with windows, and lounge areas opening on to the outside, these four new limited-capacity yachts (boasting only 92 cabins and suites) will give you a unique cruising experience thanks to their design and smaller size.

Take a guided tour...

Yachts with cutting-edge technology

The sleek exterior lines of the PONANT EXPLORERS, understated and elegant, were conceived by Sterling Design International.



A fully-equipped sundeck and 3-position marina platform allows access to the sea for swimming and water sports (kayaking, paddle boarding, scuba diving, snorkelling, water-skiing, fishing, etc.)



A submersible mini-port, an original and unique concept, enables direct access to the flotilla of 10 Zodiac boats on board.



Grill restaurant and infinity pool fitted with counter-current system.



Reinforced hull for polar navigation.

Innovative green equipment:

Advanced "Cleanship" equipment, in compliance with the most current environmental regulations:

- Wastewater treatment and recycling system in compliance with the most exacting standards
- Catalytic filter on exhaust gases enabling NOX (nitrogen oxides) reduction
- Ballast water treatment system in compliance with international and USCG rules

Fuel economy systems:

- Centralised energy-recovery system
- Extremely precise fuel-measuring and fuel-monitoring system enabling better energy management and savings (the GREENPILOT system)
- Variable-speed electric propulsion combined with controllable pitch propellers enabling the optimisation of propulsive efficiency at all speeds

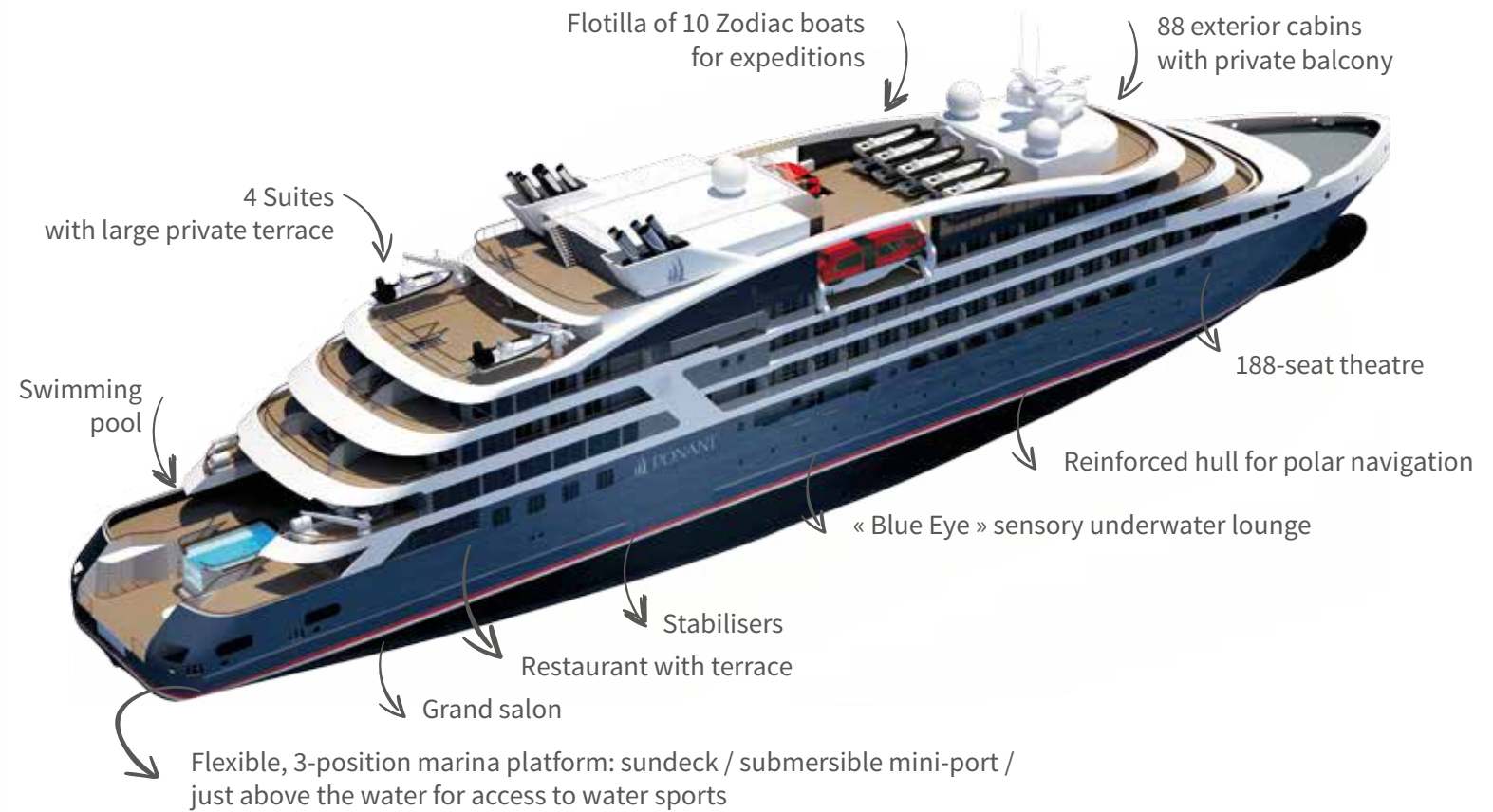

Length.....	131 metres	Classification	Bureau Veritas	Panoramic restaurant	1
Width.....	18 metres	Flag	French	Grill restaurant	1
Water draught.....	4.6 metres	Crew members	110	Spa & Wellness	1
Average cruising speed	15 knots	Cabins with balcony.....	88	On-board expedition Zodiacs.....	10
Ice Class	1C	Suites with windows and private terrace.....	4	On-board launch, Boston Whaler type.....	1

A luxurious, intimate and refined atmosphere

These new smaller-capacity yachts boast elegantly-designed cabins, spacious suites with bay windows, and lounge areas opening onto the outside. Their design and size are the guarantee of a unique cruising experience in the comfort and elegance that are PONANT's hallmark. The warm and contemporary interior design by Jean-Philippe Nuel takes direct inspiration from the destinations and cultures explored during PONANT's stopovers and is punctuated with ethnic touches.



Reception - Batten wood plays with light for an exotic, resort-like environment.



Observatory - A cosy and serene lookout point.



Panoramic restaurant - French cuisine and gastronomy take pride of place.



Theatre - 188 seats within fluid lines that are inspired by the marine world.



Grand salon - An "ethnic chic" ambiance, opening onto the exterior. Small details draw on tribal inspiration to evoke the cultures and destinations visited.



Relaxation area, spa, fitness room and sauna with a unique panoramic view.

Cabins & Suites

A haven in which luxury and nature are reinvented in a refined resort atmosphere.

- 88 cabins with private balconies that open onto the sea
- 4 suites with bay windows and private terraces



Cabin with balcony



Suite with balcony or private terrace, including the Owner's Suite with an outdoor hot tub.

Amenities

- Individually controlled air-conditioning
- Non-smoking rooms
- Double or two single beds, communicating rooms available (for families with children)
- Choice of pillow (down or hypoallergenic)
- Mini bar (unlimited drinks, replenished every day)
- Kettle and Nespresso coffee machine
- Flat-screen TV, television channels via satellite
- On-demand video
- Desk with writing pad
- Electronic safe
- Selection of Hermès bath products
- Dressing table and hair dryer
- Direct telephone line via satellite
- 110/220 volt outlets
- Room service twice daily
- Room Service 24h
- Butler service
- Laundry service (at an additional charge)
- Wi-Fi internet access
- Outdoor hot tub in Owner's Suite

Your vessel

OWNER'S SUITE

(45m² + 30m² private terrace with hot tub and sliding bay windows)

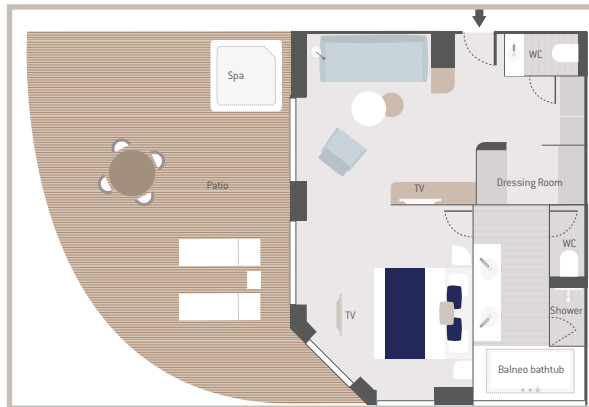

3 GRAND DELUXE SUITES

(45m² + 30m² private terrace and sliding bay windows)

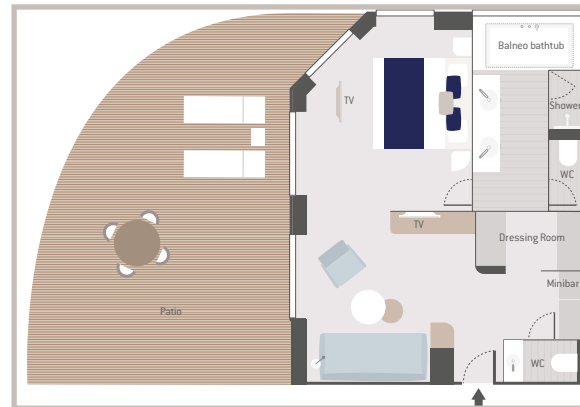

4 PRIVILEGE SUITES

(32m² + 8m² private balcony with sliding bay window)

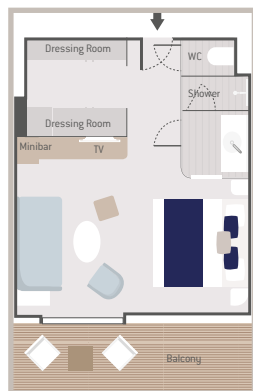

13 PRESTIGE SUITES

(38m² + 8m² private balcony with sliding bay window)

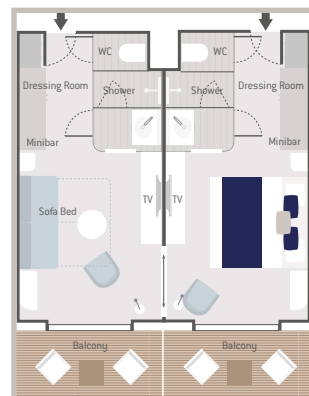

5 DELUXE SUITES

(27.5m² + 6m² private balcony with sliding bay window)



66 PRESTIGE CABINS

(19m² + 4m² private balcony with sliding bay window)

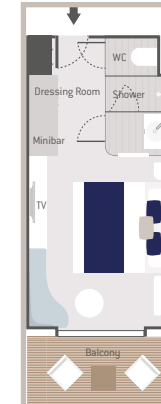

13 DELUXE CABINS

(19m² + 4m² private balcony with French window)

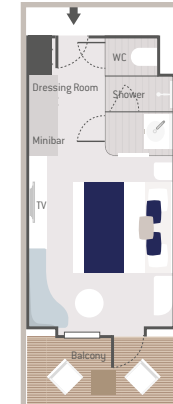

DECK 7



DECK 7

Fitness room - Ponant Yacht Spa (3 treatment cabins and 1 sauna) - Sundeck - Fleet of 10 Zodiacs

DECK 6

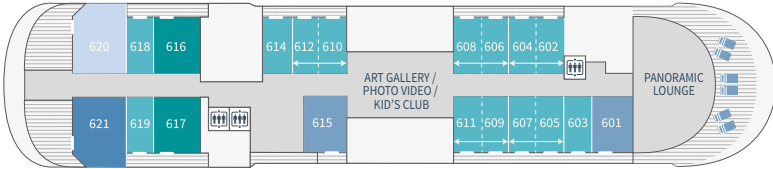

DECK 6

Observatory - Art /Photo video gallery - Kid's Club - 14 Prestige Cabins (including 10 Prestige Cabins convertible into 5 Prestige Suites) - 2 Deluxe Suites - 2 Privilege Suites - 1 Grand Deluxe Suite with spa bath and shower - 1 Owner's Suite with outdoor hot tub

DECK 5

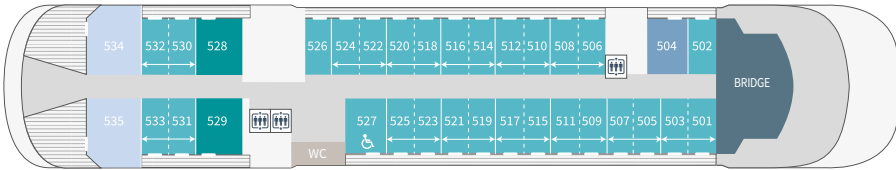

DECK 5

Bridge - 29 Prestige Cabins (including 1 for guests with reduced mobility and 26 Prestige Cabins convertible into 13 Prestige Suites) - 1 Deluxe Suite - 2 Privilege Suites - 2 Grand Deluxe Suites with spa bath and shower

DECK 4



DECK 4

Restaurant - 23 Prestige Cabins (including 1 for guests with reduced mobility) - 1 Deluxe Suite

DECK 3

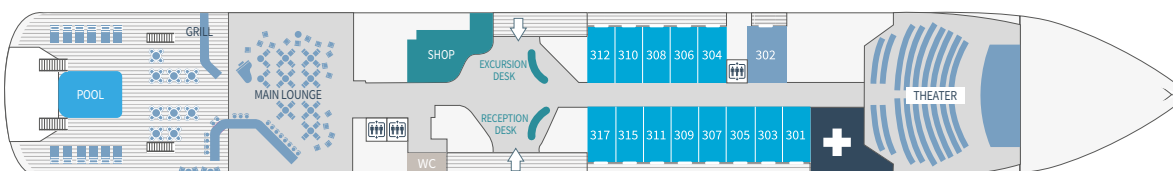

DECK 3

Reception - Excursions Office - Grand Salon - Pool deck with counter-current system and infinity pool - Boutique - Medical centre - Theatre - 13 Deluxe Cabins - 1 Deluxe Suite

DECK 2

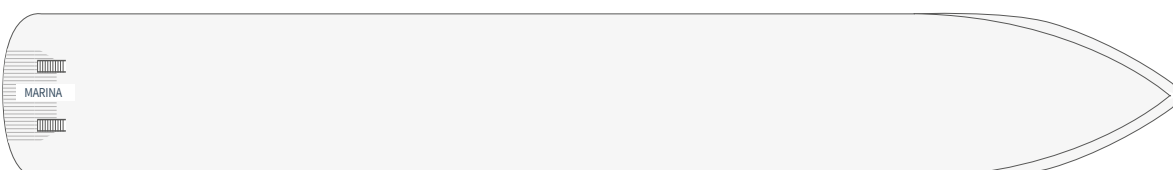

DECK 2

3-position marina platform - Sundeck

DECK 0

Blue Eye underwater lounge

- Owner's Suite
Deck 6
- Privilege Suites
Deck 5-6
- Grand Deluxe Suites
Deck 5-6
- Prestige Suites
Deck 5-6
- Deluxe Suites
Deck 5-6
- Prestige Cabins
Deck 4-5-6
- Deluxe Cabins
Deck 3

Discover exceptional cultures and destinations

Costa Rica, the Amazon, the Maldives, Papua New Guinea, the Orinoco, the Bissagos Islands... In addition to our polar expeditions, now guests can experience a tropical or subtropical expedition accompanied by PONANT's guides and experts. In addition to our company's most popular destinations—such as the Mediterranean or the Baltic Sea—these new yachts will allow for the exploration of unexpected destinations via itineraries created by true sailors. On the program: spectacular scenery, authentic encounters, close-up observation of wild animals, and much more.

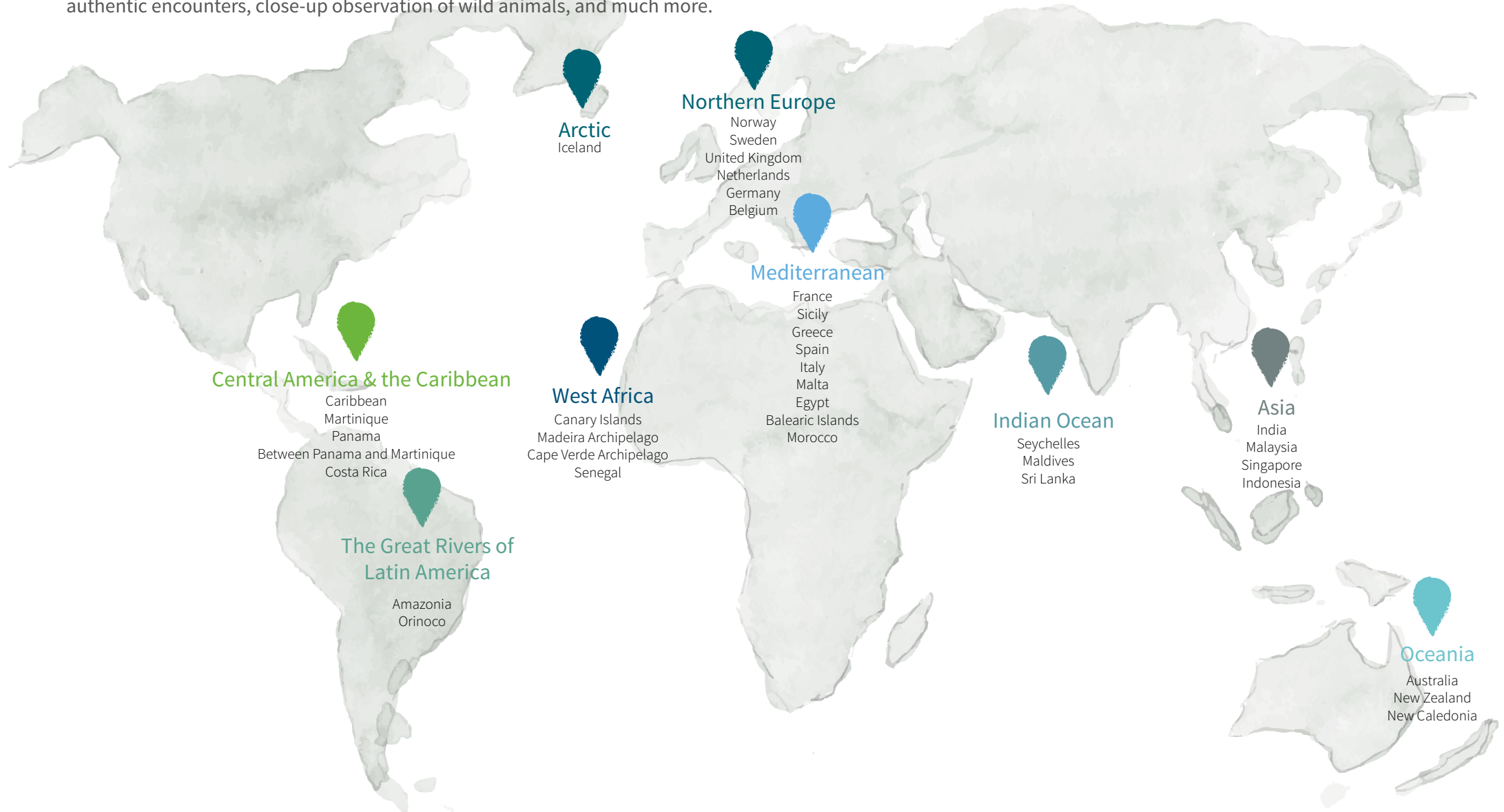



Bali



Australia



Melanesia



Orinoco



Caribbean

June to December 2018

DEPARTING	ARRIVING	SHIP	ITINERARY	AREA / COUNTRIES
ARCTIC & NORTHERN EUROPE				
19/06/2018	26/06/2018	<i>Le Lapérouse</i>	Reykjavik - Reykjavik	Iceland
26/06/2018	03/07/2018	<i>Le Lapérouse</i>	Reykjavik - Reykjavik	Iceland
14/08/2018	22/08/2018	<i>Le Lapérouse</i>	Reykjavik - Bergen	Iceland, United Kingdom and Norway
22/08/2018	29/08/2018	<i>Le Lapérouse</i>	Bergen - Copenhagen	Norway, Sweden and Denmark
29/08/2018	05/09/2018	<i>Le Lapérouse</i>	Copenhagen - London	Denmark, Germany, Netherlands, Belgium and United Kingdom
INDIAN OCEAN				
29/11/2018	11/12/2018	<i>Le Lapérouse</i>	Mahe - Mahe	Seychelles
11/12/2018	21/12/2018	<i>Le Lapérouse</i>	Mahe - Colombo	Seychelles, Maldives and Sri Lanka
MEDITERRANEAN				
13/09/2018	21/09/2018	<i>Le Lapérouse</i>	Lisbon - Civitavecchia	Portugal, Spain, Corsica and Italy
20/09/2018	27/09/2018	<i>Le Champlain</i>	Civitavecchia - Valletta	Italy and Malta
28/09/2018	05/10/2018	<i>Le Lapérouse</i>	Valletta - Athens	Malta, Italy and Greece
04/10/2018	11/10/2018	<i>Le Champlain</i>	Valletta - Valletta	Italy, Sicily and Malta
11/10/2018	18/10/2018	<i>Le Champlain</i>	Valletta - Valletta	Italy, Sicily and Malta
19/10/2018	26/10/2018	<i>Le Lapérouse</i>	Athens - Civitavecchia	Greece, Sicily and Italy
25/10/2018	01/11/2018	<i>Le Champlain</i>	Marseille - Malaga	France and Spain
26/10/2018	02/11/2018	<i>Le Lapérouse</i>	Civitavecchia - Civitavecchia	Corsica, Spain and Italy
01/11/2018	08/11/2018	<i>Le Champlain</i>	Malaga - Tenerife	Spain, Morocco, Madeira Archipelago and Canary Islands
09/11/2018	17/11/2018	<i>Le Lapérouse</i>	Athens - Ain Sukhna	Greece and Egypt
WEST AFRICA				
08/11/2018	17/11/2018	<i>Le Champlain</i>	Tenerife - Dakar	Canary Islands, Cape Verde Archipelago and Senegal

November 2018 to May 2019*

DEPARTING	ARRIVING	SHIP	ITINERARY	AREA / COUNTRIES
GREAT RIVERS: AMAZON & ORINOCO				
25/11/2018	07/12/2018	<i>Le Champlain</i>	Cayenne - Manaus	Amazonia
07/12/2018	19/12/2018	<i>Le Champlain</i>	Manaus - Cayenne	Amazonia
19/12/2018	28/12/2018	<i>Le Champlain</i>	Cayenne - Fort-de-France	Orinoco
29/03/2019	10/04/2019	<i>Le Champlain</i>	Manaus - Cayenne	Amazonia
CARIBBEAN & LATIN AMERICA				
28/12/2018	04/01/2019	<i>Le Champlain</i>	Fort-de-France - Fort-de-France	The Caribbean
04/01/2019	13/01/2019	<i>Le Champlain</i>	Fort-de-France - Colon	Martinique and Panama
17/02/2019	24/02/2019	<i>Le Champlain</i>	Puerto Caldera - Colon	Panama and Costa Rica
24/02/2019	05/03/2019	<i>Le Champlain</i>	Colon - Fort-de-France	Panama and Martinique
05/03/2019	17/03/2019	<i>Le Champlain</i>	Fort-de-France - Cayenne	The Caribbean and the Orinoco
ASIA				
21/12/2018	04/01/2019	<i>Le Lapérouse</i>	Colombo - Singapore	India, Malaysia and Singapore
05/01/2019	17/01/2019	<i>Le Lapérouse</i>	Singapore - Bali	Singapore and Indonesia
17/01/2019	31/01/2019	<i>Le Lapérouse</i>	Bali - Cairns	Indonesia and Australia
OCEANIA				
31/01/2019	09/02/2019	<i>Le Lapérouse</i>	Cairns - Sydney	Australia
25/03/2019	03/04/2019	<i>Le Lapérouse</i>	Dunedin - Auckland	Essential New Zealand
03/04/2019	12/04/2019	<i>Le Lapérouse</i>	Auckland - Dunedin	Essential New Zealand
12/04/2019	21/04/2019	<i>Le Lapérouse</i>	Dunedin - Auckland	Essential New Zealand
21/04/2019	06/05/2019	<i>Le Lapérouse</i>	Auckland - Cairns	New Caledonia

* Itineraries in progress, subject to modification.



