



LATIN AMERICA & CARIBBEAN COLLECTION

WINTER CRUISES 2016 - 2017



PONANT

YACHT CRUISES & EXPEDITIONS



PHOTO

Secrets of exotic destinations

Peru, Chile, Brazil, Costa Rica, Panama... but also the Grenadines, the British Virgin Islands, Martinique... these are all names that inspire travel and adventure.

For its 2016/2017 season, PONANT is bringing you a selection of unique itineraries through Latin America, the birthplace of ancient civilizations and a destination full of contrasts. From the famous Panama Canal to the mythical Cape Horn, via the two must-see sites Tikal and Machu Picchu, not to mention the vast wild expanses of the Andes Mountain Range and the Chilean fjords, the Latin American continent is inviting you to discover the diversity of its landscapes and the extraordinary richness of its cultural sites aboard *LE BORÉAL* and *LE SOLÉAL*.

Unless you would prefer your adventure to take you farther north, to the heart of the unspoiled Caribbean islands with their crystal-clear waters and long, golden-sand beaches lined with coconut trees and exotic flowers. Let the gentle ripple of the breeze in the sails lull you, or take a dip from the stern marina platform, and wake each morning under a new azure sky. Aboard *LE PONANT*, come and experience a different kind of cruising.

Join us to discover the magic of the PONANT experience – a subtle blend of excitement, refinement and authenticity.

See you on board very soon.







SUMMARY

WHY SAIL IN LATIN AMERICA & IN THE CARIBBEAN WITH PONANT?	06
YOUR CRUISES	08
LATIN AMERICA	10
THE CARIBBEAN	34
LE BORÉAL & LE SOLÉAL	48
LE PONANT	52
PRICE LIST	56
GENERAL IMPORTANT INFORMATION	58
INSURANCE	62

WHY SAIL IN LATIN AMERICA & IN THE CARIBBEAN WITH PONANT?

Do you have a different vision of travel? Does it involve moving from destination to destination and country to country without having to pack and unpack your suitcase each time? PONANT is offering you the chance to travel farther into Latin America, land of mysteries and contrasts, keeper of ancient civilizations. After which the natural treasures of the Caribbean islands will reveal themselves to you, laying bare the beauty of their turquoise waters and idyllic beaches.

Because cruising does not mean just seeing the coastline and skimming the shores of a distant land, PONANT offers you another perspective with our program of shore excursions that are rich in culture and sensations. Enjoy the must-see sites of Latin America and the Caribbean as we drop anchor in carefully selected ports of call.

As a privileged passenger on whichever cruise you choose, embark on *LE BORÉAL*, *LE SOLÉAL* or *LE PONANT*, our elegant yacht, and discover these legendary lands between pre-Columbian monuments, deep forests, crystal-clear water and fine-sand beaches. During your cruise, journey in the wake of Christopher Columbus to discover these extraordinary destinations.



THE « PONANT » SIGNATURE AT THE HEART OF LATIN AMERICA & THE CARIBBEAN

- **In Latin America:** 9 cruises travelling through 15 countries.
- **22 ports of call listed** as UNESCO World Heritage Sites.
- 8 major pre-Columbian era sites.
- For the **first time**, the **excursions are offered** on a selection of Latin America cruises.
- 5* Green Expeditions aboard ultra-modern ships, blend of elegance, luxury and cutting-edge technology.
- **In the Caribbean:** all of our cruises aboard *LE PONANT* have a **diving** theme, with an experienced diving instructor on board.
- Discovery of a number of unspoiled archipelagos which many of them are listed as UNESCO World Heritage Sites.
- "Cleanship" certified ships that are respectful of the environment in national parks, nature reserves and on coral islands.

Access the World's Treasures by Sea...





YOUR CRUISES IN LATIN AMERICA

DATE	SHIP	ITINERARY	NIGHTS		PAGE
Oct. 16 th 2016	LE BORÉAL	COLON • CALLAO	COMPLIMENTARY EXCURSIONS	9	PANAMA & PRE-COLUMBIAN TREASURESp14
Oct. 25 th 2016	LE BORÉAL	CALLAO • VALPARAISO		8	ALONG THE ANDES CORDILLERA.....p16
Nov. 02 nd 2016	LE BORÉAL	VALPARAISO • USHUAIA	COMPLIMENTARY EXCURSIONS	13	CHILEAN FJORDS & PATAGONIA.....p18
Oct. 29 th 2016	LE SOLÉAL	PUNTA ARENAS • USHUAIA		11	CAPE HORN & THE STRAIT OF MAGELLANp20
Mar. 05 th 2017	LE BORÉAL	USHUAIA • VALPARAISO	COMPLIMENTARY EXCURSIONS	13	CHILEAN FJORDS & PATAGONIA.....p18
Mar. 18 th 2017	LE BORÉAL	VALPARAISO • GUAYAQUIL		12	CORDILLERA & ANDEAN SECRETS.....p22
Mar. 30 th 2017	LE BORÉAL	GUAYAQUIL • COLON	COMPLIMENTARY EXCURSIONS	13	TREASURES OF CENTRAL AMERICA.....p24
Mar. 08 th 2017	LE SOLÉAL	MONTEVIDEO • RECIFE		9	AT THE HEART OF BRAZILp26
Mar. 17 th 2017	LE SOLÉAL	RECIFE • LISBON		16	FROM BRAZIL TO THE PORTUGUESE COASTp28



YOUR CRUISES IN THE CARIBBEAN

DATE	SHIP	ITINERARY	NIGHTS	PAGE
Dec. 17 th 2016	LE PONANT	SAINT MARTIN • FORT DE FRANCE	9	CHRISTMAS IN THE CARIBBEANp38
Dec. 26 th 2016	LE PONANT	FORT DE FRANCE • FORT DE FRANCE	8	NEW YEAR IN THE GRENADINESp40
Jan. 31 st 2017	LE PONANT	FORT DE FRANCE • FORT DE FRANCE	7	SECRETS OF THE GRENADINESp42
Feb. 07 th 2017	LE PONANT	FORT DE FRANCE • SAINT MARTIN	7	SECRETS OF THE GRENADINESp42
April 12 th 2017	LE BORÉAL	COLON • FORT DE FRANCE	7	BETWEEN PANAMA & MARTINIQUEp44

CHRISTMAS
CRUISE

NEW YEAR'S
CRUISE

COMPLIMENTARY
EXCURSIONS





LATIN AMERICA, the Land of Gold.

"El Dorado !", it is with these impassioned words that the first conquistadors described the strange country that Christopher Columbus had just discovered in 1498. Because Marco Polo had also talked about *"cities of gold"*, the Spanish and Portuguese conquerors mixed up South America and the Far East, and set out to look for these mythical riches and ancient civilizations.

It is almost impossible to paint a portrait of this continent overflowing with a thousand and one riches! If the names Magellan, Cortes or Velazquez have fired your imagination in the past, then our cruise-tours are made for you.

First, discover the Panama Canal and its legendary isthmus, before setting off to the heart of Venezuela and Ecuador, a rare destination offering an exceptional palette of landscapes, ecosystems and cultures for such a small country. Farther South, between the vast wild expanses of Patagonia, the slender silhouettes of the Chilean fjords, and the vestiges of the ancient temples of pre-Columbian civilizations, Peru, Chile and Argentina will constantly surprise you.

During this journey on our cruise ship, sail in the wake of great adventurers and discover an unspoiled America that is extreme by nature, and where the past seems to have left an indelible mark.



WHY LATIN AMERICA?



FOR THE DISCOVERY OF ITS CULTURAL HERITAGE

To better meet customer expectations and allow you to discover the most emblematic sites of Latin America, for the first time, PONANT has selected a series of cruises where **a selection of excursions are free of charge**. From the colonial riches of Lima (Peru) to the archaeological site of the Chimu culture (Salaverry – Peru), from the Santa Catalina Convent (Matarani - Peru) to the Manuel Antonio Park (Quepos – Costa Rica) via Cartagena (Colombia), as well as Forte Amador (Panama) to meet the Emberas Indians, we invite you to discover the treasures of this distant continent at your ease, enjoying its wild open spaces and its many UNESCO World Heritage monuments.



FOR ITS EXCEPTIONAL WILDLIFE

A land of lush vegetation and wide open spaces, Latin America boasts an exceptional ecosystem which promises frequent encounters with animal species, many of which are endemic. In the North, these include the capuchin monkeys, sloths and sea turtles that have taken up residence in the national parks and the islands. Farther to the South, between the Chilean fjords and the immense glaciers, you will encounter Magellanic penguins, sea otters and fur seals, unless you would rather discover the elegant macaws with multicolored feathers.



FOR ITS NATURE AND SHEER GRANDEUR

A cruise in Latin America offers infinite possibilities and invites travelers to admire vast expanses, fascinating landscapes and extreme wilds. While Chile reveals its long and slender silhouette dominated by the majestic Andes Mountain Range, 60% of Peru's landscapes are composed of forest, lakes and rivers. Farther on, Brazil is a mosaic of colors, of arid plateaux and long immaculate beaches, whereas Ecuador offers an exceptional palette of ecosystems. Lastly, Argentina reveals a maze of fjords and channels, snow-capped peaks, the vast pampas of Patagonia and stunning Andean landscapes.



FOR ITS MANY MAJOR SITES

Home to extremely rich civilizations, Latin America still boasts a significant legacy throughout the continent. For the cultural heritage and major sites specially designed to show you the must-see sites of more than ten different countries, our cruise tours and our land-based programs offer you a veritable concentration of history and cultures, showcasing many of the magnificent UNESCO-listed sites in the region. Machu Picchu, Torres del Paine National Park, and the pyramids of Tikal, without forgetting the colonial charm of towns such as Antigua de Guatemala, Salvador de Bahia, Cartagena, Cusco and Lima, sail to the very heart of history, to the time of the first Conquistadors.

FOR THE NATURAL BEAUTY OF THE GALÁPAGOS

From Guayaquil, before embarking or after your cruise, we invite you to take advantage of a "hotel package" to discover the Galápagos Islands – an earthly paradise with a fauna and flora you will not find anywhere else. Your visit will begin on Santa Cruz Island with the Charles Darwin Research Station. There, you will be able to observe the famous Galápagos giant tortoises, which provide evidence of the species' evolution. The next two days will be spent discovering the surrounding islands*. Colonies of eared seals, sea lions, and land iguanas have taken up residence here. On Seymour Island, a path will lead you to see the blue-footed boobies and colonies of frigate birds.

* The Galápagos National Park authorities determine which sites may be visited. These are therefore subject to change without notice. Access to the islands of Santa Fe and Seymour are not guaranteed. Should the destinations be modified, the authorities will arrange access to other islands in the archipelago near Santa Cruz.



PANAMA & PRE-COLUMBIAN TREASURES

Set sail aboard LE BORÉAL and enjoy a unique experience: crossing the famous Panama Canal. Before the jagged coastline of Ecuador reveals its magnificent beaches, succumb to the charms of the wild islands in the Gulf of Panama. Your glorious cruise will end in Peru, the legendary land of the Incas.



PANAMA CANAL

Aboard *LE BORÉAL*, experience something unique, something that has inspired the imagination of numerous adventurers in the 20th century: the crossing of the Panama Canal. Construction of the canal started in 1880 under the direction of Ferdinand de Lesseps. It was abandoned then resumed, and this marvel of engineering was completed by the United States in 1887 and opened in 1914. The canal crosses the Isthmus of Panama and links the Atlantic Ocean to the Pacific Ocean. It includes three levels of locks and by raising ships to the level of Lake Gatun, almost as if the water was a lift, it allows them to avoid having to round Cape Horn. From the Miraflores Locks, you will have an unobstructed view of both any port operations underway and the extraordinary surrounding landscapes.



MOGO MOGO, THE PEARL ISLANDS

On our way to Ecuador, *LE BORÉAL* will stop in the Pearl Islands, which nestle in the Gulf of Panama. These precious islands earned their name in the 16th century when the Spanish Conquistadors discovered the many pearl oysters there – the wealth of the indigenous Indians who lived on the islands at the time. It is within this archipelago composed of over 200 islands that the "La Peregrina" pearl was discovered. It is renowned for its perfection and although most recently it belonged to Elizabeth Taylor, several kings and queens of Europe had owned it in the past. At the heart of this paradise, discover Mogo Mogo, a secret desert island whose turquoise waters are home to exceptional sea life.



COMPLIMENTARY
EXCURSIONS
(see p30)

COLON • CALLAO

Aboard LE BORÉAL

From October 16th to 25th 2016 (9 nights)

From 2 460 €

See price list page 56.

HIGHLIGHTS

- **UNESCO sites:** the fortifications along the Caribbean coast from Panama to Portobelo; the Chan Chan archeological site from Salaverry; the historic center of Lima. From Guayaquil, discover Quito, the Ecuador capital and the architectural heritage of Cuenca, in post cruise, the Historic Sanctuary of Machu Picchu.
- The opportunity to sail from one ocean to another by crossing the mythical Panama Canal.
- Lima and its exceptional architectural heritage from colonial times.
- Lecturer chosen for his/her area of expertise.

UNESCO

GUAYAQUIL

It is at the heart of dazzling Ecuador, with its rich biodiversity, that Santiago de Guayaquil was founded in 1535 by Spanish settlers on ancient Indian lands. Poetically nicknamed "the Pearl of the Pacific", this astonishing town is the gateway to a number of treasures, including some of the most beautiful of all of Latin America. We invite you to take to the air to discover Quito, the capital of Ecuador, a UNESCO World Heritage Site founded on the ruins of a former Inca city, at some 2850 metres altitude. Unless you would rather fly over Cuenca, a little town suspended in time, with its countless paved streets and architecture dating from the 16th and 17th Centuries.



UNESCO

SALAVERRY - TRUJILLO & CHAN CHAN

The Peruvian port of Salaverry will be your gateway to the superb coastal region of La Libertad, which has Trujillo as its capital. Surrounded by powerful walls to protect it from the onslaught of pirates who were still numerous at the time, Trujillo has managed to maintain its charm with its colonial mansions, its Iturregui Palace and its Plaza de Armas. Do not miss your chance to discover the Temple of the Dragon and the former capital of the Chimú Empire, known as Chan Chan. Built in 1300, this is the largest pre-Columbian city in the Americas. At the height of its splendor, it was home to vast quantities of gold, silver and precious potteries and it is today a UNESCO World Heritage Site.



COLON • CALLAO

LE BORÉAL - From October 16th to 25th 2016
10 days / 9 nights



DAY	ITINERARY
Oct 16 th	Colon (Panama) Embarkation from 16.00 to 17.00
Oct 17 th	Portobelo (Panama) Crossing the Panama Canal*
Oct 18 th	Mogo Mogo (Pearl archipelago) (Panama)
Oct 19 th	At sea
Oct 20 th	At sea
Oct 21 st	♥ Guayaquil (Ecuador)
Oct 22 nd	At sea
Oct 23 rd	Salaverry (Peru)
Oct 24 th	Callao (Peru)
Oct 25 th	Callao (Peru). Disembarkation.

* The schedules depend on several factors and despite our best efforts, crossing the Panama Canal during the day is not guaranteed.

♥ **OVERLANDS:** Quito or Cuenca from Guayaquil.
See page 31.



ALONG THE ANDES CORDILLERA

Aboard *LE BORÉAL*, set off to discover the Pacific coast of South America by visiting Peru, the ancient land of the Incas. Farther South, Chile will surprise you with its diverse, contrasting landscapes. The "pais longilíneo", as Pablo Neruda used to call it, is a strip of land wedged between the Ocean and the Andes mountain range.



UNESCO

CALLAO - LIMA

Lima, Peru's capital and largest city, founded in 1535 by the Spanish Conquistador Francisco Pizarro and named "The City of Kings" at the time, stands proudly facing the Pacific Ocean. Colonial Lima, a UNESCO World Heritage Site, has a magnificent historical center which testifies to its prestigious past. A wonderful showcase of colonial architecture, its center is also nicknamed "Damero de Pizarro" (Pizarro's chessboard) because its streets are laid out like a game of chess. The main sights are to be found in the heart of the city: the majestic cathedral with its adjoining chapel and two bell towers dominates the unmissable Plaza De Armas, and the Governor's palace. The Gold museum, National museum of Archaeology and the private collections of pre-Columbian Art will offer you the best introductions to the Peruvian capital.

UNESCO

IQUIQUE

The town has an exceptional historical center, legacy of the wealth generated during the "white gold rush", where sodium nitrate and saltpeter were at the origins of its success. Arturo Prat Square, where you will find the famous Neoclassical-style municipal theatre and the clock tower, a true symbol of the city. Near Iquique lies Humberstone, a former mining town, today transformed into a museum and listed by UNESCO as a World Heritage Site. A little further on, the region of Pintados will open its doors to you and reveal its superb and mysterious geoglyphs, one of the most important collections of this ancient ancestral art in the world.



COMPLIMENTARY
EXCURSIONS
(see p30)

CALLAO • VALPARAISO

Aboard *LE BORÉAL*

From Oct. 25th to Nov. 02nd 2016 (8 nights)

From 1 980 €

See price list page 56.

HIGHLIGHTS

- **UNESCO sites:** historic center of Lima, Arequipa and Valparaíso. The Santa Catalina Monastery from Matarani, the Nazca Lines and geoglyphs from our port of call, Pisco.
- An optional visit to the Historic Sanctuary of Machu Picchu and the Humberstone and Santa Laura Saltpeter Works from Iquique is available.
- Presence of experienced lecturers, chosen for their expertise.



MATARANI - AREQUIPA

When we drop anchor in Matarani, discover Arequipa, an old colonial city whose many white buildings have earned it the nickname "white city". With their rich heritage of myths and legends, the Arequipenos say, rather poetically, that the moon forgot to take their town when it was separated from the earth! Do not miss the famous Santa Catalina Monastery, one of Peru's undisputed gems, listed as a UNESCO World Heritage Site. You will travel back in time as you wander through the vast maze of pastel-colored patios decked with flowers and stroll along sinuous roads with Andalusian names. The souls of the most illustrious Carmelites still reside here and their names, written in a palette of yellow and brown ochers, still decorate the pediments of their former dwellings. A photographer's paradise, this architectural masterpiece is home to some of the finest examples of Hispano-American religious art.



COQUIMBO: THE ELQUI VALLEY

Far from the usual tourist circuits in Chile, set off to discover the Elqui Valley, a mountainous wine-making region that is still little known to the general public. Deep in the heart of the Andean mountain chain, the contrast between the arid slopes, the green agricultural plantations and the blue of the sky is remarkable. The abundant production of grapes is undoubtedly the reason behind the creation of the "Pisco", Chile's national drink. During *LE BORÉAL*'s stop here, we invite you to discover the small town of Vicuña, famous due to the Chilean poet Gabriela Mistral, but also because it is the gateway to the Pisco route.

CALLAO • VALPARAISO

LE BORÉAL - From Oct. 25th to Nov. 02nd 2016
9 days / 8 nights



DAY	ITINERARY
Oct 25 th	Callao (Peru) Embarkation from 16.30 to 17.30
Oct 26 th	♥ Pisco (Peru)
Oct 27 th	<i>At sea</i>
Oct 28 th	Matarani (Peru)
Oct 29 th	Arica (Chile)
Oct 30 th	Iquique (Chile)
Oct 31 st	<i>At sea</i>
Nov 01 st	Coquimbo (Chile)
Nov 02 nd	Valparaíso (Chile). Disembarkation.

♥ **OVERLAND:** Nazca Lines from Pisco. See page 31.



CHILEAN FJORDS & PATAGONIA

Aboard *LE BORÉAL*, discover the Chilean fjords and Patagonia, where earth and sea mingle to form a labyrinth of islands, fjords, lakes and mountains. Not to mention the colorful, colonial-style towns brimming with history and the nature reserves, home to an impressive fauna and flora. As a grand finale, we will be rounding the mythical Cape Horn.



UNESCO

CAPE HORN & CHILEAN FJORDS

Discover the crucial passage sailors call “the Horn”. This legendary cliff, which stands some 425 m tall, commands the respect of even the most experienced sailors. After rounding Cape Horn, you will have a unique opportunity to sail along the Chilean Channels, at the foot of the mountains of the Cordillera Darwin. Here, *LE BORÉAL* glides to the heart of the islands, archipelagos and winding fjords where majestic glaciers seem to become one with the Ocean. In this glorious sea scattered with islands, this faraway land enchants us with its beauty and vigorous nature, and above all its icy and unspoiled glaciers that have been transforming and reshaping the landscapes for centuries.



PUERTO MONTT

LE BORÉAL will lead you to Puerto Montt, capital of the lake district, a natural garden where the beauty of the landscapes will enchant the painter that slumbers inside you. In this entrancing landscape, the villa and its bay appear before your gaze. Further on, on the fringe of the Reloncavi Sound, opening onto neighboring Patagonia, you will find the greatest concentration of volcanic cones, such as the spectacular and famous Osorno volcano with its snow-topped peaks. The region is rich in treasures, such as the remarkable spectacle of the Petrohue Falls with their turbulent waters which have carved out the basalt over time and allowed lake Todos Los Santos to form.



VALPARAISO • USHUAIA Aboard *LE BORÉAL*

From November 02nd to 15th 2016 (13 nights)

From 4 230 €

See price list page 56.



USHUAIA • VALPARAISO Aboard *LE BORÉAL*

From March 05th to 18th 2017 (13 nights)

From 4 390 €

See price list page 56.



HIGHLIGHTS

- **UNESCO sites:** Torres del Paine National Park from Puerto Natales. Valparaiso's historic quarter. The Churches of Castro on Chiloe Island. The Cape Horn Biosphere Reserve.
- Rounding the mythical Cape Horn and sailing to the heart of the Chilean channels.
- **Wildlife:** condors, humpback whales, fur seals, dolphins, sea lions, alpacas, Magellanic penguins and cormorants.
- **Natural environments:** the snow-capped peaks of the Andes towering above fjords, iridescent glaciers, and mountain lakes with crystal-clear water.
- A team of specialized naturalist-guides.

CHILOE ISLAND - CASTRO

At the heart of the lake district, just a stone's throw from Puerto Montt, *LE BORÉAL* will slip through the calm waters of an archipelago of 40 islands, scattered off the coast of Chile. Chiloe is a lush green island with remarkable architecture and a proliferation of wildlife. Indeed, before reaching Castro, it is highly likely that you will have witnessed a truly authentic aquatic ballet, where seals and porpoises accompany travelers on their journey, swimming nose-to-nose with our ship. The island boasts some 150 churches and the capital, Castro, is home to 16 that are listed as UNESCO World Heritage Sites. But this city has plenty of other charms, including its colorful craft market or its brightly painted wooden cathedral.



TORTEL

Tortel is a little Patagonian village at the end of the world clinging to a hillside, and is unique for both its unrivalled architecture and its geographical location. Isolated at the end of the Gulf of Penas between fjords, glaciers, lakes, forests and mountains, Tortel can be found at the mouth of one of the most beautiful rivers in Chile: the Baker River. Its unique architecture, consisting of houses on stilts, bridges which invite you to stroll around and interminable staircases, form a village that is unique in the world, where the "streets" follow the coastline. The dense surrounding forest is home to an abundant and varied wildlife and from there, you should be able to observe hummingbirds gathering nectar from the many colorful flowers in the region.



VALPARAISO • USHUAIA

LE BORÉAL - From Nov. 02nd to 15th 2016
14 days / 13 nights



DAY	ITINERARY
Nov 02 nd	Valparaíso (Chile) Embarkation from 15.00 to 16.00
Nov 03 rd	At sea
Nov 04 th	Castro - Chiloe (Chile)
Nov 05 th	Puerto Montt (Chile)
Nov 06 th	At sea
Nov 07 th	Tortel (Chile)
Nov 08 th -10 th	Crusing in the heart of the Chilean Fjords
Nov 11 th	Puerto Natales (Chile)
Nov 12 th -14 th	Sailing around Cape Horn and Beagle Channel
Nov 15 th	Ushuaia (Argentina) . Disembarkation. Transfer to the airport. Flight Ushuaia/Buenos Aires . Arrival at the International airport of Buenos Aires (Pistarini).



USHUAIA • VALPARAISO

LE BORÉAL - From March 05th to 18th 2017
14 days / 13 nights



DAY	ITINERARY
March 05 th	Flight Buenos Aires/Ushuaia (Argentina) Direct transfer on board OR Transfer to Arakur Resort, located inside Cerro Alarcon natural Reserve. Time at leisure, lunch and / or additional paying excursion to Tierra del Fuego National Park . Embarkation from 19.00 to 20.00
March 06 th -08 th	Sailing around Cape Horn and Beagle Channel
March 09 th	Puerto Natales (Chile)
March 10 th -11 th	Crusing in the heart of the Chilean Fjords
March 12 th	Tortel (Chile)
March 13 th	At sea
March 14 th	Puerto Montt (Chile)
March 15 th	Castro - Chiloe (Chile)
March 16 th	At sea
March 17 th	Valparaíso (Chile)
March 18 th	Valparaíso (Chile) . Disembarkation.



CAPE HORN & THE STRAIT OF MAGELLAN

Sail aboard LE SOLÉAL in the wake of the great explorers of old to the gateway of two Oceans: the Atlantic and the Pacific. Cruise through the Strait of Magellan, which separates Tierra del Fuego from South America, and round the mythical Cape Horn. Continue your cruise by discovering the Falkland Islands, great South Atlantic archipelago.



THE STRAIT OF MAGELLAN

This mythical strait situated in the South of Chile and separating South America from Tierra del Fuego, awakens our imagination, stirring up a longing for adventure. For the first time, follow in the footsteps of the famous Portuguese explorer Ferdinand Magellan, known for having organized the first circumnavigation of the globe in the 16th century. Aboard *LE SOLÉAL*, cruise along the 600 km separating the Atlantic Ocean from the Pacific and, before arriving in Ushuaia, discover the sea route which was long nicknamed "Strait of All Saints" because Magellan's ships first entered it on All Saints' Day. A fascinating adventure.



THE FALKLAND ISLANDS

Located at the South East of South America, the Falkland Islands, which are renowned for their wildness, were discovered by a Spanish expedition at the beginning of the 16th century. More than two hundred years later, sailors from Saint-Malo occupied the island and gave it the name used until the British conquered them. Scattered with tufts of grass, surrounded by a grey and often wild sea, the Islands are a small country of moors and rugged coastlines carved by the South Atlantic, where the wildlife and plant life form a link between Patagonia and Antarctica. Take the time to observe and photograph the abundant wildlife of these wild and very attractive Islands.



PUNTA ARENAS • USHUAIA

Aboard LE SOLÉAL

From Oct. 29th to Nov. 09th 2016 (11 nights)



From 3 870 €

See price list page 56.

HIGHLIGHTS

- **UNESCO sites:** The Cape Horn Biosphere Reserve.
- Sailing into the heart of the Strait of Magellan aboard *LE SOLÉAL*.
- Discovering of Ushuaia, a city at the end of the world.
- Wildlife: Magellanic penguins, crested penguins, eared seals, orcas, dolphins, cormorants, albatrosses, seagulls, and more.
- Outings in Zodiac® dinghies.
- Naturalis-guides chosen for their expertise.

ZODIAC® EXCURSIONS - CAPE HORN

"We climb aboard the Zodiac® dinghies to sail to the historic rock of Cape Horn. We set foot in a little inlet surrounded by a submerged forest of giant kelp; the beach is made up of large pebbles. Here we take a wooden staircase, bleached by the sea spray, which scales a steep hillside covered with dense green vegetation. In the heights of the island, the wooden footbridge runs through prairie until it reaches an imposing metal monument, evoking the slender statue of an albatross in flight, a sight we have seen and admired so many times during our journey. This site gives off a solemn atmosphere; the result of a land that is intensely wild impregnated with the redoubtable strength of the angry Ocean."

Nicolas Tolstoï - Naturalist on board

(This call depends on the weather conditions).



USHUAIA

At the end of your cruise, discover the world's southernmost city: Ushuaia, capital of Tierra del Fuego. Located at the end of Beagle Bay and nicknamed "El fin del mundo" by the Argentinian people, this city at the end of the world nestles in the shelter of mountains surrounded by fertile plains that the wildlife seem to have chosen as the ultimate sanctuary. According to legend, the first inhabitants here were nomadic hunters and gatherers who arrived on foot to the Isla Grande over 10,000 years ago. With its exceptional site, where the Andes plunge straight into the sea, Ushuaia, a fascinating place, its very name evocative of journeys to the unlikely and the inaccessible.



PUNTA ARENAS • USHUAIA

LE SOLÉAL - From Oct. 29th to Nov. 09th 2016

12 days / 11 nights



DAY	ITINERARY
Oct 29 th	Flight Santiago/Punta Arenas (Chile), Panoramic tour and transfer to the port. Embarkation from 16.00 to 17.00
Oct 30 th	Sailing Gabriel Canal
Oct 31 st	Sailing around Magdalena Island Crossing Magellan Strait
Nov 01 st	At sea
Nov 02 nd	New Island (Falkland Islands) Grave Cove (Falkland Islands)
Nov 03 rd	Steeple Jason Island (Falkland Islands) Saunders Island (Falkland Islands)
Nov 04 th	Volunteer Point (Falkland Islands) Kidney Island (Falkland Islands)
Nov 05 th	Bleaker Island (Falkland Islands)
Nov 06 th	At sea
Nov 07 th	Cape Horn (Chile)
Nov 08 th	Sailing up Beagle strait
Nov 09 th	Ushuaia (Argentina). Disembarkation. Transfer to the airport. Flight Ushuaia/Buenos Aires . Arrival at the international airport of Buenos Aires (Pistarini).



CORDILLERA & ANDEAN SECRETS

Aboard *LE BORÉAL*, sail along the coast of Chile, a long strip of land with still unspoiled regions, at the foot of the Andean peaks. Then, once we head North, Peru will reveal to you its magnificent nature punctuated with forgotten treasures. Discover the enigmatic charm of the ancient Inca Empire, whose slumbering citadels are each more stunning than the next.



UNESCO

VALPARAISO

You will be aboard *LE BORÉAL* when you catch your first glimpse of Valparaíso, located 115 km to the West of Santiago de Chile. Considered to be one of the most picturesque sites in the central region of Chile, this “Valley of Paradise”, whose city center is listed as a UNESCO World Heritage Site, deploys all its charm to seduce lovers of urban poetry. Immortalized in the works of Pablo Neruda, Valparaíso is today one of the most charismatic and historic ports of South America, dominated by the cable cars that connected the hillsides and the picturesque houses, a veritable rainbow of colors. The 45 hills that surround the bay form a maze to be explored on foot.



ARICA

The “City of Eternal Spring” where a temperate and sunny climate reigns all year round, Arica is very popular for its beautiful beaches and its rich historical sites. On the border between Peru and Chile, the city was the theatre for one of the most famous episodes of the War of the Pacific: the capture of the Morro de Arica in 1880. It was at this time that Chile took possession of this paradise, where the magic of the Andes and the Pacific combine to make this port town an unmissable destination. During *LE BORÉAL*’s stop here, do not miss to discover this surprising city which was occupied by Inca people... The Cathedral and the former customs house, both designed by Gustave Eiffel, give the city a certain French “je ne sais quoi”.



COMPLIMENTARY
EXCURSIONS
(see p30)

VALPARAISO • GUAYAQUIL

Aboard *LE BORÉAL*

From March 18th to 30th 2017 (12 nights)

From 2 980 €

See price list page 56.

HIGHLIGHTS

- **UNESCO sites:** the historic centers of Lima and Arequipa from Matarani and Callao. Nazca Lines from Pisco. The Machu Picchu historical sanctuary from Callao. Salpeter works of Humberstone and Santa Laura from Iquique.
- Exceptional architectural heritage from colonial times.
- Major pre-Columbian sites.
- Passionate and specialized lecturers on board.

♥ PISCO: THE NAZCA LINES

LE BORÉAL will call at Pisco and offer you the possibility to take a flight over the enigmatic and mysterious Nazca Lines, geometric tracteries of gigantic size. The 450 km² of archaeological enigmas will surprise you with their size, content and sheer quantity and remain the World's greatest enigma. The drawings can represent living creatures such as lizards, monkeys, spiders and whales as well as geometric figures, and were discovered in 1926. The rays of the setting sun coincide with the direction of the drawings of the animals! But questions remain: why is it impossible to see them from the ground, for whom were they drawn and how? Many scientists have puzzled over this and, to date, no truly satisfactory answer has been found.



♥ CALLAO: MACHU PICCHU

From Lima, the capital of Peru, do not miss the ancient city of Cusco, discovered in 1533 by the Conquistadors. There, visit the archeological site of Sacsaywaman, an imposing fortress overlooking the Sacred Valley. Then climb to an altitude of more than 2,430 meters towards the famous site of Machu Picchu, listed as a UNESCO World Heritage Site since 1983. This fascinating place nicknamed "The Lost City of the Incas" nestles high up in the Andes and seems to reach for the sky. This marvel of architecture is an essential relic of the Inca Empire and remains an enigma for archeologists. A sacred city for centuries, Machu Picchu is now one of the most famous sites in South America.



VALPARAISO • GUAYAQUIL

LE BORÉAL - From March 18th to 30th 2017
13 days / 12 nights



DAY	ITINERARY
March 18 th	Valparaíso (Chile) Embarkation from 17.00 to 18.00
March 19 th	Coquimbo (Chile)
March 20 th	At sea
March 21 st	Iquique (Chile)
March 22 nd	Arica (Chile)
March 23 rd	Matarani (Peru)
March 24 th	At sea
March 25 th	♥ Pisco (Peru)
March 26 th	♥ Callao (Peru)
March 27 th	Callao (Peru)
March 28 th	Salaverry (Peru)
March 29 th	At sea
March 30 th	Guayaquil (Ecuador) . Disembarkation.

♥ **OVERLANDS:** Nazca Lines from Pisco & the Machu Picchu from Callao. See page 31.



TREASURES OF CENTRAL AMERICA

Ecuador, Costa Rica, Guatemala, Nicaragua, Panama... from one port of call to the next, LE BORÉAL invites you to discover a rich selection of architectural gems and the most stunning natural treasures. Your cruise will take you to the doorstep of this region where you will experience the captivating charm of magnificent landscapes and UNESCO World Heritage Sites.



GUAYAQUIL • COLON

Aboard LE BORÉAL

From March 30th to April 12th 2017 (13 nights)

From 3 560 €

See price list page 56.

COMPLIMENTARY
EXCURSIONS
(see p30)

HIGHLIGHTS

- **UNESCO sites:** Pyramids of Tikal and Antigua de Guatemala, considered to be one of the most beautiful cities in the city, from Puerto Quetzal.
- Extension during your cruise: The Tikal pyramids from Puerto Quetzal.
- Discovering Manuel Antonio National Park with its white sand beaches and lush vegetation.
- Exceptional encounter with the Embera people during the port of call of Fuerte Amador.
- Passionate and specialized lecturers on board.

QUEPOS - MANUEL ANTONIO NATIONAL PARK

LE BORÉAL will anchor off Quepos, from where you can visit the nearby Manuel Antonio National Park, a veritable jewel of greenery, the smallest in Costa Rica but undoubtedly the richest. This charming and unspoiled site, combining luxuriant tropical vegetation and strange-looking animals, such as the languorous sloth, the amazing squirrel monkey or the colorful iguana, is bordered by many beaches, some of the most beautiful in the country with their turquoise waters and marvelous coral reefs. Here, the footpaths overlooking the calm sea will lead you to spectacular viewpoints, such as the long strip of golden sand of the Punta cathedral and its remote beaches with their picture-postcard settings.



UNESCO

PUERTO QUETZAL LA ANTIGUA DE GUATEMALA

From Puerto Quetzal, discover "la Antigua de Guatemala", located at 1 500 m altitude and often considered to be one of the most beautiful cities in the country. Famous for its Spanish Baroque and Renaissance style of architecture, it lives to the rhythm of its colonial past. Of its prestigious past, the city has preserved its homes built around vast flower-bedecked courtyards, and its baroque churches. Its streets and avenues, paved with uneven cobblestones, are edged by single-storey houses painted in bright colors and decorated with wrought iron grills, blending the poetic atmosphere and gentle melancholy of the place. A UNESCO World Heritage Site, Antigua is dominated by the silhouettes of its majestic volcanoes and has a unique charm.



EMBERA INDIAN VILLAGE

As we leave Fuerte Amador, you will have an exceptional chance to journey back in time. We will take you to the heart of Central America, which just 600 years ago was only accessible to a privileged few, to discover the Embera Indian tribe. This proud people have successfully preserved their traditions and their ancestral way of life which pre-date the colonization of the region by the Spanish. By journeying towards the jungle of the central region, the history and customs of the Embera Indians, loyal guardians of the forest and the Chagres River, will hold no secrets for you. As soon as you arrive in Chagres National Park you will take a seat in a traditional dugout boat called piragua and travel upriver, admiring the diverse and abundant wildlife along the shores. Very quickly, you will notice the village emerging from the vegetation. The village chief will welcome you and you will be invited to watch traditional dances, to further enhance this cultural exchange. Experience the ancestral traditions of the Embera Indians.



UNESCO

♥ PUERTO QUETZAL: PYRAMIDS OF TIKAL

LE BORÉAL will lead you to the port of Puerto Quetzal, gateway to one of the major sites of Mayan civilization: the Pyramids of Tikal. The imposing vestiges of a vanished culture coupled with the mystery of the jungle make a real impression on the traveler. In this very dense jungle, the forest seems to emerge from the mist. Its ceremonial center includes superb examples of temples, palaces, steles and sacrificial alters; you will visit the most remarkable buildings such as the Temple of the Great Jaguar, the Temple of the Masks and the Great Plaza. From this structure, the highest altitude in pre-Columbian America, Mayan raised their eyes to the stars to study the movements. A magical moment combining culture and nature, the Tikal site will allow you to relive some original legends.



GUAYAQUIL • COLON

LE BORÉAL - From March 30th to April 12th 2017
14 days / 13 nights



DAY	ITINERARY
March 30 th	Guayaquil (Ecuador). Embarkation from 16.00 to 16.30
March 31 st	At sea
April 01 st	At sea
April 02 nd	Quepos (Costa Rica)
April 03 rd	At sea
April 04 th	♥ Puerto Quetzal (Guatemala)
April 05 th	At sea
April 06 th	San Juan del Sur (Nicaragua)
April 07 th	Herradura (Costa Rica)
April 08 th	Golfito (Costa Rica)
April 09 th	Coiba (Panama)
April 10 th	Fuerte Amador (Panama)
April 11 th	Crossing the Panama Canal*
April 12 th	Colon (Panama). Disembarkation.

* The schedules depend on several factors and despite our best efforts, crossing the Panama Canal during the day is not guaranteed.

♥ **OVERLAND:** Pyramids of Tikal from Puerto Quetzal.
See page 31.



AT THE HEART OF BRAZIL

Brazil offers a kaleidoscope of landscapes with its arid plateaux, immaculate beaches and sierras arranged around the vast Amazon basin, and it occupies a unique place within Latin America. Like the Portuguese conquistadores as they discovered the coasts of Brazil in the 16th century, we invite you to follow in the footsteps of these great explorers for a journey, a cruise aboard LE SOLÉAL.



MONTEVIDEO

Long beaches, sea lion colonies, vineyards, ranches and bars, a frenetic carnival Uruguay never ceases to amaze. You will begin your journey in Montevideo, the capital, a pleasant seaside resort of colonial charm on the banks of the River Plate. Founded by the Spanish in 1726, it is the youngest of the South American capitals and boasts a charming historic district with Spanish, Italian and Art Deco influences. Before embarking on your cruise, do not miss your chance to discover this fascinating city and its *Ciudad Vieja*, home to the vestiges of the city's old defensive wall and to contemporary 20th century architecture, listed as a UNESCO World Heritage Site.



BRAZIL, LAND OF COLOR

Baroque, historic, modern – Brazil is a land of contrasts and combinations. It has the feel of a continent, and has always fired the imagination of travelers. No other country brings together such a diversity of cultures, natural beauty and enchanting landscapes, including baroque towns and futuristic cities, deep forests and roaring cascades. One of the best ways to take the pulse of the country is undoubtedly to approach it from the sea, from where you will enjoy unforgettable views of the shoreline and the beaches lined with dazzling white churches as they appear on the horizon. Aboard *LE SOLÉAL*, we invite you to discover the major sites of the mosaic of colors that is Brazil.



MONTEVIDEO • RECIFE

Aboard LE SOLÉAL

From March 08th to 17th 2017 (9 nights)

From 1 520 €

See price list page 56.

HIGHLIGHTS

- **UNESCO sites:** contemporary 20th century architecture of Montevideo, the "Cristo Redentor" and the impressive Sugarloaf Mountain in Rio de Janeiro, the spectacular historical center in Salvador da Bahia.
- Long white-sand beaches.
- Exceptional discovery of Rio de Janeiro during two days.
- *LE SOLÉAL's* navigation, closer the Brazilian coast.
- Passionate and specialized lecturers on board.

RIO DE JANEIRO

Brazilians often say that *"God is an artist and Rio his masterpiece"*. *"The first brushstroke was blue: the sea. The green then ink sprang onto the canvas to be transformed into forests, and later came the mountains and water, cutting a path through the great valleys..."* When LE SOLÉAL drops anchor in Rio for two days, you will be able to discover the city that mingles urban madness, long fine-sand beaches, lush green hills, colonial architecture and ultra-modern buildings to form one of the cities in the world with the most contrasts. In its heart lies the Floresta da Tijuca. Known as the largest urban forest in Latin America, it completely surrounds the famous *"Cristo Redentor"*, which overlooks the city at an altitude of 700 m. Across from it, you will discover the other symbol of this city, the impressive Sugarloaf Mountain, solitary gatekeeper of the bay's entrance.



SALVADOR DE BAHIA

Feisty, fun, festive and warm – Salvador de Bahia is the veritable cradle of the country and colonial Brazil's most beautiful jewel, a city full of exoticism, charm and good humor. A joyful blend of cultures, it has a historical center that evokes Portugal and a mainly Afro-Brazilian population, which has earned it the beautiful nicknames of *"Bahia the Black"*, or *"Black Rome"*. Here, the historical center, a UNESCO World Heritage site, is transformed at night by the furious sounds and rhythms of the bands of Batucadas, whilst the architectural backdrop captures the attention. Brightly colored houses, baroque churches and paved streets with the charm of yesteryear are the characteristics of the undeniably attractive old town.



MONTEVIDEO • RECIFE

LE SOLÉAL - From March 08th to 17th 2017
10 days / 9 nights



DAY	ITINERARY
March 08 th	Montevideo (Uruguay) Embarkation from 16.00 to 16.30
March 09 th	At sea
March 10 th	At sea
March 11 th	Rio de Janeiro (Brazil)
March 12 th	Rio de Janeiro (Brazil)
March 13 th	At sea
March 14 th	At sea
March 15 th	Salvador de Bahia (Brazil)
March 16 th	At sea
March 17 th	Recife (Brazil). Disembarkation.



FROM BRAZIL TO THE PORTUGUESE COAST

Take a multifaceted trip aboard *LE SOLÉAL*, for a transatlantic experience that will take you from Brazil to the gates of Europe, via the islands off Africa's Atlantic coast. This cruise will expose you to contrasts and mixed influences in Recife, Brazil's oldest city, but also as we sail through the Cape Verde archipelago and the Canary Islands.



UNESCO

FERNANDO DE NORONHA

"Paradise on earth", "One of Brazil's treasures"... these are some of the terms often used to describe Fernando de Noronha, a small island chain located off the East coast of Brazil. And yet, when *LE SOLÉAL* drops anchor in the bay opposite a white sandy beach, in a sea of a deep aqua blue, you will see that it is impossible to adequately describe its beauty. A National Park and a UNESCO World Heritage Site, Fernando de Noronha is also a sanctuary for pelicans, parrots and thousands of migratory birds, as well as a breathtaking marine life that lives among the coral reefs.



THE CANARY ISLANDS

Fine sandy beaches, craters and alpine forests, lava fields and deserts: the 7 islands of "eternal spring" do not resemble one and another, yet they are well and truly part of the same archipelago: the Canary Islands. Closer to Africa than to Spain, this surprising microcosm is located in the heart of the Atlantic Ocean, North of the Tropic of Cancer, and is home to Spain's most beautiful landscapes. During your cruise aboard *LE SOLÉAL*, we offer you the chance to discover the archipelago's largest island, Tenerife, dominated by a volcanic cone and opening onto the sea. Its charming capital invites you to stroll along its pedestrian streets, which cleverly combine ultra-modernism and the charm of authenticity. Las Palmas de Gran Canaria boasts impressive and surprising landscapes including black sand beaches and unspoiled natural environments, right down to the deep ravines created by the island's volcanic activity.



RECIFE • LISBON

Aboard *LE SOLÉAL*

From March 17th to April 02nd 2017 (16 nights)

From 3 120 €

See price list page 56.

HIGHLIGHTS

- **UNESCO sites:** The Fernando de Noronha nature reserve. Cidade Velha in the Cape Verde islands (Praia). The La Laguna city center in Tenerife. The Vegueta District in Las Palmas. The Jeronimos Monastery and the Belém Tower in Lisbon.
- An exceptional transatlantic journey from South America to Europe.
- The Cape Verde archipelago and its unique melting pot.
- Passionate and specialized lecturers on board.

LISBON

Lisbon, built on seven hills overlooking the Tagus estuary, was the departure point for great sea expeditions during the Age of Discovery. The city is home to many architectural treasures reflecting this prosperous period, including the Alfama and the Bairro Alto. Standing at the entrance to Lisbon harbor, the Jeronimos Monastery, a masterpiece of Manuelian art, reflect the many cultures that shaped this city and its prestigious past. The nearby Tower of Belém, built to commemorate Vasco da Gama's expedition, is a reminder of the great maritime discoveries that laid the foundations of the modern world. But Lisbon is also synonymous with Azulejos, the famous tiles that color the city in a harmony of blues, and Fado, the traditional Portuguese singing style which provides evening entertainment here.



CAPE VERDE ISLANDS

At the crossroads of three continents, Europe, Africa and South America, the Cape Verde islands are proud of their mixed race heritage, a blend of cultures that makes them truly unique. Far from the main maritime routes and major tourist destinations, Cape Verde offers its authenticity and its traditions, a region with a thousand faces and a thousand landscapes. Once we have dropped anchor in Santiago, Cape Verde's most African island, set off to discover its winding valleys and steep mountains. From the Royal Fort of São Filipe, you will have breathtaking views over Cape Verde's former capital, Cidade Velha, a UNESCO World Heritage Site. As the first colonial town built in the tropics by the Europeans, it was the birthplace of one of the first accomplished culturally mixed Creole societies.

RECIFE • LISBON

IE SOLÉAL - From March 17th to April 02nd 2017
17 days / 16 nights



DAY	ITINERARY
March 17 th	Recife (Brazil) Embarkation from 16.00 to 17.00
March 18 th	<i>At sea</i>
March 19 th	Fernando de Noronha (Brazil)
March 20 th -23 rd	<i>At sea</i>
March 24 th	Praia (Cape Verde)
March 25 th	Sao Vicente (Cape Verde)
March 26 th	<i>At sea</i>
March 27 th	<i>At sea</i>
March 28 th	Las Palmas (Canary Islands - Spain)
March 29 th	Tenerife (Canary Islands - Spain)
March 30 th	Funchal (Madeira - Portugal)
March 31 st	Porto Santo (Madeira - Portugal)
March 01 st	<i>At sea</i>
March 02 nd	Lisbon (Portugal). Disembarkation.



SHORE EXCURSIONS HIGHLIGHTS

PONANT offers you a choice of free excursions, designed to allow you to discover the treasures of Latin America. For more information, please consult www.ponant.com or call our Travel Advisor.

YOUR COMPLIMENTARY EXCURSIONS*

PORT	COUNTRY	YOUR SHORE EXCURSIONS
ARICA	CHILI	Discover geoglyphs - gigantic stone drawings representing animals, human figures and geometric shapes. Visit the San Miguel de Azapa archaeology and anthropology museum, containing elements of anthropological and cultural heritage that are some 10,000 years old.
CALLAO	PERU	Discover the vestiges of the colonial period in Lima, with the cathedral, the main square and the San Francisco convent. Visit the Gold museum and stroll around the Indian market, with its thousand and one colours.
FUERTE AMADOR	PANAMA	Enjoy a unique encounter with the Embera Indians in the heart of Central America, and its exceptional wildlife.
IQUIQUE	CHILI	Visit the city of Iquique, with its unique architecture, or visit the former saltpeter mining towns of Santa Laura and Humberstone, also known as "ghost towns", in the heart of the Atacama desert.
MOGO MOGO	PEARL ISLANDS	Discover the lagoons and the beaches.
PUERTO QUETZAL	GUATEMALA	Discover Antigua de Guatemala, a town renowned for its baroque colonial architecture, a UNESCO World Heritage Site.
SALAVERRY	PERU	Visit the city of Trujillo and discover the archaeological site of Chan Chan and the ruins of its citadel, a UNESCO World Heritage Site.
SAN JUAN DEL SUR	NICARAGUA	Visit the city of Granada, famous throughout the country for its well-preserved colonial architecture.

* For more information on your complimentary excursions, see the General Important Informations, page 58.

YOUR OPTIONAL EXCURSIONS

Please find below samples of the optional shore excursions, exclusively sold on board. Pricing, tour titles and duration are subject to change. Full tour program is available on our website www.ponant.com 12 months prior to your cruise. Final program will be sent with your cruise documents.

PORT	COUNTRY	NAME OF THE EXCURSION	DURATION	PRICE
CASTRO	CHILE	Castro and its churches	3H30	65 €
FERNANDO DE NORONHA	BRAZIL	Island tour by jeep	8H00	60 €
FUNCHAL	MADEIRA - PORTUGAL	Monte & botanical gardens	4H00	55 €
LAS PALMAS	CANARY ISLANDS - SPAIN	Las Palmas city tour	8H00	95 €
NELSON DOCKYARD	ANTIGUA & BARBUDA	Best of Antigua	3H30	49 €
PORTO SANTO	MADEIRA - PORTUGAL	Porto Santo Island tour	3H30	40 €
PRAIA	CAPE VERDE	Praia and Cidade Velha	4H00	65 €
PUERTO MONTT	CHILE	Petrohue Rapids, navigation and Puerto Varas	8H00	135 €
PUERTO NATALES	CHILE	Torres del Paine National Park	10H00	179 €
RECIFE	BRAZIL	Olinda and Recife	4H00	75 €
RIO DE JANEIRO	BRAZIL	Rio on foot	4H00	35 €
RIO DE JANEIRO	BRAZIL	Corcovado & beaches of Rio	4H00	65 €
SAO VICENTE	CAPE VERDE	Island tour by 4-wheel drive	4H30	89 €
TENERIFE	CANARY ISLANDS - SPAIN	Northern Tenerife	5H00	49 €

OVERLANDS (pre-bookable tour)

Reservation and payment must be made when booking your cruise or at least 60 days prior to departure date. Full tour program is available on our website www.ponant.com or with your travel agent. Prices can be changed or modified. A minimum of participants is required to confirm.

GUAYAQUIL - ECUADOR

Quito by plane
(14 hours)

From 535 € per person



GUAYAQUIL - ECUADOR

Cuenca by plane
(11 hours)

From 485 € per person



PISCO - PERU

The Nazca Lines
(3 hours 45 min)

From 545 € per person



CALLO - PERU

Machu Picchu
(3 days / 2 nights)

From 2 150 € per person



PUERTO QUETZAL - GUATEMALA

The Pyramid of Tikal
(10 hours)

From 675 € per person



FORMALITES

FOR ALL CRUISES

The below information is current but subject to change at any time without advance notice from government authorities. Please consult your respective government agencies for visa and health information.

Passport valid for at least six (6) months beyond the completion of your trip. Passport must contain at least two completely clear, blank, unused visa pages for each visa required, not including any amendment pages. Visa pages with stains or ink from other pages in the passport are not usable. Guests who deviate from the scheduled embarkation or disembarkation port should research the foreign entry requirements for the port country. Due to government regulations, regrettably, PONANT will have to deny boarding to any guest who fails to obtain the appropriate travel documentation for this trip.

SPECIFIC INFORMATIONS

LE BORÉAL: COLON • CALLAO FROM OCTOBER 16TH 2016, PAGE 14

Panama: a tourist visa is required for Australian citizens. The visa can be obtained upon arrival at the airport: cost US\$5

LE BORÉAL: CALLAO • VALPARAISO FROM OCTOBER 25TH 2016, PAGE 16 ⁽¹⁾

LE SOLÉAL: PUNTA ARENAS • USHUAIA FROM OCTOBER 29TH 2016, PAGE 20 ⁽¹⁾⁽²⁾

LE BORÉAL: VALPARAISO • USHUAIA FROM NOVEMBER 02ND 2016, PAGE 18 ⁽¹⁾⁽²⁾

LE BORÉAL: USHUAIA • VALPARAISO FROM MARCH 05TH 2017, PAGE 18 ⁽¹⁾⁽²⁾

LE BORÉAL: VALPARAISO • GUAYAQUIL FROM MARCH 18TH 2017, PAGE 22 ⁽¹⁾

(1) Chile: Entry/Exit requirements for Australian and Mexican citizens entering/exiting Chile must have a valid passport and pay a RECIPROCITY TAX that will be issued for a stay of up to 90 days upon payment. Currently, the fee is only charged at the Santiago International Airport. Payment can be made in U.S. currency or by credit card. At time of print, the fees were as follow (subject to change without notice): Australia: US\$117 - Mexico: US\$23

(2) Argentina: Entry/Exit requirements for Australian, Canadian and U.S. citizens entering/exiting Argentina must have a valid passport and pay a RECIPROCITY TAX. This tax must be prepaid online and prior to the arrival in Argentina, please follow the instructions detailed on the Argentina Immigration Office website: www.migraciones.gov.ar.

At time of print, the fees were as follow (subject to change without notice): Australia: US\$100 - Canada: US\$75 - USA: US\$160

LE SOLÉAL: MONTEVIDEO • RECIFE FROM MARCH 08TH 2017, PAGE 26

LE SOLÉAL: RECIFE • LISBON FROM MARCH 17TH 2017, PAGE 28

Brazil: Should you need a visa for Brazil, we strongly recommend you start the necessary application process early. Yellow Fever vaccination is strongly recommended.

IMPORTANT INFORMATIONS

- **Machu Picchu program:** A medical certificate is compulsory. The city of Cuzco's altitude is around 3 350 meters.
- **Chilean Fjords program:** During this cruise, Zodiac® outings and/or landings may be organized to bring you closer to the hidden wonders of these spectacular fjords and glaciers.
- **Ecuador program:** A medical certificate is recommended for people with breathing or heart problems. In Ecuador, the city of Quito is at an altitude of around 2 850 meters.
- **Galàpagos program:** The average temperature in the Galàpagos Islands at the time of our visit is around 30° C with scattered showers. Because you may have to wet your feet to go ashore, suitable shoes must be worn. Snorkelling equipment is available for hire on site, however if you have a prescription mask, please do bring your own. Remember to bring your binoculars and a camera (preferably waterproof) to immortalize your swims. During this program you will be required to walk 3 to 4 hours per day on volcanic soil, which can sometimes be slippery. You may bring trekking poles to help you. This program is not suitable for the mobility impaired. We strongly advise seeking your doctor's opinion before joining this program.
- **Panama Canal program:** The schedules depend on several factors and despite our best efforts, crossing the Panama Canal during the day is not guaranteed.





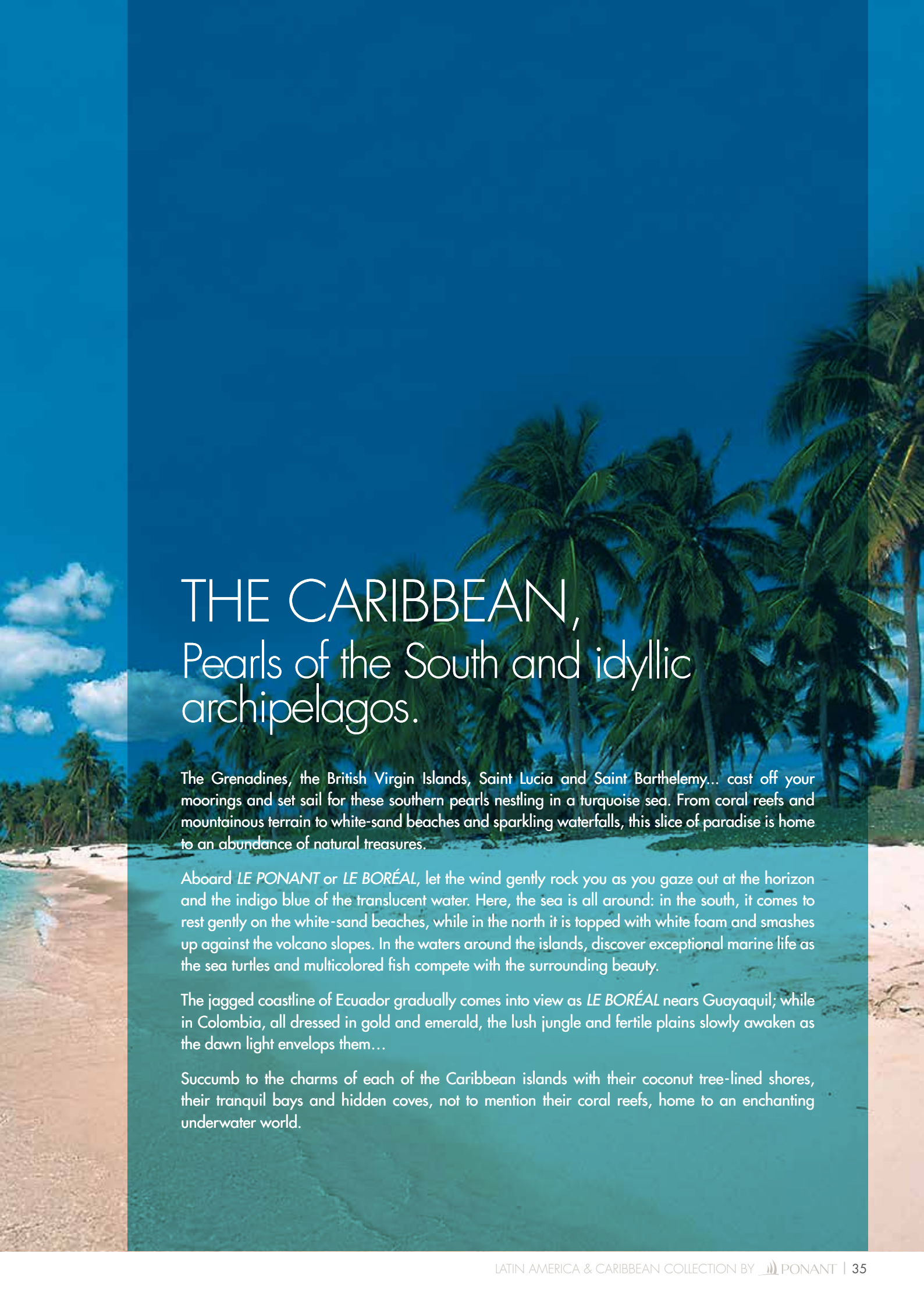

THE CARIBBEAN, Pearls of the South and idyllic archipelagos.

The Grenadines, the British Virgin Islands, Saint Lucia and Saint Barthelemy... cast off your moorings and set sail for these southern pearls nestling in a turquoise sea. From coral reefs and mountainous terrain to white-sand beaches and sparkling waterfalls, this slice of paradise is home to an abundance of natural treasures.

Aboard *LE PONANT* or *LE BORÉAL*, let the wind gently rock you as you gaze out at the horizon and the indigo blue of the translucent water. Here, the sea is all around: in the south, it comes to rest gently on the white-sand beaches, while in the north it is topped with white foam and smashes up against the volcano slopes. In the waters around the islands, discover exceptional marine life as the sea turtles and multicolored fish compete with the surrounding beauty.

The jagged coastline of Ecuador gradually comes into view as *LE BORÉAL* nears Guayaquil; while in Colombia, all dressed in gold and emerald, the lush jungle and fertile plains slowly awaken as the dawn light envelops them...

Succumb to the charms of each of the Caribbean islands with their coconut tree-lined shores, their tranquil bays and hidden coves, not to mention their coral reefs, home to an enchanting underwater world.



WHY THE CARIBBEAN?



SPEND CHRISTMAS & NEW YEAR'S DAY IN THE CARIBBEAN

This year, gift yourself an unforgettable festive season, far from the cold and dreary weather at home. Whether at the heart of the Grenadines, on the beaches of Saint Barthelemy or in front of the silhouette of the Soufriere in Saint Lucia, you will get to enjoy the sun and traditions of the Caribbean, all so different from our own. There will be no Christmas tree here, and lobster, pork and rum will replace the traditional roast turkey. You will spend your festive season on the golden sandy beaches in the shade of coconut trees. Take the opportunity to discover the local culture on Christmas Eve as you listen to Christmas carols punctuated by Creole, and celebrate 2017 in the company of these islands' friendly locals.



FOR ITS LONGSTANDING CULTURE AND TRADITIONS

The multiple identities, shaped by Indian rites, African history and European influence, make the Caribbean a culturally-rich destination. At the colorful markets where the air is filled with the scent of fruit, flowers and spices, you will find authentic local crafts including woven baskets, wooden sculptures, cloth dolls, gourd bags... all of them ideal souvenirs of these carefree moments. In this place where the pace of life is dictated by the sun, relax to the sound of the drums and percussion that inspired the Calypso, the slow waltz and the beguine which the locals dance to perfection.



FOR THE WHITE SANDY BEACHES

The first rays of sunshine caress the elegant lines of the bay. On the beaches, the white and golden sand is already sparkling. Aboard *LE PONANT* or *LE BORÉAL*, set off to discover these unique places worthy of the most beautiful postcards, where mingle the color palettes of the golden or black-sand beaches, the crystal-clear water of the cascades and the turquoise of the sea. The landscapes are colorful, the sun is ever-present, and you will feel like home is another world away as you look out at these stunning shores lined with lush vegetation. From the coral reefs to the mountains, volcanic lands and tropical rainforest, come and experience a different way of discovering the Caribbean, where each site reveals to travelers a new facet and new contrasts.

FOR THE CARIBBEAN UNDER SAIL

Join us aboard *LE PONANT* and discover the Caribbean, a dream destination for this yacht that is perfectly suited to island hopping. Nautical tradition, elegance, luxurious comfort, 32 gracious cabins and the refined atmosphere of a private yacht. Come and experience the sensations of the look-outs of yore as they spotted land on the horizon and gradually watched an island emerge. Sail on the turquoise waters aboard our three-mast yacht at the heart of idyllic archipelagos, let the wind rippling the sails soothe you, dive cleanly into the sea from the marina platform, and wake each morning under a new blue sky. Secret sun-kissed ports of call and vanilla-scented air are guaranteed.



TO DIVE INTO THE TURQUOISE WATER

The British Virgin Islands, the Grenadines, Saint Lucia... lost in the heart of the Caribbean Sea, to the east of Panama, this myriad of islands is evocative of dreams and adventure, and a paradise for divers from around the world. Whether you are a novice or an experienced diver, set sail aboard *LE PONANT* for a unique destination. Always accompanied by our experienced monitors, you will enjoy unusual encounters: coral reefs, mysterious shipwrecks and tropical fish where elegant rays dance in time with barracudas. From port to port and at your own pace, discover the underwater world of the Caribbean.



CHRISTMAS IN THE CARIBBEAN

The islands create the spirit of the journey... the Caribbean paints it to life with its brilliant colors. From Saint Martin, embark on LE PONANT to set sail for the British Virgin Islands before heading to Saint Barths, where inlets and coves try to outdo one another with their natural beauty. Come and spend Christmas in the heart of this small, unspoiled paradise.



JOST VAN DYKE

Your cruise aboard *LE PONANT* will lead you to discover the pearl of the British Virgin Islands, said to have been named after a fearsome Dutch pirate from long ago. The hilly landscape offers travelers beautiful wild expanses lined with immaculate beaches where the breeze gently caresses the coconut palms. This is a slice of paradise with crystal-clear waters, where dolphins often join us, amusing themselves with some bow riding. Here, colors and scents are omnipresent: yellow cedar is the archipelago's emblem, while hibiscuses and frangipani bloom a little everywhere. As for the wildlife, iguanas, mongooses, pelicans and blue herons have taken up residence on these islands, much to the delight of our passengers who love a good holiday snap!



THE BRITISH VIRGIN ISLANDS

We will take you to the heart of the Virgin Islands, where you will find sublime moors with stunning beaches tucked away in small tranquil bays, small houses in soft colors, and welcoming villagers. Discovered and named by Christopher Columbus, these islands, where Caribbean Indians described by Columbus as timid lived for a time, are now mostly uninhabited. Composed of over 60 islands surrounded by coral reefs, this extraordinary archipelago attracts divers from all around the world. During your cruise, discover Tortola, the nature island, and its mangrove, as well as Virgin Gorda and its stunning natural pools of emerald water. Many claim that these volcanic islands with majestic landscapes inspired the famous novel *"Treasure Island"*. Succumb to the beauty of Virgin Gorda's *"Baths"*, formed by chaotic piles of boulders between the fine sand and the crystal-clear water.



SAINT MARTIN • FORT DE FRANCE

Aboard *LE PONANT*

From December 17th au 26th 2016 (9 nights)

From 3 140 €

See price list page 56.

HIGHLIGHTS

- Spending Christmas Eve in the Caribbean.
- Discovering the British Virgin Islands, where each white-sand beach is more stunning than the next.
- Lazing about on the most beautiful beach in the Caribbean: Sandy Beach, a natural paradise.
- Discovering the bustling St. Barths, a tropical island with a wonderful natural elegance.
- Exceptional sea beds where you will be able to observe sea turtles, barracudas, spiny lobsters, and parrotfish.
- The presence of an experienced diving instructor.

LES SAINTES

Nature must have been in a playful mood when it gave Guadeloupe the silhouette of a butterfly resting on the Caribbean Sea. Its two wings envelop Pointe à Pitre, while in the south Basse Terre offers visitors a natural version of the tropics, on the wooded slopes of the La Soufrière volcano. Lost in the tropics, a few cables' lengths away from Guadeloupe, Les Saintes are composed of two volcanic islands and 7 other small islands with evocative names. Discovered by Christopher Columbus in 1493, Les Saintes awaken the imagination of travelers and offer extraordinary panoramas: Grande Terre welcomes you with its splendid Bay of Anse du Bourg, recognized as one of the most beautiful in the world; its spectacular Pain de Sucre (Sugarloaf Mountain), which is reminiscent of Rio de Janeiro; and its charming village where the quiet streets are lined with pretty houses. Basse Terre, its smaller sibling in the south, is much less popular, offering visitors calm, a gentle and quiet lifestyle, and welcoming locals. Do not miss this unique port of call to discover these stretches of land lost in the middle of the Caribbean Sea.



EXTRACT FROM THE CAPTAIN'S LOG

"What a pleasure to be back in the Caribbean. Sunshine, a turquoise sea, the trade winds. Our first port of call was in Les Saintes with their rugged coast, once a hotbed for pirates. We moored in the superb harbor in front of the village of Bourg. We then left the French West Indies to head for the British Virgin Islands. We landed on a beach. The passengers wanted to photograph the ship so I made some maneuvered near the beach. We are in contact with the Cruise Director and I called to shore to ask if the photos had come out alright... Now we are heading south to Antigua, the island with 365 beaches; a sheltered port which welcomes the most beautiful ships on the planet."

Aboard **LE PONANT** - December 23rd 2014

SAINT MARTIN • FORT DE FRANCE

LE PONANT - From December 17th to 26th 2016
10 days / 9 nights

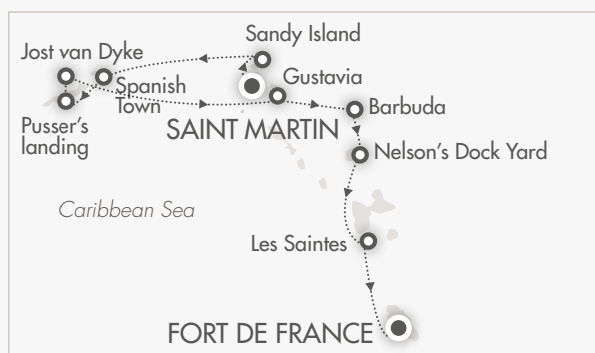

DAY	ITINERARY
Dec 17 th	Saint Martin (French West Indies) Embarkation from 17.00 to 18.00
Dec 18 th	Sandy Island (Anguilla)
Dec 19 th	Spanish Town (British Virgin Islands) Virgin Gorda & Prickly Pear (British Virgin Islands)
Dec 20 th	Pusser's landing (Tortola - British Virgin Islands)
Dec 21 st	Jost van Dyke (British Virgin Islands)
Dec 22 nd	Gustavia (Saint Barths - French West Indies)
Dec 23 rd	Barbuda (Antigua & Barbuda)
Dec 24 th	Nelson's Dock Yard (Antigua & Barbuda)
Dec 25 th	Les Saintes (Guadeloupe)
Dec 26 th	Fort de France (Martinique). Disembarkation.



NEW YEAR IN THE GRENADINES

From the beaches that seem to stretch on forever, to the coconut trees lining the coast, the crystal-clear turquoise waters, the primary forests and the dormant volcanoes, the Caribbean archipelago offers its visitors a rich palette of colors and idyllic landscapes. In Fort de France, board our elegant yacht, LE PONANT, for an exceptional cruise to the heart of these coral islands, between the Grenadines and Martinique.



UNESCO

SAINT LUCIA - LA SOUFRIERE

Saint Lucia is a small English-speaking island shaped like a mango. Lush and volcanic, it is situated between Martinique and Saint Vincent. One of the poetically-named "Windward Islands", it offers visitors luxuriant, wild nature and long fine-sand beaches, not to mention its two rocky peaks listed as UNESCO World Heritage Sites. These huge volcanic cones shaped like sugarloaves naturally watch over the island's west coast. When *LE PONANT* drops anchor here, do not miss your chance to discover the island's majestic volcano, La Soufriere. Here, the thick mantle of greenery and the spicy scents of the rainforest give way to a lunar landscape where the smell of sulfur pervades and the fumaroles and steam jets that shoot out of the ground provide proof that this imposing volcano is still very active.



CARRIACOU - PARADISE BEACH

During your cruise, *LE PONANT* will take you on a journey to gems of rare beauty: the Grenadines and, more particularly Carriacou, nicknamed "the island surrounded by reefs". Sitting on the horizon between the Caribbean Sea and the Atlantic Ocean, the lascivious curves of this small stretch of land are covered in a veil of jade-colored vegetation and gleaming beaches mark its outline, while its lagoon unabashedly bares its splendor under the brightest of sunlight. This island is both mountainous and hilly, covered in sage and Angola peas, and has managed to preserve its deep-rooted culture and traditions over time. During your stop here, discover this picturesque island and in particular Paradise Beach, which is considered to be one of the most beautiful in the world.



NEW YEAR'S
CRUISE

FORT DE FRANCE • FORT DE FRANCE

Aboard *LE PONANT*

From Dec 26th 2016 to Jan 03rd 2017 (8 nights)

From 3 360 €

See price list page 56.

HIGHLIGHTS

- Spending New Year's Eve in the Caribbean.
- Discovering Saint Lucia and its two rocky peaks, listed as UNESCO World Heritage Sites.
- Lazing around on the long white-sand beaches.
- Discovering the Grenadine Islands, considered one of the world's most stunning archipelagos.
- Exceptional sea bed with possibility to observe turtles, barracudas, spiny lobsters and parrot fishes.
- The presence of an experienced diving instructor.

THE GRENADINES

The Grenadine Islands are a string of Caribbean jewels with a sweet name, stretching out over the cobalt blue water. A stay in the heart of the Grenadines will have you lazing on beaches and flitting from island to island with the wind. During your cruise aboard *LE PONANT*, discover Bequia, "whaler island", with its unspoiled and authentic coastline; Mayreau, the pearl of the archipelago, considered as one of the most beautiful islands in the Grenadines thanks to its lush valleys and idyllic beaches; and Tobago Cays Marine Park, which will reveal to you its bays protected by a coral reef, and its exceptional sea beds that contain a kaleidoscope of colors. This is a dream destination for explorers who love to contemplate beaches where sea turtles dwell.



DIVING IN THE CARIBBEAN SEA

The Caribbean Sea is known as one of the richest and most beautiful on earth and it is a dream destination for divers. That is why during your cruise, we offer you the chance to do some exploration dives and snorkelling circuits with an experienced and qualified instructor. Whether you are a beginner or advanced, our variety of scuba diving and snorkelling excursions caters to all levels of experience. Come and explore the underwater world of this unique sea, along reefs that are home to extraordinary flora and fauna, and discover numerous varieties of corals and fish such as barracudas, spiny lobsters, parrotfish and bonito, as well as turtles.



FORT DE FRANCE • FORT DE FRANCE

LE PONANT - From Dec 26th 2016 to Jan 03rd 2017
9 days / 8 nights



DAY ITINERARY

Dec 26 th	Fort de France (Martinique) Embarkation from 17.00 to 18.00
Dec 27 th	Soufriere (Saint Lucia)
Dec 28 th	Bequia (Grenadines)
Dec 29 th	Saint George's (Grenada)
Dec 30 th	Carriacou (Grenadines)
Dec 31 st	Tobago Cays (Grenadines)
Jan 01 st	Mayreau (Grenadines)
Jan 02 nd	Grande Anse d'Arlet (Martinique)
Jan 03 rd	Fort de France (Martinique). Disembarkation.



SECRETS OF THE GRENADINES

Aboard LE PONANT, cruise to this earthly paradise of golden-sand beaches, clear lagoons and cascading bougainvillea, where each island reveals an authentic personality against a backdrop of African-inspired music, tropical colors, and the infinite sensuality that such settings awaken in us.



FORT DE FRANCE

This city, lying on the Caribbean coast of Martinique, a French overseas department, is a major hub in the Lesser Antilles. At dawn, Fort de France will surprise you with its effervescent glow. At sunrise, the markets come alive as the aroma of spices, fruit and vegetables fill the streets. From district to district and street to street, each rich with historical monuments, the city can be read like a book of West Indian literature: incandescent, generous, warm, Creole... An amazing blend of modern architecture and colorful Creole villas, the city's colonial past has preserved a number of monuments worthy of interest, like the Saint Louis Cathedral with its magnificent stained glass windows.



SAINT GEORGE'S

All the islands of the West Indies are attractive, but some truly stand out. Grenada, also known as "the isle of spice", is a small, hilly island forged by volcanic activity, with crater lakes and mountain slopes covered with dense tropical rainforest, minuscule villages and numerous plantations. Its elegant capital, Saint George's, lies in a horseshoe-shaped harbor on the West coast and was founded on the orders of Richelieu in 1650. It is a particularly picturesque town, built around the port, and it has preserved its colonial architecture with its red-tiled roofs and pastel colors. When *LE PONANT* drops anchor here, discover this island off the beaten path, the wild beauty of its tropical rainforest, its immaculate beaches and its many waterfalls.



FORT DE FRANCE • FORT DE FRANCE Aboard LE PONANT

From January 31st to February 07th 2017 (7 nights)

From 2 710 €

See price list page 56.

FORT DE FRANCE • SAINT MARTIN Aboard LE PONANT

From February 07th to 14th 2017 (7 nights)

From 2 710 €

See price list page 56.

HIGHLIGHTS

- Discovering the Tobago Cays Marine Park.
- Discovering Saint Lucia and its two rocky peaks, listed as UNESCO World Heritage Sites.
- An exceptional stop in Saint Barthelemy, a slice of paradise in the French West Indies.
- Before or after your cruise, an optional tour of Fort de France for its modern architecture and Creole villas.
- The exceptional presence of an experienced diving instructor.

TOBAGO CAYS - THE GRENADINES

The Grenadines Islands stretch out along the turquoise water, forming one of the jewels of the Caribbean. Among them, the Tobago Cays Marine Park will reveal to you its harbors protected by the coral reef and the kaleidoscope of its aquatic treasures. Here, the locals say that the beach, the nature reserves and the small villages make the hands of time turn slowly... A dream for explorers who like to gaze at picture-postcard beaches and the limpid waters of the coast, complete with resident sea turtles. Bound together by the most beautiful coral reef in the West Indies, these rocky outcrops will provide the mooring for *LE PONANT*, allowing you to feast your eyes on the beauty all around you.



SAINT BARTHELEMY

The French West Indies wanted their own paradise... their wish was granted with Saint Barthelemy. Nestled between the Caribbean Sea and the Atlantic Ocean, in the North of the West Indies, St. Barths is a small island of 25 km² that is a happy blend of modernism and tradition. You will be enchanted by its magic and undeniable charm. Coves and inlets of white sand and blue sea coupled with the colorful and exuberant vegetation make this island a true paradise. Its white houses with their colorful roofs are testament to the century it spent under Swedish influence. It has successfully preserved the charm of its unspoiled nature and its precious environment.

FORT DE FRANCE • FORT DE FRANCE

LE PONANT - From January 31st to February 07th 2017
8 days / 7 nights



DAY	ITINERARY
Jan 31 st	Fort de France (Martinique) Embarkation from 17.00 to 18.00
Feb 01 st	Marigot - Soufriere (Saint Lucia) Sailing past Les Pitons
Feb 02 nd	Bequia (Grenadines)
Feb 03 rd	Saint George's (Grenada)
Feb 04 th	Paradise Beach - Carriacou (Grenada)
Feb 05 th	Tobago Cays (Grenadines)
Feb 06 th	Grande Anse d'Arlet (Martinique)
Feb 07 th	Fort de France (Martinique). Disembarkation.

FORT DE FRANCE • SAINT MARTIN

LE PONANT - From February 07th to 14th 2017
8 days / 7 nights

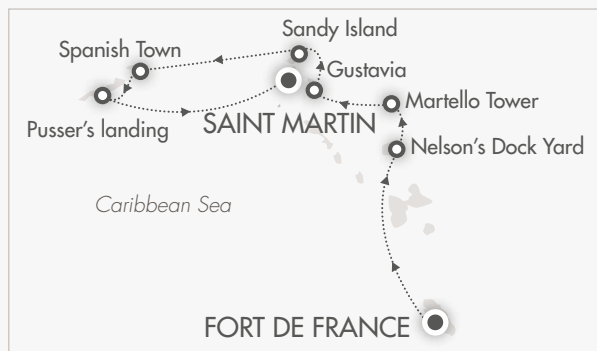

DAY	ITINERARY
Feb 07 th	Fort de France (Martinique) Embarkation from 17.00 to 18.00
Feb 08 th	Nelson's Dock Yard (Antigua)
Feb 09 th	Martello Tower (Barbuda)
Feb 10 th	Gustavia - Saint Barths (French West Indies)
Feb 11 th	Sandy Island (Anguilla)
Feb 12 th	Spanish Town (British Virgin Islands) Virgin Gorda & Prickly Pear (British Virgin Islands)
Feb 13 th	Pusser's landing (Tortola - British Virgin Islands)
Feb 14 th	Saint Martin (French West Indies). Disembarkation.

BETWEEN PANAMA & MARTINIQUE

Join us aboard LE BORÉAL to discover the countless riches of the Afro-Caribbean cultures between the Pacific and the Atlantic Oceans. From the famous Panama Canal to languorous Martinique via remarkable Colombia and Venezuela with its idyllic beaches, do not miss this cruise to the heart of the most beautiful landscapes in the Caribbean.



HOLANDES CAY - SAN BLAS ARCHIPELAGO

From the outer deck of *LE BORÉAL*, discover the undisputed jewel of Panama, the San Blas Islands, which are home to an unsuspected world: that of Native American Indians, the Kuna people. In this archipelago of 365 coral islands, of which only 60 are inhabited, we invite you to set out to discover Holandes Cay Island and to meet the Kuna who are friendly and proud of their culture. Here "Comarca Kuna Yala" means "land of the Kuna". These unspoiled islands, this garden of Eden with its carefully guarded secrets, this long strip of autonomous coastline is home to a people that still live from hunting and fishing and who have managed to maintain their unique culture over the centuries. In these islands scattered with palm trees and mangroves, not far from one of the wildest jungles, transport is still by dugout boats and the women create true masterpieces: Molas, sumptuous brightly-colored fabrics with geometric designs.



UNESCO

CARTAGENA OF THE INDIES

In the south-western corner of the Caribbean Sea, a group of low-lying islands, channels and lagoons will lead you to the mythical city of Cartagena, an old colonial city declared a UNESCO World Heritage Site in 1984. Founded in 1522 at the time of the Conquistadors, the city quickly became a hub for the trade of gold and precious goods. The town exudes romanticism. Fascinating anecdotes appear at the corner of a street or a square and along the city walls, which wait patiently until sunset to evoke the battles of the past. Do not hesitate to stroll through the narrow streets with colorful facades in the heart of the city. This is also where the gold pillaged from the Aztec and Incan empires was stored before being taken to Spain.



COMPLIMENTARY
EXCURSIONS
(see p46)

COLON • FORT DE FRANCE

Aboard LE BORÉAL

From April 12th to 19th 2017 (7 nights)

From 1 910 €

See price list page 56.

HIGHLIGHTS

- **UNESCO sites:** Cartagena de Indias, an old colonial city; Willemstad, capital of the island of Curaçao.
- Diving and snorkeling in the crystal-clear waters of the Pacific Ocean.
- Zodiac® excursions and discovery of the stunning San Blas Islands.
- Stopping to enjoy the beach and swim in the turquoise waters of Blanquilla Island.
- Extraordinary encounters with the Kuna Indians, a warrior tribe of the San Blas archipelago.
- Lecturer chosen for his/her area of expertise.

WILLEMSTAD

Off the coast of Venezuela, *LE BORÉAL* will call at an island with an evocative name: beautiful Curacao... The Dutch West Indies gradually reveal themselves as we cruise closer and the expanses of white sandy beaches at the foot of Mount Christoffel face the ship. From intimate rocky creeks to long beaches, the calm, clear waters are teeming with colorful dock fish. The island's capital, Willemstad, declared a UNESCO World Heritage Site, has retained its very individual atmosphere and the charm of its colonial period seems to surge forth from every corner and every square in its old quarter. You will be enchanted by its houses and their typically Dutch architecture, the rows of gabled façades in shades of pink, blue, yellow and pistachio green. Further on, a floating market is host to all sorts of crafts from South America and a floating pontoon bridge allows residents to cross the canal.



MARTINIQUE

Bathed by the Caribbean Sea in the west and the Atlantic Ocean in the east, Martinique is a rare pearl glistening under sunlight and blue skies. As a paradise worthy of the world's most beautiful postcards, this multi-faceted island enchants travelers. It offers 1,100 km² of exotic and varied landscapes: from the North to the South, the luxuriant magic of the tropical rainforest mingles with rolling hills and inlets of volcanic sand blend with the golden beaches stretching out in the shade of the coconut trees. Each time our ship drops anchor, be enchanted by the colors and subtle scents of the diverse and radiant flora, which once earned Martinique the prettiest of nicknames: "island of flowers"...



COLON • FORT DE FRANCE

LE BORÉAL - From April 12th to 19th 2017
8 days / 7 nights



DAY	ITINERARY
April 12 th	Colon (Panama) Embarkation from 16.00 to 18.00
April 13 th	Holandes Cay (Panama)
April 14 th	Cartagena (Colombia)
April 15 th	<i>At sea</i>
April 16 th	Willemstad (Curaçao)
April 17 th	La Blanquilla (Venezuela)
April 18 th	Marigot - Soufriere (Saint Lucia)
April 19 th	Fort de France (Martinique). Disembarkation.



SHORE EXCURSIONS HIGHLIGHTS

PONANT offers you a choice of free excursions, designed to allow you to discover the treasures of the Caribbean. For more information, please consult www.ponant.com or call our Travel Advisor.

YOUR COMPLIMENTARY EXCURSIONS*

PORT	COUNTRY	YOUR SHORE EXCURSIONS
CARTAGENA	COLOMBIA	Discover the ancient colonial city of Cartagena, with a visit to the famous La Popa monastery, the San Felipe de Barajas fortress and the Gold museum, where you can admire the oldest ceramics in the Americas, amongst other exhibits.
WILLEMSTAD	CURACAO	An exceptional visit to the historic old town of Willemstad, a UNESCO World Heritage Site. A walking tour of the 19 th Century Fort Rif plus the historic Punda neighbourhood and its famous floating market.
MARIGOT	SAINT LUCIA	Essential Marigot: Its superb bay offering an incredible view, Castries, the charming capital and its market, and the La Toc Battery, a famous fort.
SOUFRIERE	SAINT LUCIA	From the port, discover La Soufriere, thought to be the only volcano in the world that can be explored from vehicles, and its sulphur springs.

* For more information on your complimentary excursions, see the General Important Informations, page 58.

YOUR OPTIONAL EXCURSIONS

Please find below samples of the optional shore excursions, exclusively sold on board. Pricing, tour titles and duration are subject to changes. Full tour program is available on our website www.ponant.com 12 months prior to your cruise. Final program will be sent with your cruise documents.

PORT	COUNTRY	NAME OF THE EXCURSION	DURATION	PRICE
BEQUIA	GRENADINES	Time at leisure on the beach		
CARRIACOU	GRENADA	Time at leisure on the beach		
GRANDE ANSE D'ARLET	MARTINIQUE	4-wheel drive adventure	5H00	59 €
MARIGOT	SAINT LUCIA	Marigot Escapade	3H00	35 €
NELSON DOCKYARD	ANTIGUA & BARBUDA	Best of Antigua	3H30	49 €
ST. BARTHS	FRENCH WEST INDIES	Submarine adventure	1H00	49 €
SAINT GEORGE'S	GRENADA	Spices & falls	4H00	45 €
TOBAGO CAYS	GRENADINES	Time at leisure on the beach		

FORMALITIES

FOR ALL CRUISES

The below information is current but subject to change at any time without advance notice from government authorities. Please consult your respective government agencies for visa and health information.

Passport valid for at least six (6) months beyond the completion of your trip. Passport must contain at least two completely clear, blank, unused visa pages for each visa required, not including any amendment pages. Visa pages with stains or ink from other pages in the passport are not usable. Guests who deviate from the scheduled embarkation or disembarkation port should research the foreign entry requirements for the port country. Due to government regulations, regrettably, PONANT will have to deny boarding to any guest who fails to obtain the appropriate travel documentation for this trip.



Dives when authorized by local authorities and feasible with ship equipment and zodiacs. Rates: 70 € per standard dive; 80€ per dive when local equipment or staff must be used, 80€ for a “discover scuba dive” course. In order to participate to diving sessions, guests must have with them a medical certificate less than 2 months old and their up to date dive book.





LE BORÉAL & LE SOLÉAL



With their fluid lines, their size perfectly adapted to sailing to the heart of isolated reserves and archipelagos in Latin America and the Caribbean, their appearance enhanced by two glass arches that let in light and provide water views: *LE BORÉAL* and *LE SOLÉAL* reflect the spirit of a subtly revisited nautical theme.



On board, irrespective of which cruise you choose, you will always find the same exceptional conditions of comfort, service and elegance that have forged PONANT's reputation. Whether you are enjoying breakfast among friends with the horizon as special guest, a sun-kissed lunch on one of our outside decks, or a delicious dinner in the elegant and intimate setting of our fine dining restaurants, you will appreciate the French touch that naturally gives pride of place to discreet service and excellent cuisine.

To ensure a tailored cruise where you can enjoy total peace of mind, our beauty spa, run in partnership with the French beauty institute SOTHY'S Paris™, invites you to enjoy deep relaxation, and a butler service is also available to passengers travelling in one of the suites on Deck 6.

And because we are convinced that a responsible approach is a must in our quest for excellence, PONANT made the decision to equip its sisterships with outstanding eco-friendly equipment. As a result, all ships bear the international "Clean ship" label.



Welcome aboard.



OWNER'S SUITE (484 sq.ft + 97 sq.ft. private balcony)

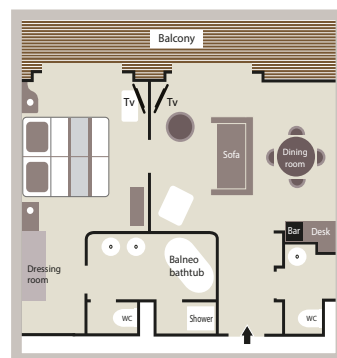

20 PRESTIGE SUITES (398 sq.ft. + 86 sq.ft. private balcony)

92 PRESTIGE STATEROOMS (200 sq.ft. + 43 sq.ft. private balcony)

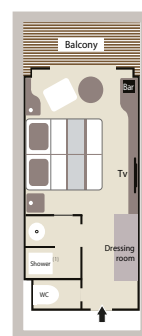
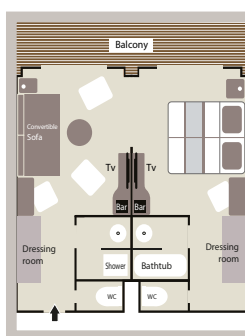

(1) Prestige staterooms on board LE BORÉAL & LE SOLÉAL, Decks 5 & 6 : 1 shower or 1 bathtub depends on cabins.

3 DELUXE SUITES (290 sq.ft. + 54 sq.ft. private balcony)

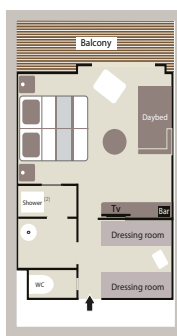

(2) Deluxe Suites on board LE BORÉAL : 1 shower and 1 bathtub.

28 DELUXE STATEROOMS (200 sq.ft. + 43 sq.ft. private balcony)

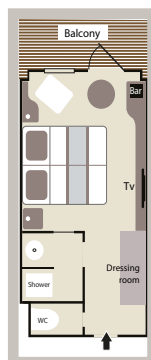

8 SUPERIOR STATEROOMS (226 sq.ft.)

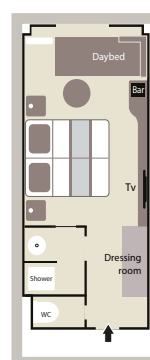

LE BORÉAL
& LE SOLÉAL
Staterooms
& Decks

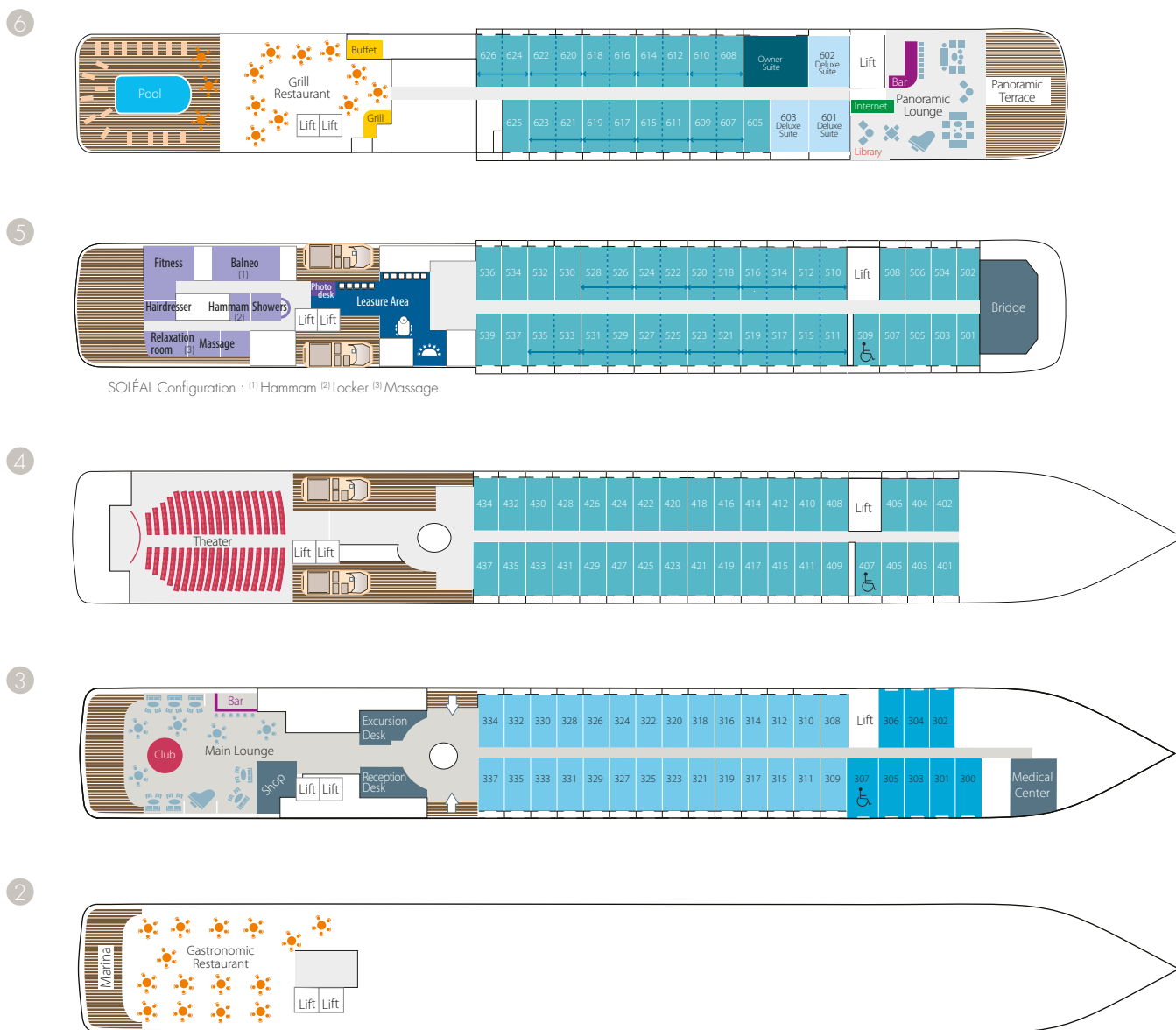

- 2 Gastronomic Restaurant - Marina
- 3 28 Deluxe Staterooms with private balcony
- 8 Superior Staterooms - Main Lounge
- Shop - Reception desk - Excursion desk - Medical center
- 4 35 Prestige Staterooms with private balcony
- Theater
- 5 37 Prestige Staterooms with private balcony
(with 22 Prestige Staterooms convertible into 11 Prestige suites) - Fitness - Beauty Corner Sothys Paris™ : Hammam, cloak rooms, Massage, Hairdresser, Relaxation room - Leisure Area - Image & photo corner - Bridge
- 6 Owner's suite - 3 Deluxe Suites with private balcony - 20 Prestige Staterooms with private balcony (with 18 Prestige Staterooms convertible into 9 Prestige suites) - Pool - Grill Restaurant - Internet station - Library - Panoramic lounge - Panoramic terrace

- Owner's Suite
Deck 6
- Prestige Suite
Deck 6 - 5
- Deluxe Suite
Deck 6
- Prestige Stateroom
Deck 4 - 5 - 6
- Deluxe Stateroom
Deck 3
- Superior Stateroom
Deck 3

- Length 466 ft
- Beam 59 ft
- Draft 15,3 ft
- Cruising Speed 16 knots
- Ice class 1 C
- Classification Bureau Veritas
- Flag French
- Guest Decks 6
- Guest capacity (double occupancy) up to 264 PAX
- Normal Crew Size 140
- Fleet of expedition Zodiacs® (Mark V HD)
- Gross tonnage 10 944 UMS
- Electric motors 2 x 2300 KW
- Installed power 6 400 KW
- Construction Fincantieri-Ancona-Italy



LE PONANT

NEW

In response to customer requests, *LE PONANT* now offers three categories of cabins:

- On the upper Antigua deck there are 5 cabins, each with a large port hole.
- On the Marie Galante deck, we have created 19 standard cabins as well as **8 new Premium cabins**; these are more spacious and offer our passengers exceptional comfort.

With its low-profile and dynamic lines, its 88 meters (290 ft) of long, streamlined decks, its three masts stretching toward the sky and its sails ready to bellow and fill with wind, *LE PONANT* was the first of the company's ships. It flies the French flag and offers its passengers a refined, intimate and exclusive cruising experience.



You do not need to be familiar with the rudiments of sailing to board this jewel of the fleet: you will not be taking part in maneuvers, but a friendly and approachable French crew is there to explain them all to you. Just like on a private yacht, you will sail with only a limited number of fellow passengers who truly love the sea.

On board, you will experience the "*French touch*", a subtle blend of relaxed elegance and conviviality. You will enjoy refined cuisine. Our Chef will demonstrate classic French culinary expertise.

From the huge and aptly named sundeck, enjoy the unique scenery as it unfolds before you. At the back of the ship, the marina platform sits just above the water, inviting passengers to swim, enjoy some water sports, or go diving or snorkeling with an experienced instructor. Lastly, this magnificent yacht's shallow draught, which is perfectly suited to island hopping, will allow you to get as close as possible to the beaches for exceptional moorings.

LE PONANT offers you a unique cruising experience, a blend of nautical tradition and great elegance.



Welcome aboard.



5 ANTIGUA DECK STATEROOMS (134 sq.ft. to 165 sq.ft.)

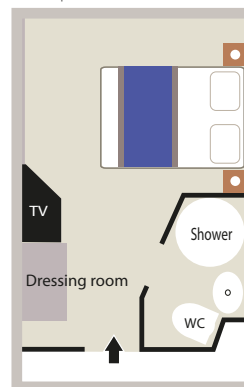

19 MARIE-GALANTE STATEROOMS 8 MARIE-GALANTE PREMIUM STATEROOMS (113 sq.ft. to 145 sq.ft.)



Twin Bed Version

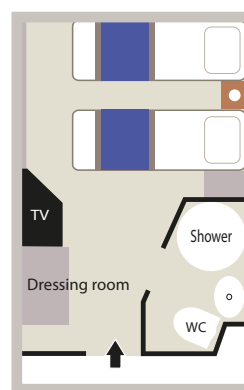

Double Bed version

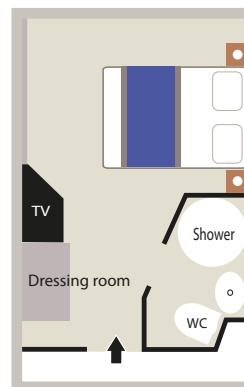

Triple version

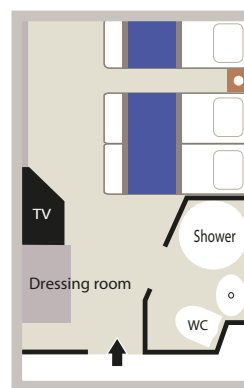

LE PONANT
Staterooms
& Decks

5 SUN DECK

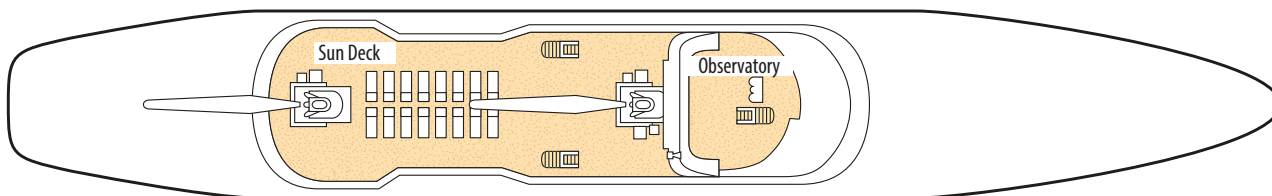

4 ANTIGUA DECK

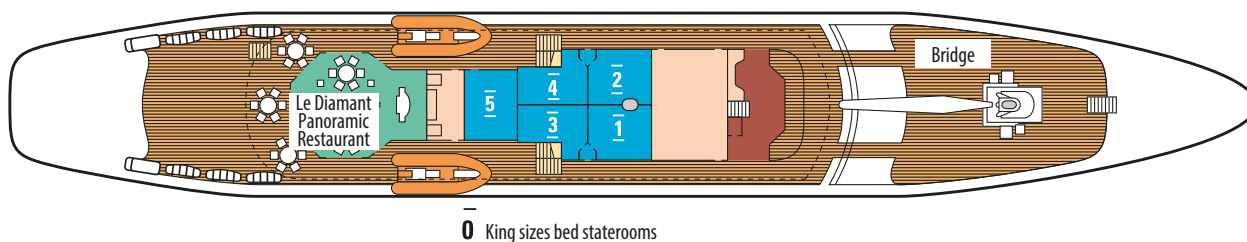

3 SAINT-BARTH DECK

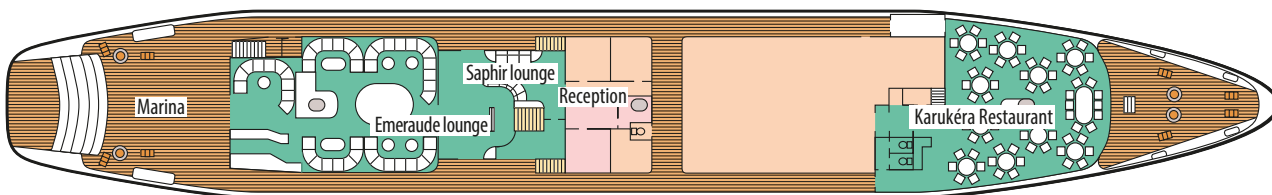

2 MARIE-GALANTE DECK

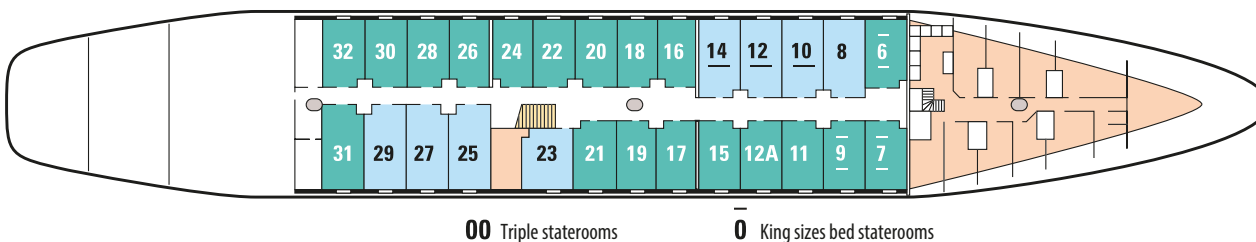

- 2 27 staterooms (with 3 triple staterooms and 3 double bed staterooms)
- 4 Le Diamant Panoramic Restaurant - Bridge
- 3 Marina - Emeraude lounge - Lobby - Saphir lounge - Karukéra Gastronomic Restaurant
- 5 Observatory - Sun Deck

32 cabins, all with a porthole and soothing pastel interiors.

- Antigua Staterooms
- Marie Galante Staterooms
- Marie Galante Premium Staterooms

PRICE LIST*

CRUISES FARES

OCTOBER 16TH 2016
9 nights on board

COLON • CALLAO
LE BORÉAL



Superior Stateroom	3 520 €	2 460 €
Deluxe Stateroom	3 870 €	2 700 €
Prestige Stateroom - Deck 4	4 150 €	2 900 €
Prestige Stateroom - Deck 5	4 350 €	3 040 €
Prestige Stateroom - Deck 6	4 570 €	3 190 €
Deluxe Suite	5 940 €	4 150 €
Prestige Suite - Deck 5	6 530 €	4 570 €
Prestige Suite - Deck 6	6 860 €	4 800 €
Owner Suite	8 910 €	-
3 rd adult Pass. in a Superior Stateroom	1 760 €	1 230 €
3 rd adult Passenger in a Prestige Suite	3 260 €	2 280 €
4 th adult Passenger in a Prestige Suite	3 260 €	2 280 €
Children 8-11 sharing parents ⁽¹⁾	-	-
Single Occupancy Supplement ⁽¹⁾	From + 30%	
Safety and port taxes ⁽¹⁾	450 €	

OCTOBER 25TH 2016
8 nights on board

CALLAO • VALPARAISO
LE BORÉAL



Superior Stateroom	2 840 €	1 980 €
Deluxe Stateroom	3 130 €	2 190 €
Prestige Stateroom - Deck 4	3 350 €	2 340 €
Prestige Stateroom - Deck 5	3 520 €	2 460 €
Prestige Stateroom - Deck 6	3 690 €	2 580 €
Deluxe Suite	4 430 €	3 100 €
Prestige Suite - Deck 5	4 570 €	3 190 €
Prestige Suite - Deck 6	4 800 €	3 360 €
Owner Suite	6 240 €	-
3 rd adult Pass. in a Superior Stateroom	1 420 €	990 €
3 rd adult Passenger in a Prestige Suite	2 640 €	1 840 €
4 th adult Passenger in a Prestige Suite	2 640 €	1 840 €
Children 8-11 sharing parents ⁽¹⁾	-	-
Single Occupancy Supplement ⁽¹⁾	From + 0%	
Safety and port taxes ⁽¹⁾	400 €	

OCTOBER 29TH 2016
11 nights on board + flights and transfers

PUNTA ARENAS • USHUAIA
LE SOLÉAL



Superior Stateroom	5 030 €	3 870 €
Deluxe Stateroom	5 480 €	4 180 €
Prestige Stateroom - Deck 4	5 830 €	4 430 €
Prestige Stateroom - Deck 5	6 100 €	4 620 €
Prestige Stateroom - Deck 6	6 380 €	4 810 €
Deluxe Suite	8 140 €	6 040 €
Prestige Suite - Deck 5	8 890 €	6 570 €
Prestige Suite - Deck 6	9 310 €	6 860 €
Owner Suite	11 950 €	-
3 rd adult Pass. in a Superior Stateroom	2 770 €	2 290 €
3 rd adult Passenger in a Prestige Suite	4 700 €	3 640 €
4 th adult Passenger in a Prestige Suite	4 700 €	3 640 €
Children 8-11 sharing parents ⁽¹⁾	1 170 €	-
Single Occupancy Supplement ⁽¹⁾	From + 30%	
Safety and port taxes ⁽¹⁾	550 €	
Airport taxes	20 €	

MARCH 17TH 2017
16 nights on board

RECIFE • LISBON
LE SOLÉAL



Superior Stateroom	4 470 €	3 120 €
Deluxe Stateroom	4 920 €	3 440 €
Prestige Stateroom - Deck 4	5 260 €	3 680 €
Prestige Stateroom - Deck 5	5 530 €	3 870 €
Prestige Stateroom - Deck 6	5 800 €	4 060 €
Deluxe Suite	7 550 €	5 280 €
Prestige Suite - Deck 5	8 290 €	5 800 €
Prestige Suite - Deck 6	8 710 €	6 090 €
Owner Suite	11 320 €	-
3 rd adult Pass. in a Superior Stateroom	2 240 €	1 560 €
3 rd adult Passenger in a Prestige Suite	4 150 €	2 900 €
4 th adult Passenger in a Prestige Suite	4 150 €	2 900 €
Children 8-11 sharing parents ⁽¹⁾	-	-
Single Occupancy Supplement ⁽¹⁾	From + 0%	
Safety and port taxes ⁽¹⁾	800 €	

MARCH 18TH 2017
12 nights on board

VALPARAISO • GUAYAQUIL
LE BORÉAL



Superior Stateroom	4 270 €	2 980 €
Deluxe Stateroom	4 700 €	3 290 €
Prestige Stateroom - Deck 4	5 030 €	3 520 €
Prestige Stateroom - Deck 5	5 280 €	3 690 €
Prestige Stateroom - Deck 6	5 540 €	3 870 €
Deluxe Suite	6 650 €	4 650 €
Prestige Suite - Deck 5	6 860 €	4 800 €
Prestige Suite - Deck 6	7 210 €	5 040 €
Owner Suite	9 370 €	-
3 rd adult Pass. in a Superior Stateroom	2 140 €	1 490 €
3 rd adult Passenger in a Prestige Suite	3 430 €	2 400 €
4 th adult Passenger in a Prestige Suite	3 430 €	2 400 €
Children 8-11 sharing parents ⁽¹⁾	-	-
Single Occupancy Supplement ⁽¹⁾	From + 0%	
Safety and port taxes ⁽¹⁾	600 €	

MARCH 30TH 2017
13 nights on board

GUAYAQUIL • COLON
LE BORÉAL



Superior Stateroom	5 090 €	3 560 €
Deluxe Stateroom	5 600 €	3 920 €
Prestige Stateroom - Deck 4	5 990 €	4 190 €
Prestige Stateroom - Deck 5	6 290 €	4 400 €
Prestige Stateroom - Deck 6	6 600 €	4 620 €
Deluxe Suite	8 580 €	6 000 €
Prestige Suite - Deck 5	9 430 €	6 600 €
Prestige Suite - Deck 6	9 900 €	6 930 €
Owner Suite	12 870 €	-
3 rd adult Pass. in a Superior Stateroom	2 540 €	1 770 €
3 rd adult Passenger in a Prestige Suite	4 720 €	3 300 €
4 th adult Passenger in a Prestige Suite	4 720 €	3 300 €
Children 8-11 sharing parents ⁽¹⁾	-	-
Single Occupancy Supplement ⁽¹⁾	From + 30%	
Safety and port taxes ⁽¹⁾	650 €	

*The detailed itineraries and the conditions of application of the cruise prices shown in this PONANT « LATIN AMERICA & CARIBBEAN - WINTER CRUISES 2016 - 2017 » catalogue are subject to the [General Information](#) and [Terms and Conditions](#) shown in page 58. Also discover our [Insurance](#) offer page 62. **The free single supplement is subject to availability at the time of booking. The cruises are only provided as an example. The cruises for which the offer is valid are subject to change. For more information, please viewed at www.ponant.com

Return flight
Ushuaia • Buenos Aires
and transfer included.

Outward flight **Buenos Aires • Ushuaia**
Lunch and free time in the Arakur resort
and transfer included.

NOVEMBER 02ND 2016

13 nights on board + return flight and transfer

VALPARAISO • USHUAIA
LE BORÉAL



Superior Stateroom	5 840 €	4 230 €
Deluxe Stateroom	6 370 €	4 600 €
Prestige Stateroom - Deck 4	6 790 €	4 900 €
Prestige Stateroom - Deck 5	7 100 €	5 120 €
Prestige Stateroom - Deck 6	7 430 €	5 350 €
Deluxe Suite	9 510 €	6 800 €
Prestige Suite - Deck 5	10 400 €	7 430 €
Prestige Suite - Deck 6	10 890 €	7 770 €
Owner Suite	14 010 €	-
3 rd adult Pass. in a Superior Stateroom	3 170 €	2 360 €
3 rd adult Passenger in a Prestige Suite	5 450 €	3 960 €
4 th adult Passenger in a Prestige Suite	5 450 €	3 960 €
Children 8-11 sharing parents ⁽¹⁾	500 €	-
Single Occupancy Supplement ⁽¹⁾⁽²⁾	From + 30%	
Safety and port taxes ⁽¹⁾	650 €	
Airport taxes	20 €	

MARCH 05TH 2017

13 nights on board + outward flight and transfer

USHUAIA • VALPARAISO
LE BORÉAL



Superior Stateroom	6 000 €	4 390 €
Deluxe Stateroom	6 530 €	4 760 €
Prestige Stateroom - Deck 4	6 950 €	5 060 €
Prestige Stateroom - Deck 5	7 260 €	5 280 €
Prestige Stateroom - Deck 6	7 590 €	5 510 €
Deluxe Suite	9 670 €	6 960 €
Prestige Suite - Deck 5	10 560 €	7 590 €
Prestige Suite - Deck 6	11 050 €	7 930 €
Owner Suite	14 170 €	-
3 rd adult Pass. in a Superior Stateroom	3 330 €	2 520 €
3 rd adult Passenger in a Prestige Suite	5 610 €	4 120 €
4 th adult Passenger in a Prestige Suite	5 610 €	4 120 €
Children 8-11 sharing parents ⁽¹⁾	660 €	-
Single Occupancy Supplement ⁽¹⁾⁽²⁾	From + 30%	
Safety and port taxes ⁽¹⁾	650 €	
Airport taxes	20 €	

MARCH 08TH 2017

9 nights on board

MONTEVIDEO • RECIFE
LE SOLÉAL



Superior Stateroom	2 180 €	1 520 €
Deluxe Stateroom	2 400 €	1 680 €
Prestige Stateroom - Deck 4	2 570 €	1 790 €
Prestige Stateroom - Deck 5	2 700 €	1 890 €
Prestige Stateroom - Deck 6	2 830 €	1 980 €
Deluxe Suite	3 680 €	2 570 €
Prestige Suite - Deck 5	4 040 €	2 820 €
Prestige Suite - Deck 6	4 250 €	2 970 €
Owner Suite	5 520 €	-
3 rd adult Pass. in a Superior Stateroom	1 090 €	760 €
3 rd adult Passenger in a Prestige Suite	2 020 €	1 410 €
4 th adult Passenger in a Prestige Suite	2 020 €	1 410 €
Children 8-11 sharing parents ⁽¹⁾	-	-
Single Occupancy Supplement ⁽¹⁾⁽²⁾	From + 0%	
Safety and port taxes ⁽¹⁾	360 €	

DECEMBER 17TH 2016

9 nights on board

SAINT MARTIN • FORT DE FRANCE
LE PONANT



Marie Galante Stateroom	4 490 €	3 140 €
Antigua Stateroom	5 270 €	3 680 €
Marie Galante Premium Stateroom	4 880 €	3 410 €
3 rd adult Passenger in triple Stateroom	2 240 €	1 560 €
Children 8-11 sharing parents ⁽¹⁾	-	-
Single Occupancy Supplement ⁽¹⁾⁽²⁾	From + 30%	
Safety and port taxes ⁽¹⁾	450 €	

JANUARY 31ST 2017

7 nights on board

FORT DE FRANCE • FORT DE FRANCE
LE PONANT



Marie Galante Stateroom	3 880 €	2 710 €
Antigua Stateroom	4 560 €	3 190 €
Marie Galante Premium Stateroom	4 220 €	2 950 €
3 rd adult Passenger in triple Stateroom	1 940 €	1 350 €
Children 8-11 sharing parents ⁽¹⁾	-	-
Single Occupancy Supplement ⁽¹⁾⁽²⁾	From + 30%	
Safety and port taxes ⁽¹⁾	350 €	

DECEMBER 26TH 2016

8 nights on board

FORT DE FRANCE • FORT DE FRANCE
LE PONANT



Marie Galante Stateroom	4 800 €	3 360 €
Antigua Stateroom	5 760 €	4 030 €
Marie Galante Premium Stateroom	5 280 €	3 690 €
3 rd adult Passenger in triple Stateroom	2 410 €	1 680 €
Children 8-11 sharing parents ⁽¹⁾	-	-
Single Occupancy Supplement ⁽¹⁾⁽²⁾	From + 100%	
Safety and port taxes ⁽¹⁾	400 €	

FEBRUARY 07TH 2017

7 nights on board

FORT DE FRANCE • SAINT MARTIN
LE PONANT



Marie Galante Stateroom	3 880 €	2 710 €
Antigua Stateroom	4 560 €	3 190 €
Marie Galante Premium Stateroom	4 220 €	2 950 €
3 rd adult Passenger in triple Stateroom	1 940 €	1 350 €
Children 8-11 sharing parents ⁽¹⁾	-	-
Single Occupancy Supplement ⁽¹⁾⁽²⁾	From + 30%	
Safety and port taxes ⁽¹⁾	350 €	

APRIL 12TH 2017

7 nights on board

COLON • FORT DE FRANCE
LE BORÉAL



Superior Stateroom	2 740 €	1 910 €
Deluxe Stateroom	3 020 €	2 110 €
Prestige Stateroom - Deck 4	3 230 €	2 260 €
Prestige Stateroom - Deck 5	3 390 €	2 370 €
Prestige Stateroom - Deck 6	3 560 €	2 490 €
Deluxe Suite	4 630 €	3 240 €
Prestige Suite - Deck 5	5 080 €	3 550 €
Prestige Suite - Deck 6	5 340 €	3 730 €
Owner Suite	6 940 €	-
3 rd adult Pass. in a Superior Stateroom	1 370 €	950 €
3 rd adult Passenger in a Prestige Suite	2 540 €	1 770 €
4 th adult Passenger in a Prestige Suite	2 540 €	1 770 €
Children 8-11 sharing parents ⁽¹⁾	-	-
Single Occupancy Supplement ⁽¹⁾⁽²⁾	From + 30%	
Safety and port taxes ⁽¹⁾	350 €	

*The detailed itineraries and the conditions of application of the cruise prices shown in this PONANT • LATIN AMERICA & CARIBBEAN - WINTER CRUISES 2016 - 2017 • catalogue are subject to the [General Information](#) and [Terms and Conditions](#) shown in page 58. Also discover our [Insurance](#) offer page 62. **The free single supplement is subject to availability at the time of booking. The cruises are only provided as an example. The cruises for which the offer is valid are subject to change. For more information, please viewed at www.ponant.com

GENERAL IMPORTANT INFORMATION

1.- The rates of our cruises are per person and include the following:

- All meals while on board the ship (from dinner on the day of embarkation to breakfast on the day of disembarkation)
- Captain's welcome cocktail and gala dinner
- "Open Bar" (pouring wines, house champagne, alcohol except premium brands...list available upon request)
- Evening entertainment and events
- Luggage transfer from pier to the ship and vice versa
- Room service 24h (special selection)
- English speaking lecturer on selected sailings identified by "lecturer on board" logo
- Entry fees to protected area
- English speaking dive master on selected sailings identified by "dive on board" logo.
- Water sports activities (except scuba diving) using the ship's equipment, when permitted by local authorities and confirmed by ship Master according to safety and sea conditions onsite.
- A selection of complimentary shore excursions on selected sailings identified by "complimentary excursions" logo.

1.1 "Cruise , Flights & Transfers" program rates are per person and include also the following:

- "Cruise, Flight & Transfer" program for voyage Valparaiso – Ushuaia:
 - Upon disembarkation in Ushuaia, bus transfer to the airport of Ushuaia.
 - Flight Ushuaia – Buenos Aires in Economy-class
- "Cruise, Flight & Transfer" program for voyage Ushuaia-Valparaiso:
 - Flight Buenos-Aires/Ushuaia in Economyclass
 - Meet and Greet by our representatives in Ushuaia and luggage direct transfer from the airport to the ship for port clearance
 - Choice between one full day in Arakur Resort located inside Cerro Alarken natural Reserve, Time at leisure, lunch and / or optional excursion to Tierra del Fuego National Park OR direct transfer to the port for embarkation, buffet lunch and access to the Main Lounge (cabins/suites will not be accessible before 5pm)

2- Cruise rates do not include:

- Airport taxes (subject to modification)
- Any ground services before and/or after the cruise other than the ones mentioned in each "Cruise & Flights" package and for which details are available upon request. Contact your travel agent or consult www.ponant.com
- Optional Spa package to be booked prior your departure; please ask for more information
- Dives when authorized by local authorities and feasible with ship equipment and Zodiac®. Rates: 70 € per standard dive; 80 € per dive when local equipment or staff must be used, 80 € for a "discover scuba dive" course. In order to participate to diving sessions, guests must have with them a medical certificate less than 2 months old and their up to date dive book
- Optional shore excursions when not identified as complimentary shore excursions
- Beverages other than the ones mentioned
- Laundry services, hair salon and à la carte Spa treatments
- Personal expenses, on board medical consultations and drug prescriptions
- Cancellation/luggage/assistance/repatriation/medical insurance(s)
- Visa fees, if applicable
- Port taxes, fuel surcharge and gratuities

3-Ground services

3.1 Services included in "Cruise , flights and Transfers packages:

Packages "Cruise, Flights and Transfers" include ground services before and/or after the cruise as described in documents available 12 months prior departure of each cruise and available on www.ponant.com. Services to the port of departure, transfers to the ship, including, as applicable, hotel room and restaurant bookings or guided tours, are performed by independent suppliers who are not employees of Compagnie du Ponant. In this respect, Compagnie du Ponant acts only as an agent and shall not be held liable for said services or for the acts or omissions of sub-contractors or other contractors. The passenger agrees that Compagnie du Ponant acts as agent and/or trustee for any person including ground and maritime agents and subcontractors, who provide any service forming, or in connection with, any part of the cruise.

Our Cruise and Flights package programs are made in connection with Compagnie du Ponant selected regular or private charter flights. Final timings and schedule of the day by day program will be communicated with the cruise ticket. All our programs are made in economy class and according to number of seats available. If the class is not available anymore, we will suggest, depending on the availability, extra seats with a supplement.

On International flights, check-in luggage is limited to 23kg/50lbs and 8kg/11 to 17lbs per person for carry-on luggage (besides airlines' frequent flyer advantages). On scheduled domestic flights, check-in luggage limits are between 15 and 20 kg/33 to 44lbs and 5 to 8kg/17lbs per person for carry-on. On Compagnie du Ponant Private charter flights, check-in luggage is limited to 20 kg/44lbs and 5kg/11lbs maximum per person as carry-on (pending confirmation of the airline carrier). We thank you for taking these restrictions into account. Airline carriers charge for extra weight and sometimes refuse, for strict security reasons, to check-in overweight and oversized luggage. Compagnie du Ponant and the airline carriers waive all liability for luggage with extra weight that is refused at the check-in.

3.2- Pre and post-cruise programs and pre bookable tours:

Pre and Post-cruise programs (as detailed on www.ponant.com), pre bookable tours and shore excursions are performed by independent suppliers who are not employees of

Compagnie du Ponant. In this respect, Compagnie du Ponant acts only as an agent and shall not be held liable for said services or for the acts or omissions of sub-contractors or other contractors.

The passenger agrees that Compagnie du Ponant acts as agent and/or trustee for any person including ground and maritime agents and subcontractors, who provide any service forming, or in connection with, any part of the cruise.

Hotel accommodations are based on 4 and 5-star rated hotels. Official check-in time is 4pm; check-out time is 11am unless early check-in or late check-out supplement is paid.

3.3 Shore excursions

Otherwise indicated in each detailed cruise package program, shore excursions are sold and charged on board and are ruled by general conditions that apply to the contract signed with the local tour operator and the relevant national regulations. The passenger agrees that CDP acts as agent and/or trustee for any person including ground and maritime agents and subcontractors, who provide any service in connection with any part of the cruise.

Excursions may involve activities that are not being suitable for persons with disabilities. Prices are only given as an indication and may change. Before departure, you will receive a tour program detailing the excursions on offer with the latest rates. Twelve months before cruise departure, shore excursions can also be viewed on www.ponant.com. Shore excursions are currently only bookable on-board. In the event of an excursion being cancelled due to a technical reason, shortage of participants or a case of force majeure, the client will not be eligible for any compensation. Please note that you will not be reimbursed for excursions if you cancel after registration. Any meals offered during excursions are simple and should not be compared to the standards on board the ship.

Complimentary shore excursions (identified by a logo "complimentary excursions") are non-refundable and non-exchangeable with any other optional excursion that could be sold separately during the cruise. We kindly ask you to sign up for the chosen complimentary tour and in case you decide not to participate that you inform the shore excursion staff on board. The shore excursion credit included in your loyalty program will only apply on sailings where shore excursions are not complimentary.

4 - Rates and Savings

Please find the rates for each cruise program on our website www.ponant.com. Ponant Bonus saving is not applicable on taxes. Tax amounts are subject to change and in addition to the package rates (Except for All Inclusive packages presented in US\$)

4.1: Public rates:

They are the reference rates of the cruise applicable for the validity period of the brochure. Public rates are per person and based on double occupancy.

4.2: Ponant Bonus Fares

PONANT BONUS is a special savings program off published cruise-only rates for selected voyages. Ponant Bonus is the guaranteed best price you can obtain on the day you make your reservation. It can save you up to 30% off the public rates. Ponant Bonus fares are capacity controlled, subject to availability and may change at any time without notice. Ponant Bonus could decrease or be closed for specific stateroom and suite categories or entire cruises. Contact your travel agent or refer to www.ponant.com to determine the Ponant Bonus available at the time of booking your cruise (s). Ponant Bonus may not be combinable with other promotional offers or on-board cruise credits.

4.3: "Guaranteed" cabin

Depending on cruise occupancy at time of booking, a "guaranteed" cabin in Deluxe category – deck 3 may be proposed. This means that the booking is made in the Deluxe category – deck 3 without cabin number assignment. Cabin assignment will be made at Compagnie du Ponant's discretion and can change at all times up to embarkation. Once cabin number is assigned no changes are accepted. The advantage of this option is to maybe benefit of a higher cabin category without additional surcharge. In all events, the minimum category chosen at time of reservation is guaranteed.

4.4: Single Supplement

The single supplement applies to any person occupying a single cabin. It is applied on the port / port current Ponant Bonus fare (excluding port taxes). This supplement evolves according to the cruise occupancy. It may therefore change for certain cabin categories and / or suites only, or for the entire cruise at any time and without notice. The single supplement is offered on a selection of cruises for certain categories of cabins. This selection is updated according to the cruise occupancy and is available on our website www.ponant.com.

4-5: Other savings:

Combination of cruises (Discount only applies to port/port cruise fare – does not include port charges, not applicable to Ocean Voyages, and subject to availability at time of booking). Both offers below are not cumulative.

- On all our cruises: 10% off on any combined cruise
- On a particular selection of cruises accessible on our website:
 - 20% off the 2nd cruise
 - 30% off the 3rd cruise
 - 40% off the 4th cruise
- Ponant Yacht Club Grand Admiral Members: -5% off the cruise-only rate, port taxes excluded. This offer will also work for Ocean Voyages.
- Family & Friends: -5% off the cruise-only rate, port taxes excluded, for all bookings of 5 adults or more, booked at the same time and all sailing together on the same cruise
- Honeymoon: see details on www.ponant.com
- Wedding Anniversary (every 5th year): see details on www.ponant.com
- On board Reservations: -5% off the cruise-only rate, port taxes excluded for each new cruise booked with our on-board staff.

These discounts/benefits are not combinable with any offer other than those mentioned above. They are not applicable on Ocean Voyages (programs not qualifying for Ponant Yacht Club Benefits) If you are entitled to several discounts, the value of the second discount is calculated from the revised rate obtained after the deduction of the first discount and so on.

5-Children

Children under 3 years of age and women who are over 6 months pregnant are not authorized to sail. Children between 3 and 8 years old are accepted subject to agreement at the time of booking. If accepted, a liability waiver will have to be completed and returned to Compagnie du Ponant to validate your booking. On expedition cruises, children must be able to disembark/embark by zodiac without assistance and be able to understand and follow safety instructions.

Therefore disembarkation is submitted to Captain's and Expedition Leader's decision depending on weather conditions and landing sites. In all cases, children and young adults, once on board, are the entire and total responsibility of their parents or guardians.

Children from 8 to 11 years old sharing with 2 adults and **Teenagers** from 12 to 17 years old, sharing with 1 or 2 adults benefit from special discounts on cruise-only fares; please contact us for more details.

6-Mobility

L'Austral, Le Boreale and Le Lyrial have three cabins which are specially adapted for disabled guests (ADA Norms). Nevertheless, for safety reasons, all passengers must either be fully mobile or must be accompanied by a travelling companion fit and able to provide all necessary assistance during the voyage. Please note that animals (including service and/or comfort animals) are not permitted aboard. Persons who are not fully mobile, with physical disabilities or other handicaps requiring special treatment or assistance, including persons who use a wheelchair, must advise Compagnie du Ponant in writing of the nature of such conditions when making a reservation request and by all means before the signature of booking form. Compagnie du Ponant reserves the right to refuse passage to anyone who has failed to notify them of such limited mobility, disabilities or need of assistance, whose medical conditions is not compatible with security rules and requirements specific to the navigation area, or who, in the Compagnie du Ponant's opinion is unfit for travel. Please note that landings are done using zodiacs making them very difficult or even impossible for passengers with limited mobility. Each landing will be subject to Captain and Expedition Leader approval.

7- Others

- Women who are more than 6 months pregnant at the time of disembarkation are not permitted to travel
- All our vessels are non-smoking with the exception of designated areas on outside decks.
- Animals (including service and/or comfort animals) are not permitted aboard.
- Any specific health issue, if known, must be reported in writing to our medical department medical@ponant.com.
- Euro, US Dollar currencies and credit cards (VISA, MASTERCARD and AMEX) are accepted on board. Note there are no ATMs onboard the ships or money exchange. Onboard purchases may be charged back to the guest's stateroom.
- Ship master retains the right to change the itineraries as per article 4.2 of the cruise ticket.
- Detailed terms and conditions are available on www.ponant.com and upon request.
- If you require a visa, please ensure that the validity of the visa covers the dates of travel.

COMPAGNIE DU PONANT is a voting Member of International Association of Antarctica Tour Operators (IAATO), organization founded in 1991 to advocate, promote and practice safe and environmentally responsible private-sector travel to the Antarctic.



PONANT is a member of Charte Bleue d'Armateurs de France, and also belongs to the IAATO (International Association of Antarctic Tour Operators) which is committed to responsible behavior to safeguard the flora and fauna.

It is a tradition that our four sister ships, awarded "Clean ship" label will carry forward thanks to:

- Dynamic positioning, hence protecting the seabed,
- Electric propulsion system: quiet and economic,
- Diesel engines using MDO (Marine Diesel Oil): not so heavy and less polluting,
- Reduced exhaust emissions,
- Waste and sewage treatment on board,
- Low energy bulbs for lighting.



TERMS AND CONDITIONS

These are extracts of the terms and conditions which will apply to your cruise. Please read them carefully. Complete terms and conditions are available upon request. Attention is particularly drawn to the exemption and limitation of liability in favor of Compagnie Du Ponant / Compagnie Du Ponant USA LLC, Compagnie du Ponant Pty Limited Australia / Compagnie du Ponant HK Limited / Compagnie du Ponant Shanghai Information Consulting Co., Ltd. hereinafter referred as "the Company" or "CDP". These terms and conditions are subject to change without notice.

1- Transferability:

A reservation for one of the programs listed in this brochure is only valid for date, cruise program and passenger(s) names listed on the written confirmation received upon reservation and on the cruise ticket provided with travel documents. Passenger may transfer the ticket to a third party, who shall fill the same conditions as the passenger to perform all purchased services, as long as the agreement has not rendered any effect. The transferor and/or transferee must settle any fees which result, and inform the Company and the seller of this decision by registered letter with acknowledgement of receipt no later than 90 days prior day of embarkation. In the event where the passenger transfers his/her ticket without informing the Company and the seller as per the terms described above, this ticket transfer will be invalid and the ticket will be cancelled without any possible refund.

2- Payment Schedule:

In order to secure a booking, the guest is required to pay 25% of total cruise price upon confirmation. The final 75% is due no later than 90 days prior to sailing/departure. All reservations are subject to cancellation fees if payments are not received by the due date. Your full payment or acceptance of a ticket constitutes agreement to these Terms and Conditions. General and Important information presented in this brochure as part of the Passenger Ticket Contract. Any revisions to the above payment plan must be in writing and approved by CDP.

3- Revisions & modifications:

Guests who deviate from the scheduled embarkation or disembarkation port should inform the Company in advance to obtain their agreement. Once a booking is secured by a deposit, all revisions and/or changes which occurred less than 90 days before departure are subject to an administration change fee that has to be paid by the passenger as stated hereunder in "Cancellation & Refunds". The passenger who decides to shorten his journey cannot claim any refund for any unused services. The passenger, who fails to present himself in time for his departure or relinquishes booked services included in the program for any reason, cannot claim any refund.

4 - Terms and conditions for, and cost of rebooking and/or cancelling a trip

If the traveler is forced to either rebook or cancel their trip, they will need to inform Compagnie du Ponant via any means that enables them to obtain an acknowledgement of receipt (fax, email, or registered letter with acknowledgement of receipt) as soon as the event resulting in this rebooking or cancellation occurs. The date on which the document was sent will be the date on which the rebooking and/or cancellation fees will be invoiced.

4-1 Term and conditions for rebooking a cruise

Requests to rebook a cruise will only be accepted subject to Compagnie du Ponant being informed within a timeframe of at least 90 days before the departure of the cruise, via the means set out above. This timeframe is increased to 150 days for the Expedition Cruise program. The rebooking terms and conditions exclusively involve the option for the traveler to replace a port-to-port cruise with another port-to-port cruise with Compagnie du Ponant. In the event of a switch to a higher-value travel package, and subject to compliance with the terms and conditions set out in Points 4a to 4d, no alteration fees will be applied to the cruise service, or to the other services, (e.g. air travel). The alteration fees will amount to the expenses already incurred by Compagnie du Ponant:

- 4.a: The passenger may rebook their cruise subject to replacing it with a more expensive cruise than the one that is being replaced;
- 4.b: The departure date of the cruise booked as a replacement must fall within a maximum timeframe of 12 months as from the date when the rebooking request was made
- 4.c: The reservation and payment of the deposit for the replacement cruise must be made at the same time as the rebooking request.
- 4.d: The replacement cruise selected will become non-exchangeable and nonrefundable from that point; the passenger may only cancel it.

4-2 Specific terms and conditions for a rebooking request from Ponant Yacht Club High Admirals

In the event of the 1st rebooking of a tourism package: no fees will be applied to the cruise service, as long as the request is made within a timeframe of at least 90 days before the departure of the cruise. This timeframe is extended to 150 days for the Expedition Cruise programs. Any rebooking request aside from the rebooking of the 1st cruise will be subject to the specific allocation conditions set out in Article 4.1 above. In the case of other services (e.g. air travel), the rebooking fees will amount to the expenses already incurred by Compagnie du Ponant

4.3 : Terms and conditions for rebooking a cruise

No switch may be made to a travel package with a lower value within a timeframe of 90 days (150 days for Expedition Cruises) before the departure of the cruise: cancellation fees will apply, and are set out in Article 4.4 below.

4.4 : Cancellation fees

The cancellation fee schedules below apply to all the services booked with Compagnie du Ponant that are not specified as "non-exchangeable, and nonrefundable". The cancellation fees will amount to 100% of the value of the services in that case.

Expedition Cruise programs:

- From the registration confirmation date up to 91 days before departure: 25% of the amount of the trip;
- Between 90 days and 76 days before departure: 50% of the amount of the trip;
- Between 75 days and 61 days before departure: 75% of the amount of the trip;
- Less than 61 days before departure: 100% of the amount of the trip.

For other cruise programs:

- From the registration confirmation date up to 91 days before departure: 10% of the amount of the trip;
- Between 90 days and 61 days before departure: 25% of the amount of the trip;
- Between 60 days and 46 days before departure: 50% of the amount of the trip;
- Between 45 days and 31 days before departure: 75% of the amount of the trip;
- Less than 30 days before departure: 100% of the amount of the trip.

5- Formalities and health information

Before booking one of these journeys or trips offered in this brochure, each passenger is personally responsible for complying with the required legal regulations. All passengers must carry a valid passport, as well as the visas and vaccination certificates which may be required at the airport, at the port of arrival and departure. Company du Ponant waives all liability for not complying with the required legal regulations regarding immigration, customs or sanitary documents required before departure and during his trip. Please note that Australian, Canadian, and U.S. citizens entering/exiting Argentina must have a valid passport and pay a Reciprocity Tax. Currently, the fee will have to be paid by credit card online before arriving in Argentina: Please consult www.migraciones.gov.ar or www.provinciapagos.com.ar. At time of print, the fees were as follow (subject to change without notice) Australia: USD 100 - (multiple entry valid for one year). Canada: USD 75 - (one entry) or USD 150 - (multiple entry valid for 5 years from first entry). USA: USD 140 - (one entry).

Any guest who fails to obtain the appropriate travel documentation to board the airplane or access to the ship is responsible and may not claim any compensation or refund of his trip or services.

The information given in this brochure is current but subject to change at any time without advance notice from government authorities. Please consult respective government agencies up to the departure date.

6- Air transport and Flight Package information

All airline tickets are provided in the electronic ticket format. It is imperative to ensure that the first names and surnames communicated are those mentioned on the relevant passport, as they cannot be changed later. Any mistakes, or requests to alter the name, will require the purchase of a new ticket. Compagnie du Ponant will provide passengers, at the time they make their booking, with the name of the airline or airline carriers which have either already been selected or are likely to be selected. Compagnie du Ponant undertakes to inform passengers, before departure, of any changes to the identity of the airline or airline carriers as soon as they are known.

The schedules and type of transportation listed are provided by the transportation companies at the time this brochure was being produced. They are a guideline to the moment of departure and are subject to change for all kinds of reasons (additional stops added, weather conditions, air traffic control authorization, strikes...etc.).

In accordance with the Warsaw and Montreal Convention, timings and routes as well as departure/destination airports are not a contractual element of the transportation ticket. Under these conditions, Compagnie du Ponant cannot be held responsible for changes that are beyond its control.

Changes to the original travel program may be the result, in particular, of technical faults, weather conditions, political reasons, delays or cancellations, strikes, additional stops, changes to aircraft or routes, etc. Under no circumstances can these incidences be attributed to Compagnie du Ponant or any compensation made whatsoever. If a client wishes to abandon his journey, he will be liable to the cruise cancellation fees indicated above.

The airline carrier's responsibility, in the event of damages, complaints or claims of any kind, is limited to the carriage of passengers and their luggage by air, within the terms and conditions stipulated on the tickets and by the airline companies themselves. Compagnie du Ponant will not reimburse any expenses (taxis, meals, hotels, etc.), when the passenger is under the responsibility of the airline company. The consequences of accidents/incidents occurring when travelling by air are governed by the Warsaw and Montreal Convention, or by the local regulations governing national transportation in the country concerned.

Our Cruise and Flights package programs are made in connection with Compagnie du Ponant selected regular or private charter flights. Final timings and schedule of the day by day program will be communicated with the cruise ticket. All our programs are made in economy class and according to number of seats available. If the class is not available anymore, we will suggest, depending on the availability, extra seats with a supplement.

On International flights, check-in luggage is limited to 23kg/50lbs and 8kg/11 to 17lbs per person for carry-on luggage (besides airlines' frequent flyer advantages). On regular domestic or intercontinental flights, check-in luggage limits are between 15 and 20 kg/33 to 44lbs and 5 to 8kg/11lbs per person for carry-on. On Compagnie du Ponant Private charter flights, check-in luggage is limited to 23 kg/50lbs and 5kg/11lbs maximum per person as carry-on. We thank you for taking these restrictions into account. Airline carriers charge for extra weight and sometimes refuse, for strict security reasons, to check-in overweight and oversized luggage. Compagnie du Ponant and the airline carriers waive all liability for luggage with extra weight that is refused at the check-in.

7- Boarding and transportation terms and conditions

a) Embarkation: Guests must report for boarding in the conditions set by the cruise ticket (details of cruise ticket document are available upon request). Passengers are responsible for having received all medical inoculations necessary for the voyage and having their cruise ticket, a valid passport, visas and other documents mandatory for the scheduled ports of call and disembarkation. If a passenger does not have proper documents he/she will not be allowed to embark. Boarding the ship automatically makes the passenger subject to the application of the provisions hereafter, as well as the general conditions concerning the travel program, which they are familiar with and which they have accepted.

b) Visas, Passport and Health information: At the time of boarding, all guests must have a passport valid for six months following disembarkation as well as necessary visas and vaccination certificates which may be required in destination ports where the ship calls. CDP accepts no responsibility for obtaining required visas or for advising guests of visa or other immigration requirements. Please consult relevant authorities or a visa service to determine accurately if any visas, health certificates, or vaccinations are required. If incorrect documents are obtained, guests will be unable to participate in particular shore excursions and may be denied boarding and/or disembark in certain port of calls/countries. The Company and/or master of the ship are entitled to refuse embarkation or to prevent disembarkation of any passengers who do not show the documents allowing them to disembark at the scheduled destination or stopover ports. Every passenger is personally responsible for compliance with the statutory and regulatory provisions in force before departure.

Note: Due to airline security measures, your passport name must match your airline ticket name or you may be denied boarding.

c) Health and Security: If it appears to the Company and/or the Master of the ship that a passenger is for any reason whatsoever unfit to travel or likely to endanger his health or safety or impair the comfort of others on board or seems likely to be refused permission to land at any port or to render the Company liable for his maintenance, support or repatriation, the Company or the Master of the ship shall be entitled at any time to take any of the following courses as appear appropriate to them, namely a) To refuse to embark or disembark the passenger at any particular port; b) To disembark him

at any port; c) To transfer him from one berth to another; d) To confine him to one cabin of the ship's medical center; e) Through the ship's doctor and/or his staff to administer any drug, medication or other substance or to admit and/or confine the passenger to the hospital, or any similar institution at any port provided that the ship's doctor considers it necessary.

Health care, medical expenses and drugs on land or aboard the ship shall be paid by passengers. In Antarctica, please remember that there is no medical structure available before several days at sea. A mandatory medical questionnaire is provided and has to be properly filled by you and your personal physician between 90 and 75 days prior departure and returned to our dedicated Medical Department no later than 60 days prior departure. Any guest not having provided this mandatory document completed will not be authorized to embark without possible recourse. Please note that given the inaccessibility of Antarctica, we recommend you choose your travel insurance company very carefully as in case of evacuation; all kind of expenses will have to be paid up front.

L'Austral, LE BOREAL, LE SOLEAL and LE LYRIAL have three cabins which are specially adapted for disabled guests (ADA Norms). Nevertheless, for safety reasons, all passengers must either be fully mobile or must be accompanied by a travelling companion fit and able to provide all necessary assistance during the voyage. Please note that animals (including service and/or comfort animals) are not permitted aboard. Persons who are not fully mobile, with physical disabilities or other handicaps requiring special treatment or assistance, including persons who use a wheelchair, must advise Compagnie du Ponant in writing of the nature of such conditions when making a reservation request and by all means before the signature of booking form. Compagnie du Ponant reserves the right to refuse passage to anyone who has failed to notify them of such limited mobility, disabilities or need of assistance, whose medical conditions is not compatible with security rules and requirements specific to the navigation area, or who, in the Compagnie du Ponant's opinion is unfit for travel. Please note that landings are done using zodiacs making them very difficult or even impossible for passengers with limited mobility. Each landing will be subject to Captain and Expedition Leader approval.

Passengers accept civil and criminal liability for all damages caused to Compagnie du Ponant, other passengers or third parties by their actions. Passengers are individually and solely responsible for the payment of any and all fines or penalties inflicted by competent authorities on account of their own acts.

d) Itinerary changes/alterations/cancellation of a trip: Arrival and departure times are given as an indication only. The Company cannot guarantee coincidence with corresponding schedules (plane, train...) notably due to modification of the program duration initially planned, which cannot incur any compensation, as the Company cannot be held liable for indirect damages. CDP reserves the right to withdraw and/or cancel a sailing to make changes in the itinerary whenever, in its sole judgment, or in the judgment of the vessel owner or operator, conditions warrant it.

In the event of adverse meteorological conditions or adverse political or social conditions in the country of a port of call or for any other fact that may jeopardize the safety of guests or of the ship, or in the event of orders by public authorities, the Company may change the itinerary or ports of call or destination, delay, end or cancel the trip, divert the ship, tow or be towed, transfer guests and their luggage aboard any other means of transportation, even when this results in an increase or a shortening of the advertised program. The Company does not warrant that these will correspond to the time schedule of connecting flights or transfers (e.g. planes or trains...), due to the fact that the initially scheduled trip duration may be altered. No indemnification shall be due on this account, as the Company is not liable for indirect damages.

Under any circumstances, the ship may provide assistance to any person or goods at sea, and will not be liable for the consequences of a modification to the cruise program for this reason.

In the case of external events beyond the control of the Company or for any reason regarding the safety of travelers or the ship or due to charter of the ship or due to an insufficient number of participants, according to that which is provided for by the terms and conditions of the trip program, the Company may cancel the cruise and must inform the passengers by registered letter with acknowledgement of receipt or email, fax with proof of delivery.

Cruise & Flight and Transfer Programs indicated in this brochure are subject to a minimum of participants. Compagnie du Ponant may cancel any cruise program up to 21 days before departure if the minimum of guests registered is under or equal to 50% of the ship capacity (200 guests).

In the event of an alteration of the contract by the Company after boarding the ship, passengers shall in any case not be entitled to any indemnification other than refund for unperformed services for which no replacement was provided. In addition, passengers may be requested to pay extra monies for services rendered under such circumstances and for the costs of living aboard the ship in the event that the duration of the trip is extended.

Compagnie du Ponant may give passengers cabins other than those initially planned.

e) Luggage: Each guest can bring aboard a reasonable amount of clothing and personal effects without charge, subject to airline restrictions. Hand luggage or cabin luggage and personal effects shall comply with allowances in the terms and conditions provided for in the program. Luggage must be distinctly labeled with the passenger's full name, the name of the ship and cabin number.

All passengers are prohibited from transporting merchandise in their luggage whose content may threaten the health of other passengers, damage or contaminate their luggage on the vessel. It is notably forbidden to board or pack animals or inflammable, explosive, corrosive, dangerous, scented or leaking materials in your luggage. Failure to comply with these rules will lead to payment of a lump sum penalty provided for by law.

The passenger will in any case be responsible for any injury, loss or damages suffered due to the presence of these objects, and shall ensure that the Company is not sued due to such events. Such objects may at any time and in any place be disembarked, destroyed, thrown into the sea or made safe by the Company without any compensation. It is also prohibited to load objects as luggage other than those intended for personal use by the passenger, and notably goods in general, and objects whose importing is prohibited or which are not compliant with customs or police regulations. The passenger is responsible for all consequences, expenses, damages and penalties resulting therefrom, and the Company, in such cases, shall not be held liable for loss or damages.

Passengers must look after their personal luggage during the entire duration of the stay aboard the ship as well as during embarking, transfer and disembarking operations. Compagnie du Ponant waives all liability for luggage left unattended by passengers and for which passengers have not taken the necessary precautions against theft, loss or damage. Specifically, the Company shall not be liable for breakable items and valuables including but not limited to money, watches, securities, jewelry, computers and any electronic materials, mobile phones and other precious objects which must be hand-carried by the passenger on and off the ship; are the full responsibility of the passenger at all time. CDP is not responsible for loss of or damage to such items. Passenger is responsible for subscribing to insurance to cover luggage.

8- Independent contractors/Limit of liability

The passenger agrees that Compagnie du Ponant acts as agent and/or trustee for any person, ground and maritime agents and subcontractors, who provide any service forming, or in connection with, any part of the cruise. Transportation services to the port of departure, transfers to the ship, including, as applicable, hotel room and restaurant bookings or guided tours, are performed by independent suppliers who are not employees of Compagnie du Ponant. In this respect, Compagnie du Ponant acts only as an agent and shall not be held liable for said services or for the acts or omissions of sub-contractors or other contractors.

Compagnie du Ponant shall not be held liable for bodily injury to, or death of passengers, or for loss of, or damage to luggage or other personal belongings, unless it is proved that the carrier has infringed statutory obligations or that it or one of its employees or agents has committed gross negligence. However, in the event the liability of Compagnie du Ponant is incurred, such liability is limited (details available upon request).

Compagnie du Ponant shall in any case not be liable for failure of an improper performance when the same is due to or caused by the fault of the passenger; the unforeseeable or unavoidable fault or a third party unconnected with the provision of any services to be provided under the contract; unusual and unforeseeable circumstances beyond the control of Compagnie du Ponant; an event of "Force Majeure" such as a war, threat of war, riots, civil commotion, acts of God, terrorist activities, natural and nuclear disaster, fire, technical problems with transport, closure of ports, strikes and any industrial action, or any other event beyond the control of Compagnie du Ponant.

During expedition programs, all persons who participate in any expedition activity accept responsibility for making their own determinations as to the suitability of the activity and for their own safety, conduct and well-being and agree to participate solely at their own risk. Attending information briefings is mandatory. Thus informed, each participant assumes the risk associated with these activities and will hold Compagnie du Ponant, its officers, directors, crew and expedition team members as well as hiking leaders harmless from and defend them against any and all liability, actions, suits, claims and demands which could arise from any of the Compagnie du Ponant's activities and from any loss or injury which may sustain as a result of participation in any of these activities.

Compagnie du Ponant and the Owners and operators of the vessels identified in this brochure shall be entitled to claim the benefit of whichever law, regulation, treaty or doctrine provides the greatest protection.

9- Validity of the brochure

From May 12th, 2015 and until further notice, this brochure cancels and replaces all information contained in all brochures COMPAGNIE DU PONANT or any other leaflet.

10- Rates

The prices given at the time of booking are based on economic conditions known on May 12th 2015 for the period from May 15th 2015 (TBC) and until further notice. These conditions are, amongst others, the cost of transport and fuel, relevant dues and taxes for the proposed operation (port taxes, embarkation and disembarkation taxes, entrance costs to tourist sites), currency exchange rates relevant to the pricing of these programs. Compagnie du Ponant reserves the right within the legal limits of French Law to vary the prices if necessary.

All variation of the cost of transport, fuel, taxes, dues and visa costs will be passed on within the voyage cost. Additionally, any surcharge levied will be increased to include an amount to cover agent's commission. Any change in fare cannot be imposed less than 60 days prior to departure. For the cruise-only rate, daily surcharge, if any, will be calculated based on:

$$S = \frac{\text{fuel variation} * \text{x daily consumption} **}{\text{Ship capacity} ***}$$

(*): MGO FOB Rotterdam 0,1% in US\$

(**): 20t

(***): 200

11- Travel Insurance

Passengers shall be responsible for subscribing to cancellation/luggage/assistance/repatriation/medical insurance(s).

12- Claims

No claims can be made against CDP without a written and detailed statement of the claim by registered letter with acknowledgment of receipt requested within the following time periods : a) For luggage : in the event of obvious damages or loss : at the time of disembarkation at the latest. In the event of hidden damages or loss: within seven (7) days of disembarking or of the date when disembarkation should have taken place ; b) For passengers in the case of bodily harm and damages other than to luggage : within thirty (30) days from the date when the passenger disembarked or should have disembarked. Failure to comply with these provisions shall mean that the passenger is deemed to have safely disembarked without harm and collected his or her luggage without damage thereto.

13- Jurisdiction

These terms & conditions are subject to and interpreted according to International regulations and concern the transportation of passengers and their luggage from the time of boarding the ship to the moment of disembarking, as well as at ports of departure, destination, or stopover. CDP shall incur no liability outside this period of time. Without prejudice to required legal regulations, any actions related either to the interpretation, or execution of this agreement shall be brought before the competent courts of Marseille-France.

CDP is not responsible for omissions, printing and/or presentation errors and reserves the right to make corrections as required.

INSURANCE



PONANT is creating a new insurance and multi-risk assistance contract. Enjoy worry-free travel with our exclusive **Ponant 5* Insurance** policy, arranged through our partner, APRIL, a specialist in high-end travel insurance. This insurance will cover you on all our itineraries without exception, and for the full duration of your cruise. APRIL has been our partner for nearly 15 years and has plenty of experience in the type of problems that may arise. We are therefore offering to be the single and unique point of contact for booking your flights and cruises and also for managing insurance cover throughout your trip. The guarantees provided are subject to a surcharge of **5% incl. taxes on the total cost of your travel if your cruise is ranges from 0 € to 25 000 € / person or 7% incl. taxes on the total cost of your travel if your cruise is ranges from 25 001€ to 50 000 € / person**. The policy must be taken out on the day your cruise is purchased. Our sales staff are at your disposal to answer all your questions. To be eligible you must live in mainland France including Corsica, the French overseas departments, Andorra and Monaco, or in an EU country or in Switzerland.

BENEFITS	Maximum amounts / person, incl. tax
TRIP CANCELLATION	
<ul style="list-style-type: none"> Illness (including relapse from previous illness or injury), accident, death of the insured, of a family member or an insured accompanying party: deductible 5% of the cancellation cost with a minimum of 75 € / person. Attack or natural disaster occurring at destination point Other justified reasons ↳ Deductible 	50 000 € maximum / person 100 000 € maximum / event (75 000 € / event if the amount of the trip is less than 25 000 € / person) 10% of the cancellation cost with a minimum of 75 € / person
MISSED CONNECTION	
<ul style="list-style-type: none"> Travel expenses up to the next stop-over OR Early return 	50% of the trip cost with a maximum of 1 500 € / person Return ticket + taxi fare
BAGGAGE	
<ul style="list-style-type: none"> Theft, total or partial destruction, loss during conveyance by a shipping company ↳ Deductible Late delivery > 24h 	3 049 € incl. tax / person 30 € / file Fixed sum of 400 € incl. tax / person
ASSISTANCE TO PERSONS IN CASE OF ILLNESS OR INJURY DURING TRAVEL	
<ul style="list-style-type: none"> Transportation / Repatriation Return travel of family members or insured accompanying party OR Presence during hospitalization <ul style="list-style-type: none"> - Transportation - Accommodations Prolonged stay of accompanying party in the event of hospitalization Accompanying children under 18 years old Travel continuation Reimbursement of medical expenses abroad and advance of hospitalization costs abroad <ul style="list-style-type: none"> - Europe and Mediterranean countries - Rest of the world ↳ Deductible for medical expenses 	Actual costs Return ticket + taxi fare Round trip ticket + taxi fare 80 € / night (maximum 10 nights) 80 € / night (maximum 4 nights) Hostess or round trip ticket Additional travel expenses 75 000 € / person 152 500 € / person 30 € / person / event
ASSISTANCE PROVIDED IN CASE OF DEATH	
<ul style="list-style-type: none"> Return travel of family members or one or two of the insured accompanying party Anticipated return in the event of death of a family member, the person in charge of child care or the professional replacement 	Return ticket + taxi fare Return ticket + taxi fare
TRAVEL ASSISTANCE	
<ul style="list-style-type: none"> Advance of bail abroad Coverage of lawyers' fees abroad Early return in case of damages at home Assistance in case of damages at home <ul style="list-style-type: none"> - Conservatory measures - Accommodations Assistance and advance of funds in case of theft, loss OR destruction of identification papers or payment means 	15 300 € / person 3 100 € / person Return ticket + taxi fare 80 € 50 € / night (maximum 2 nights) 2 300 € / person
CIVIL LIABILITY	
<ul style="list-style-type: none"> All bodily injury and property damage Including property damage ↳ Deductible 	500 000 € incl. tax / person 75 000 € incl. tax / person 75 € / claim
TRIP INTERRUPTION	
<ul style="list-style-type: none"> Cost of trip interruption, due to: <ul style="list-style-type: none"> - Hospitalization or death of close relations - Damages at home Compensation travel, following: <ul style="list-style-type: none"> - Medical repatriation of the insured 	Prorata temporis (excluding transportation) Initial cost of insured trip
TRAVEL ACCIDENT	
<ul style="list-style-type: none"> Death Disability 	15 245 € incl. tax / person 15 245 € incl. tax / person 150 000 € incl. tax / event

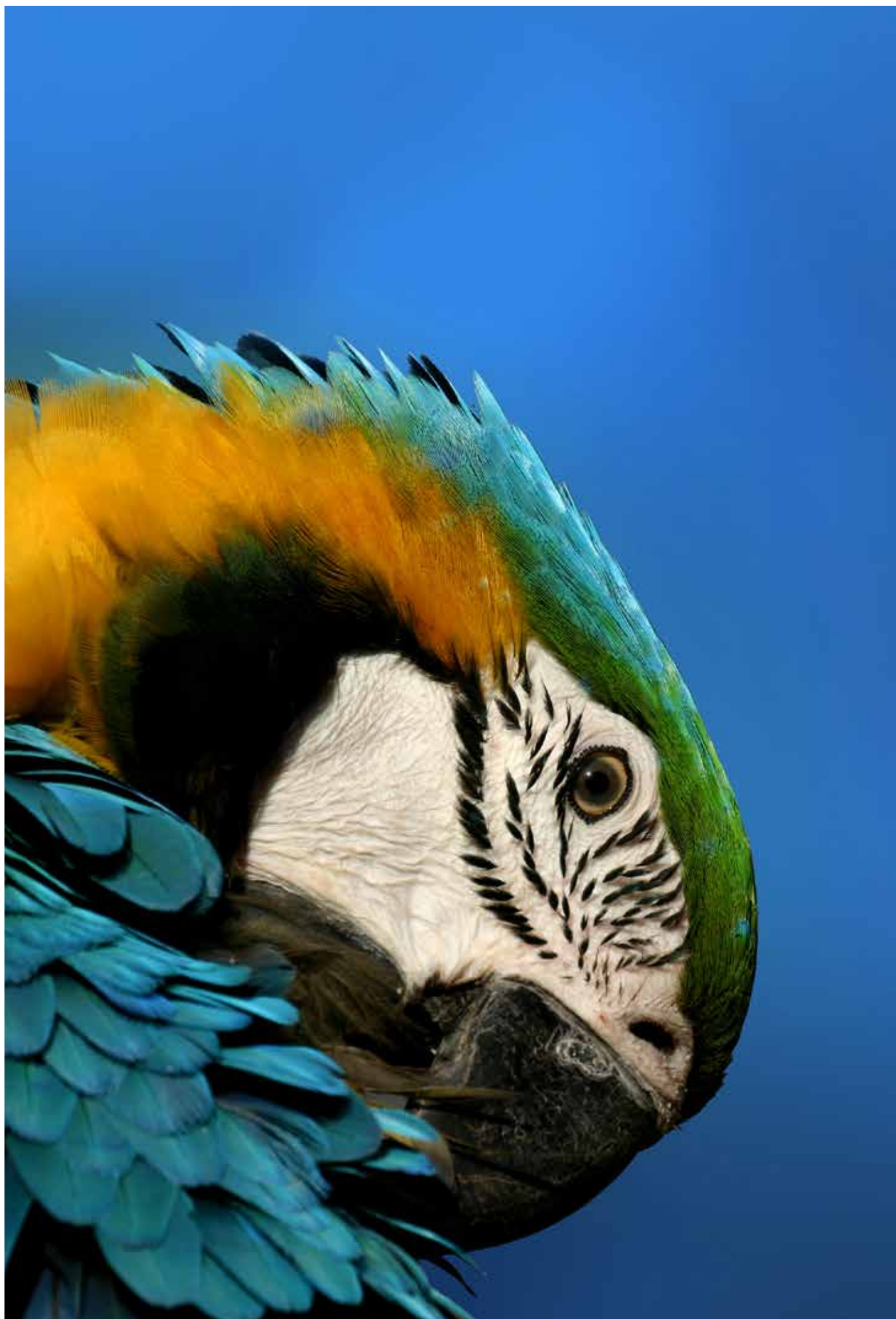

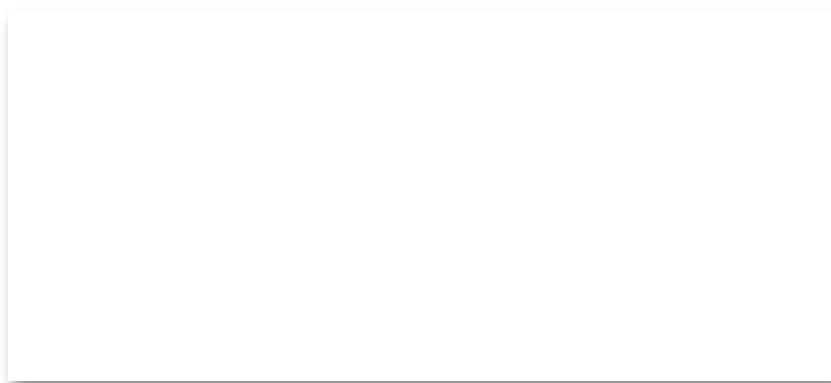

408 Avenue du Prado - 13008 Marseille - France

www.ponant.com

Licence 013060005 - Member of SNAV, ATOU FRANCE and APST